



American Heart Association®

Quality of Care &
Outcomes Research

Quality of Care and Outcomes Research in Cardiovascular Disease and Stroke

2019 Scientific Sessions

Final Program

April 5-6, 2019 | The Ritz-Carlton Pentagon City | Arlington, Virginia

Sponsored by the American Heart Association's Council on Quality of Care and Outcomes Research

professional.heart.org/qcorsessions

Program at a Glance

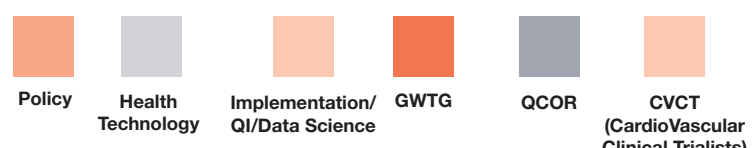
Friday, April 5			Saturday, April 6		
	7:00-8:15 AM <i>Diplomat Room</i> Quality of Care Workshop I Advancing Clinical Quality Through IT Collaboration		7:00-8:15 AM <i>Plaza Room</i> “Guide Lines” vs the Bottom Line: Using Registry Process Measures to Influence Improvement in Outcomes & Financial Performance		7:00-10:15 AM <i>Diplomat Room</i> Design Thinking in Action Workshop
8:30-9:00 AM <i>Grand Ballroom</i> Opening Session					
9:00-10:15 AM <i>Grand Ballroom</i> Plenary Session I			9:00 AM-Noon <i>Grand Ballroom</i> Poster Session AM	9:00-10:15 AM <i>Plaza Room</i> Abstract Oral Session: Data Science	
10:15-10:45 AM Break					
10:45 AM-12:15 PM <i>Grand Ballroom</i> QCOR Early Career Investigator Award Finalists	10:45 AM-Noon <i>Plaza Room</i> Policy to Payment Practice	10:45 AM-12:30 PM <i>Diplomat Room</i> Quality of Care Workshop II QCOR Shared Decision Making		10:45 AM-Noon <i>Plaza Room</i> QCOR 2019 Early Career Investigator Award Semi-Finalists	10:45 AM-Noon <i>Diplomat Room</i> AHA/CVCT Forum Joint Session: Real World Data for Evidence Generation in a Trial Dominated Cardiovascular Space Part II
12:30-2:00 PM <i>Plaza D</i> Career Development Lunch: Building Bulletproof Collaborations			12:30-2:00 PM <i>Plaza D</i> Early Career Panel Discussion: Tell it to Me Straight: The Truth About Early Career		
2:00-3:15 PM <i>Grand Ballroom</i> Plenary Session II AHA/CVCT Forum Joint Session: Real World Data for Evidence Generation in a Trial Dominated Cardiovascular Space Part I			2:00-5:00 PM <i>Grand Ballroom</i> Poster Session PM	2:00-3:15 PM <i>Plaza Room</i> Abstract Oral Session Quality Improvement Initiatives	2:00-3:15 PM <i>Diplomat Room</i> Transforming Cardiovascular Care Using Digital Health Technology: Where Are We Now and Where are We Going?
3:15-3:45 PM Break					
3:45-5:00 PM <i>Grand Ballroom</i> Real-Life Perspectives in Healthcare Quality: From Skills to Projects to Careers	3:45-5:00 PM <i>Plaza Room</i> CIRC: CQO Workshop	3:45-5:00 PM <i>Diplomat Room</i> GWTG: Cardiovascular Systems of Care – The Past, Present and Future		3:45-5:00 PM <i>Plaza Room</i> Abstract Oral Session Health IT	3:45-5:00 PM <i>Diplomat Room</i> GWTG: Improving Heart Failure Care in a Public Hospital
			Conference Adjourns		
6:00-7:00 PM <i>Salon I & II</i> Poster Session and Reception			Tracks 		
7:00-9:30 PM <i>Salon III</i> Council Dinner					

Contents

Abstract Information	9
Author Index.....	41
Conference Awards	10
Conference Highlights	9
General Information	7
Hotel Map	5
Policy Information	11
Poster Sessions.....	18
Program Agenda	12
Friday, April 5.....	12
Saturday, April 6	14
Program Committee	2
Room Locator	6

Questions and Information

If you have questions about this program, contact the American Heart Association National Center, Dallas, Texas:

Telephone 888-242-2453 (inside the United States)
 214-570-5935 (outside the United States)

Fax 214-373-3406

Email scientificconferences@heart.org

Website professional.heart.org

Professional Membership Customer Service

Lippincott Williams & Wilkins

Telephone 800-787-8984 (inside the United States)
 301-223-2307 (outside the United States)

Fax 301-223-2327

Email ahaonline@lww.com

The American Heart Association is a national voluntary health organization with the mission to be a relentless force for a world of longer, healthier lives.

The American Heart Association gratefully acknowledges the following companies for their generous support of the Quality of Care and Outcomes Research in Cardiovascular Disease and Stroke 2019 Scientific Sessions:



The American Heart Association is grateful to the members of the Program Committee for their dedication and leadership in planning the program.

QCOR 2019 Program Committee

Adrian F. Hernandez, MD, MHS, FAHA, Conference Chair, Duke University Medical Center, Durham, North Carolina

Michael Ho, MD, Conference Vice-Chair, Denver VA Medical Center, Denver, Colorado

Suzanne Arnold, MD, MHA, Saint Luke's Mid America Heart Institute/University of Missouri-Kansas City, Kansas City, Missouri

William B. Borden, MD, FAHA, George Washington University, Washington, D.C.

Sandeep Das, MD, MPH, UT Southwestern, Dallas, Texas

Nihar Desai, MD, MPH, Yale Internal Medicine-Cardiology, New Haven, Connecticut

Kumar Dharmarajan, MD, MBA, Yale School of Medicine, New Haven, Connecticut

Shannon Dunlay, MD, MS, Mayo Clinic, Rochester, Minnesota

T. Bruce Ferguson, Jr., MD, East Carolina University, Greenville, North Carolina

Ty Gluckman, MD, Providence Heart and Vascular Institute, Portland, Oregon

Paul Heidenreich, MD, Stanford University, Stanford, California

Patricia Kearney, MD, PhD, Cork, Ireland

Umesh Khot, MD, Vice Chairman, Cleveland Clinic, Cleveland, Ohio

Colleen K. McIlvennan, DNP, MS, BSN, University of Colorado, Aurora, Colorado

Emily O'Brien, PhD, Duke Clinical Research Institute, Durham, North Carolina

Pamela Peterson, MD, MSPH, Denver Health Medical Center, Denver, Colorado

Kim Smolderen, PhD, Saint Luke's Mid America Heart Institute, Kansas City, Missouri

Deborah (Debbie) Summers, MSN, RN, ACNS-BC, CNRN, SCRNP, Saint Luke's Hospital of Kansas City, Kansas City, Missouri

William Weintraub, MD, MedStar Health Research Institute, Washington, D.C.

Faculty

Amy Abernethy, MD, PhD, Food and Drug Administration, Silver Spring, Maryland
Faraz Ahmad, MD, MS, Northwestern University, Chicago, Illinois
Tariq Ahmad, MD, MPH, Yale University, New Haven, Connecticut
Nancy M. Albert, PhD, CCNS, CHF, CCRN, NE-BC, FAHA, FCCM, FHFSA, FAAN, Cleveland Clinic, Cleveland, Ohio
Jake Aleckson, Nordic, Madison, Wisconsin
Larry Allen, MD, University of Colorado, Aurora, Colorado
Ivor Benjamin, MD, FAHA, FACC, Medical College of Wisconsin, Milwaukee, Wisconsin
William Borden, MD, FACC, FAHA, George Washington University, Washington, DC
Cherie Boxerberger, MS MBA CPHQ, American Heart Association, Dallas, Texas
Steven Bradley, MD, Minneapolis Heart Institute, Minneapolis, Minnesota
Marc Boutin, JD, National Health Council, Washington, DC
Ivy Chen, Google, Mountain View, California
Sandeep Das, MD, MPH, UT Southwestern, Dallas, Texas
Steve Dentel, BSN, RN, CPHQ, American Heart Association, Dallas, Texas
Shannon Dunlay, MD, MS, Mayo Clinic, Rochester, Minnesota
Joseph E. Ebinger, MD, Cedars-Sinai, Los Angeles, California
Rachael Fleurence, PhD, NESTcc, Washington, DC
Gregg C. Fonarow, MD, UCLA, Los Angeles, California
Ty Gluckman, MD, Providence Heart Institute, Portland, Oregon
Robert Harrington, MD, Stanford University, Stanford, California
Lalymar Havern, MS, PharmD, BCACP, Deerfield, Illinois
Mark Herbst, Google, Zurich, Switzerland
Adrian Hernandez, MD, Duke Clinical Research Institute, Durham, North Carolina
Leanna Hester, Nordic, Madison, Wisconsin
Michael Ho, MD, University of Colorado Health Science Center, Denver, Colorado
Cynthia Jackevicius, BScPhm, PharmD, MSc, FCSHP, BCPS, Western University, Los Angeles, California
Alice Jacobs, MD, Boston University School of Medicine, Boston, Massachusetts
Umesh Khot, MD, Cleveland Clinic, Cleveland, Ohio
Nasser M. Lakkis, MSc, MD, Baylor College of Medicine, Houston, Texas
Donald Likosky, MS, PhD, University of Michigan, Ann Arbor, Michigan
Roger London, MD, CHSLI, Tarrytown, New York
Karen Joynt Maddox, MD, Washington University School of Medicine, St. Louis, Missouri
Maulik Majmudar, MD, Amazon, Boston, MA
Janet Marchibroda, Bipartisan Policy Center, Washington, DC
David Martin, MD, MPH, Food and Drug Administration, Silver Spring, Maryland
Daniel Matlock, MD, MPH, University of Colorado, Denver, Colorado
Michelle McMurry-Heath, MD, PhD, Johnson & Johnson, Washington, DC
Colleen McIlvennan, DNP, MS, BSN, University of Colorado, Denver, Colorado
Paul Muntner, PhD, University of Alabama-Birmingham, Birmingham, Alabama
Brahmajee Nallamothu, MD, MPH, Ann Arbor Veterans Affairs Medical Center, Ann Arbor, Michigan
Emily O'Brien, PhD, Duke University, Durham, North Carolina
Kapil Parakh, MD, MPH, PhD, Google Fit, Baltimore, Maryland
Mitesh S. Patel, MD, MBA, MS, University of Pennsylvania, Philadelphia, Pennsylvania
Ted Pollari, Humana, Arlington Heights, Illinois
Scott Rosignol, Nordic, Madison, Wisconsin
Elana Safran, MPA, Office of Evaluation Sciences, U.S. General Services Administration, Washington, DC
Bimal Shah, MD, Duke University, Durham, North Carolina
Rashmee Shah, MD, University of Utah, Salt Lake City, Utah
Christina Silcox, PhD, Duke-Margolis Center for Health Policy, Washington, DC
Lisa Simpson, MB, BCh, MPH, FAAP, Academy Health, Washington, DC
Kim Smolderen, PhD, Saint Luke's Mid America Heart Institute, Kansas City, Missouri
Erica Spatz, MD, MHS, Yale University, New Haven, Connecticut
John Spertus, MD, MPH, FACC, Saint Luke's Mid America Heart Institute, Kansas City, Missouri
Madeline Sterling, MD, Weill Cornell Medicine, New York, New York
Jeremy Sussman, MD, MS, University of Michigan, Ann Arbor, Michigan
Michael Thompson, PhD, MPH, University of Michigan, Ann Arbor, Michigan
Lakshmi Tummala, MD, Veterans Affairs, Washington, DC
Mintu (Minang) Turakhia, MD, Stanford University, Stanford, California
Sara Urbinc, Google UK, London, United Kingdom
Charlene Wong, MD, MSPH, Duke-Margolis Center for Health Policy, Washington, DC
Tracy Wang, MD, Duke Clinical Research Institute, Durham, North Carolina
Richard J. Willke, PhD, ISPOR, Washington, DC
Boback Ziaeeian, MD, PhD, UCLA, Los Angeles, California

Abstract Reviewers

The conference organizers gratefully acknowledge the following individuals for their assistance with the abstract grading process:

Larry Allen, MD, University of Colorado School of Medicine, Aurora, Colorado
Suzanne Arnold, MD, MHA, Saint Luke's Mid America Heart Institute, Kansas City, Missouri
Geoffrey Barnes, MD, University of Michigan, Ann Arbor, Michigan
William B. Borden, MD, George Washington University, Washington, District of Columbia
Ralph Brindis, MD, University of California-San Francisco, San Francisco, California
John Brush, MD, Cardiology, Norfolk, Virginia
Alanna Chamberlain, PhD, Mayo Clinic, Rochester, Minnesota
Paul Chan, MD, Saint Luke's, Kansas City, Missouri
Adnan Chhatiwalla, MD, Saint Luke's, Kansas City, Missouri
David Cohen, MD, Saint Luke's, Kansas City, Missouri
Carole Decker, RN, PhD, Saint Luke's Mid America Heart Institute, Kansas City, Missouri
Shannon Dunlay, MD, Mayo Clinic Rochester, Rochester, Minnesota
Ty Gluckman, MD, Providence Heart Institute, Portland, Oregon
Zach Goldberger, MD, University of Washington, Seattle, Washington
Paul Heidenreich, MD, Stanford University, Palo Alto, California
Adrian Hernandez, MD, MHS, Duke Clinical Research Institute, Durham, North Carolina
Michael Ho, MD, PhD, Colorado Health Outcomes, Denver, Colorado
Cynthia Jackevicius, PharmD, MSc, Western University of Health Sciences and University of Toronto, Pomona, California
Karen Joynt Maddox, MD, Washington University, St. Louis, Missouri
Umesh Khot, MD, Cleveland Clinic, Cleveland, Ohio
David Lanfear, MD, Henry Ford Health System, Detroit, Michigan
Donald Likosky, MD, University of Michigan, Ann Arbor, Michigan
Thomas Maddox, MD, Washington University, St. Louis, Missouri
David Malenka, MD, Dartmouth Hitchcock Medical Center, Lebanon, New Hampshire
Frederick Masoudi, MD, MSPH, FAHA, University of Colorado Denver, Aurora, Colorado
Colleen K. McIlvennan, DNP, MS, BSN, University of Colorado, Aurora, Colorado
Colleen Norris, PhD, MSc, BScN, RN, University of Alberta, Edmonton, Alberta, Canada
Eric Peterson, MD, Duke Clinical Research Institute, Durham, North Carolina
Rita F. Redberg, MD, University of California-San Francisco, San Francisco, California
Mathew J. Reeves, BVSc, MS, PhD, Michigan State University, East Lansing, Michigan
Kristi Reynolds, PhD, MPH, Kaiser Permanente, Pasadena, California
John Rumsfeld, MD, PhD, University of Colorado, Denver, Colorado
Kim Smolderen, PhD, Saint Luke's Mid America Heart Institute, Kansas City, Missouri
Mintu Turakhia, MD, Stanford University, Palo Alto, California
Javier Valle, MD, University of Colorado, Denver, Colorado
Salim Virani, MD, PhD, Michael E. DeBakey Veterans Affairs Hospital and Baylor College of Medicine, Houston, Texas
Tracy Wang, MD, MHSc, Duke University, Durham, North Carolina
Gina S. Wei, MD, MPH, NHLBI, Bethesda, Maryland
Ying Xian, MD, PhD, Duke University, Durham, North Carolina

Hotel Map

CONFERENCE LEVEL

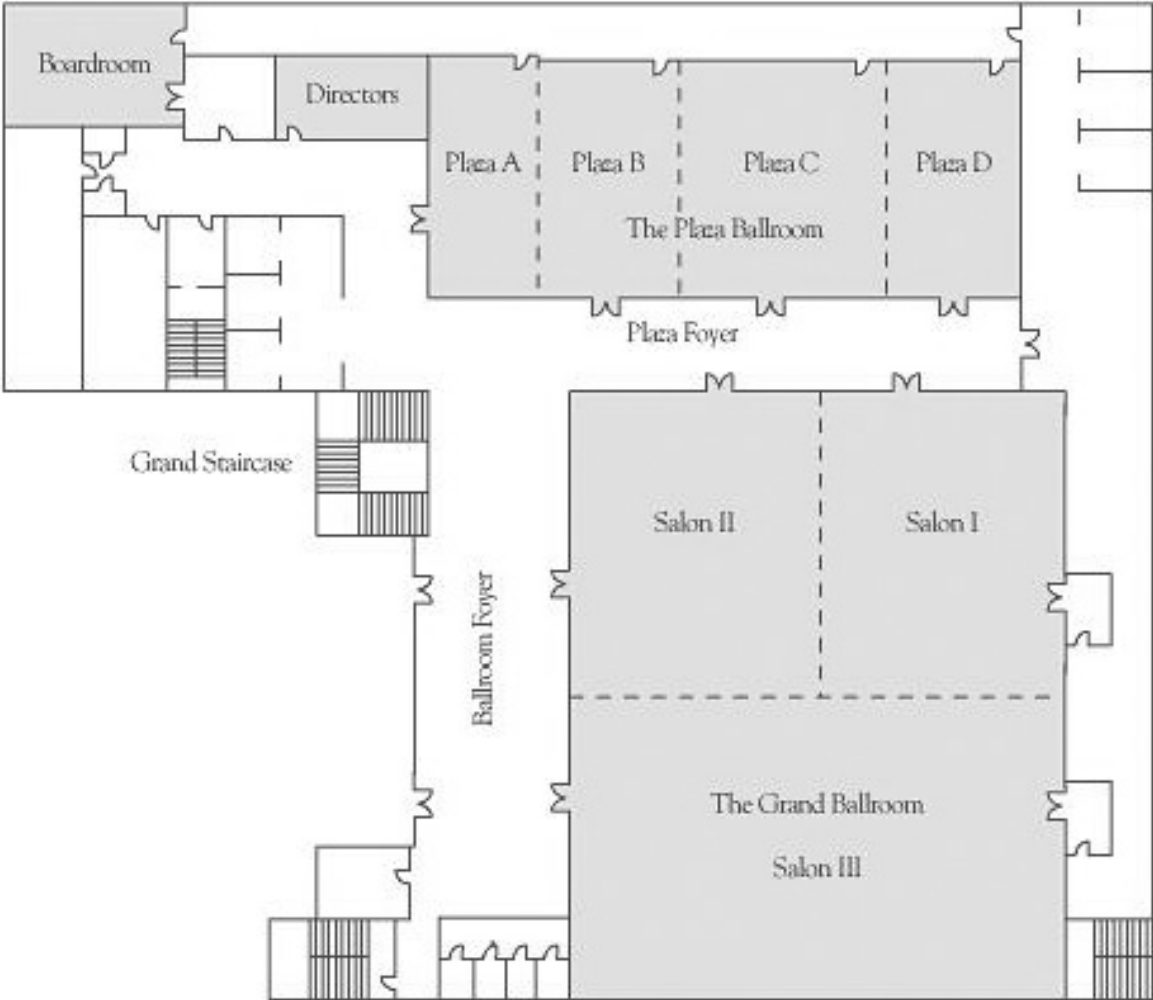

Room Locator

All Conference	
Meeting Name	Hotel Location
Conference Registration and Information	Plaza A
Exhibits	Ballroom Foyer
Speaker Resource Desk	Plaza A

Friday, April 5		
Time	Meeting Name	Hotel Location
7:00-8:15 AM	Quality of Care Workshop I: Advancing Clinical Quality through IT Collaboration	Diplomat Room
8:30-9:00 AM	Opening Session	Grand Ballroom
9:00-10:15 AM	Plenary Session: Behavioral Economics	Grand Ballroom
10:45 AM-12:30 PM	QCOR 2019 Early Career Investigator Award Finalists	Grand Ballroom
10:45 AM-Noon	Policy to Payment to Practice	Plaza BC
10:45 AM-Noon	Quality of Care Workshop II: QCOR Shared Decision Making Workshop	Diplomat Room
12:30-2:00 PM	Career Development Lunch: Building Bulletproof Collaboration	Plaza D
2:00-3:15 PM	Plenary Session: AHA/CVCT Forum Joint Session: Real World Data for Evidence Generation in a Trial Dominated Cardiovascular Space Part I	Grand Ballroom
3:45-5:00 PM	Real-life Perspectives in Healthcare Quality: From Skills to Projects to Careers	Grand Ballroom
3:45-5:00 PM	Get With The Guidelines: Cardiovascular Systems of Care: The past, present and future	Diplomat Room
3:45-5:00 PM	Circ:CQO Workshop	Plaza BC
6:00-7:00 PM	Poster Session and Reception	Salon I & II
7:00-9:30 PM	QCOR Council Dinner	Salon III

Saturday, April 6		
Time	Meeting Name	Hotel Location
7:00-8:15 AM	"Guide Lines" vs the Bottom Line: Using Registry Process Measures to Influence Improvement in Outcomes & Financial Performance	Plaza BC
7:00-10:15 AM	Design Thinking in Action: How Might We Promote the New Physical Activity Guidelines?	Diplomat Room
9:00-10:15 AM	Abstract Oral Session: Data Science	Plaza BC
9:00 AM-Noon	Poster Session AM	Grand Ballroom
10:45 AM-Noon	AHA/CVCT Forum Joint Session: Real World Data for Evidence Generation in a Trial Dominated Cardiovascular Space Part II	Diplomat Room
10:45 AM-Noon	QCOR 2019 Early Career Investigator Award Semi-Finalists	Plaza BC
12:45-2:00 PM	Early Career Panel Discussion — Tell it to Me Straight: The Truth About Early Career	Plaza D
2:00-3:15 PM	Abstract Oral Session: Quality Improvement Initiatives	Plaza BC
2:00-3:15 PM	Transforming Cardiovascular Care Using Digital Health Technology: Where Are We Now and Where are We Going?	Diplomat Room
2:00-5:00 PM	Poster Session PM	Grand Ballroom
3:45-5:00 PM	GWTG: Improving Heart Failure Care in a Public Hospital	Diplomat Room
3:45-5:00 PM	Abstract Oral Session: Health IT	Plaza BC

General Information

Program Description

Participants in the Quality of Care and Outcomes Research in Cardiovascular Disease and Stroke 2019 Scientific Sessions play a major role in efforts to improve the quality of cardiovascular medical care and patient outcomes. It is the only major international meeting focused on cardiovascular issues in which clinical researchers interact in a meaningful way with policy makers and quality outcomes experts. The confluence of these players is critical in today's changing healthcare environment, in which quality and cost issues can no longer be divorced from clinical care or the patient experience.

The target audience for QCOR 2019 includes clinicians, researchers, medical students and trainees, nurses, pharmacists, administrators, healthcare and managed care professionals, policymakers and other professionals interested in quality of care and outcomes research in cardiovascular disease and stroke.

Learning Objectives

At the completion of this program, attendees should be able to:

1. Describe barriers to guidelines adherence, the benefits of guidelines adherence in clinical practice, and opportunities to improve guideline adherence in their practices.
2. Describe the value of registries and discuss opportunities to improve participation in registries and the use of the data to improve their own quality of care.
3. Describe the value of HIT in today's healthcare environment and opportunities to use HIT to improve outcomes and value.
4. Define patient experience and discuss its role in healthcare quality as well as opportunities to improve patient experience in their institutions.

Registration

Registration is located in room Plaza A in the Ritz-Carlton Pentagon City and is open throughout the conference. All conference attendees (including abstract presenters and speakers) must be registered to participate in the conference.

Registration Hours:

Friday	April 5, 2019	6:00 AM-7:30 PM
Saturday	April 6, 2019	6:30 AM-4:00 PM



WILEY

JAHA — Journal of the American Heart Association



18 days to first decision. Rapid online publication of accepted articles after payment of the Article Publication Charge.



AHA's Open Access, Online-Only Journal. All articles are free to read, download, and share. You retain copyright for noncommercial use of your article and are fully compliant with Open Access mandates.



Articles published in JAHA receive high media impressions. Altmetric scores allow you to easily measure the online impact of your research.



The journal's Impact Factor is 4.450, which ranks JAHA 36 among 128 journals in the Cardiac & Cardiovascular subject category (2017 Journal Citation Reports Science Edition, Clarivate Analytics, 2018).



Discounted Article Publication Charges for AHA/ASA members. For other member benefits, visit professional.heart.org/membership.



Visit: www.ahajournals.org/jaha/author-instructions

General Information

Get Social at QCOR 2019!

- Tweet from the meeting! -Follow @AHAMeetings and @AHAScience and Tweet, retweet, or tag your favorite conference photo. Please use hashtag #QCOR19!
- Join our AHA Early Career Group on Facebook! [facebook.com/groups/ahaearlycareer](https://www.facebook.com/groups/ahaearlycareer)
- Join the Discussion on Networking for Professionals: The Early Career Voice Blog — networking.professional.heart.org/blogs/100

AHA Volunteer Opportunities

Let us know how you would like to get involved. Complete the Science Volunteer Online Form at professional.heart.org/volunteerform!

Abstract Information

Abstracts presented at the Quality of Care and Outcomes Research in Cardiovascular Disease and Stroke 2019 Scientific Sessions will be published in the online version of *Circulation: Cardiovascular Quality and Outcomes*. To access this information, please go to https://professional.heart.org/professional/EducationMeetings/MeetingsLiveCME/QCOR/UCM_316906_QCOR-Scientific-Sessions.jsp.

Speaker Resource Desk

The Speaker Resource Desk is in room Plaza A at the Ritz-Carlton. Speakers are asked to deliver their presentations by email to the conference manager. Speakers may review and finalize their presentations on site. **It is imperative that you review your presentation at the Speaker Resource Desk if it contains video files or was created on a Mac computer. Staff will be on hand to assist with technical issues.**

Speaker Resource Room Hours:

Friday, April 5
6:00 AM–7:30 PM

Saturday, April 6
6:30 AM–4:00 PM

Conference Highlights

Don't miss the following speakers at QCOR 2019!

- Amy Abernethy, MD, PhD, Principal Deputy Commissioner of Food and Drugs
 - Marc Boutin, JD, National Health Council
 - Rachel Fleurence, PhD, NESTcc
 - Gregg C. Fonarow, MD, UCLA
 - Robert Harrington, MD, Stanford University
 - David Martin, MD, MPH, U.S. Food and Drug Administration
 - Michelle McMurray-Heath, MD, PhD, Johnson & Johnson
 - Mitesh S. Patel, MD, MBA, MS, University of Pennsylvania
 - Elana Safran, MPA, Office of Evaluation Sciences, General Services Administration
 - Richard J. Willke, PhD, ISPOR
 - Charlene Wong, MD, MSPH, Duke-Margolis Center for Health Policy
- And many more!

QCOR Lifetime Achievement Award – Dr Gregg C. Fonarow is the 2019 recipient of this award and is a keynote speaker at the Council Dinner.

Workshops

- Quality of Care Workshop I: Advancing Clinical Quality through IT Collaboration – Healthcare quality management requires a critical balance of clinical; technical and project management skills. Many quality improvement initiatives are directed from the service lines by busy, nursing management, with limited exposure to Information Technology and project management. And while almost everyone agrees electronic health system integration is key; few know how to include the correct stakeholders; prioritize the IT resources and set the proper expectations for a successful project.
- Quality of Care Workshop II – Tricks of the Trade: The Current State of Shared Decision Making
- Circ: CQO Workshop
- Design Thinking in Action: How Might We Promote the New Physical Activity Guidelines? – A unique hands-on co-creation workshop led by designers from Google, this session will explore creative ways to promote physical activity. Discover how you can promote the guidelines in your sphere of influence. Experience design thinking in action and see how you could apply its principles in your own work.

QCOR 2019 Early Career Investigator Award Finalists – Abstract Oral Session highlighting the top five Young Investigator Award Finalists.

Career Development Lunch: Building Bulletproof Collaborations – Network with colleagues in this mentor/mentee lunch. The winner of the QCOR 2019 Early Career Investigator Award will also be announced during the luncheon.

Poster Session and Reception – Includes poster presentations highlighting early career investigators.

Don't miss the abstract oral sessions on data science and health IT!

Council Dinner

Join us for dinner at 7:00 PM Friday in Salon III. The keynote speaker will be the recipient of this year's Recognition of 2019 QCOR Outstanding Achievement Award, **Dr Gregg C. Fonarow**. *Tickets may be purchased in advance at the AHA Registration Desk.*

Exhibits

Please visit our exhibitors in the foyer area during breaks throughout the conference. The full list of exhibitors is provided at the conference Registration Desk.

Conference Awards

The AHA Council on Quality of Care and Outcomes Research Recognition of Outstanding Achievement Award



Gregg C. Fonarow, MD

Dr. Gregg C. Fonarow serves as Director of the Ahmanson-UCLA Cardiomyopathy Center, Co-Chief of UCLA's Division of Cardiology, and Co-director of UCLA's Preventative Cardiology Program

This award is presented to Dr. Fonarow for his significant long-term contribution to outcomes research and the improvement of cardiovascular care. Dr. Fonarow will be honored at the QCOR Council Dinner at 7:00 PM Friday in Salon III.

Young Investigator Abstract Award

The award competition recognizes contributions of young investigators in the field of cardiovascular outcomes research. The five finalists' highly rated abstracts will be presented during a special oral abstract session at 10:45 AM-12:30 PM Friday. The winner will be announced at the Career Development Luncheon to follow.

The finalists are:

1. **Enrico Giuseppe Ferro**, Smith Center for Outcomes Research in Cardiology, Beth Israel Deaconess Medical Center, Boston, Massachusetts
2. **Ali O. Malik**, Saint Luke's Mid America Heart Institute, Kansas City, Missouri
3. **Sameed Ahmed M. Khatana**, University of Pennsylvania, Philadelphia, Pennsylvania
4. **Ashwin S. Nathan**, University of Pennsylvania, Philadelphia, Pennsylvania
5. **Tran Nguyen**, George Washington Hospital, Washington, DC

Council Early Career Investigator Travel Stipend Awards

These awards provide travel support to the most outstanding early career investigator and trainee members of the council who are presenting research at the meeting. They encourage and enable young investigators, graduate students, women and under-represented minority participation in council and AHA activities

Presentation/

Poster Board No.	Name	Day/Time	Session Title
213	Olajide Buhari	2:30-4:00 PM Saturday	Poster Session PM
216	Elias J. Dayoub	2:30-4:00 PM Saturday	Poster Session PM
221	Ahmed Elkaryoni	2:30-4:00 PM Saturday	Poster Session PM
	Rebeka Mukherjee	9:00-9:15 AM Saturday	Abstract Oral Session: Data Science
255	Max Jordan Nguemini Tiako	2:30-4:00 PM Saturday	Poster Session PM
170	Niveditta Ramkumar	9:30-11:00 AM Saturday	Poster Session AM
192	Xiaowen Wang	9:30-11:00 AM Saturday	Poster Session AM

Paul Dudley White International Scholar Award (PDW)

The Paul Dudley White International Scholar Award recognizes and encourages international abstract submission to all of AHA's Scientific Sessions including specialty meetings.

As one of the founders of the American Heart Association, Paul Dudley White was also a champion for global cardiovascular health strategies. The work of these teams, chosen by their peers, reflect Dr. White's vision for global excellence in cardiovascular science and medicine.

Presentation/

Poster Board No.	Name	Country
284	Madeline Sterling	United States
192	Xiaowen Wang	United States
191	Muhammad Ahmer	Canada
293	Xin Zheng	China
114	Edgar Daeter	Netherlands

Policy Information

Disclaimer

The Quality of Care and Outcomes Research in Cardiovascular Disease and Stroke 2019 Scientific Sessions is a scientific and educational conference to exchange and discuss research results and scientific developments in the field of cardiovascular outcomes research. Accordingly, the American Heart Association cannot and does not offer any assurance or warranty of the accuracy, truthfulness or originality of the information presented at the conference

Embargo Guidelines

Abstracts, lectures and presentations in QCOR 2019 are embargoed for release at the time of presentation. Information may not be released before the scheduled presentation time.

Photography/Recording Policy

Unauthorized recording of the AHA Scientific Sessions, scientific conferences and the ASA International Stroke Conference is prohibited, whether by video, still or digital photography, audio or any other recording or reproduction mechanism. This includes recording of presentations and supporting audio-visual materials, poster presentations and supporting poster materials.

The American Heart Association and America Stroke Association reserve the rights to all recordings or reproductions of presentations at AHA/ASA scientific conferences and meetings. Check the program for information about the availability of videotapes or audiotapes for purchase. Exceptions to this policy prohibition are:

1. Non-flash photography of the speaker and his/her presentation materials is permitted by attendees or AHA/ASA accredited reports upon the prior written consent of the AHA/ASA and of the speaker.
2. Audiotape recording for strictly personal and non-commercial use is permitted if not disruptive; and exhibitors may photograph their own booth for promotional purposes upon prior written consent of the AHA/ASA.

Conference Photography

Please be aware that during QCOR 2019 attendees, vendors and guests may be photographed and videotaped by AHA vendors in capturing the event. Some of these photographs or videos may be displayed by the AHA in future publications or materials connected with the event. If you do not wish your image to be displayed by the AHA, please contact the AHA in writing at 7272 Greenville Avenue, Dallas, TX 75231, Attention: Manager, Scientific Conferences, QCOR 2019 Scientific Sessions.

No-Smoking Policy

AHA policy prohibits smoking in conference meeting rooms and exhibits/registration areas. Thank you for your cooperation.

Seating/Badge Requirement

Seating is on a first-come, first-served basis. According to fire code, a session must be closed if the room fills to capacity. You must wear your name badge at all times during the symposium. Nonregistered guests may not be permitted into the sessions or food and beverage events. Be sure to remove your badge when you leave the conference or your hotel room.

The American Heart Association reserves the right to revoke or deny attendance to any registered participant, speaker, exhibitor, news media reporter, or photographer of presentations or activities at AHA/ASA scientific conferences and meetings.

Program Agenda

FRIDAY

FRIDAY, APRIL 5

6:00 AM–7:30 PM
Registration Open
Plaza A

7:00–8:15 AM
**Quality of Care Workshop:
Advancing Clinical Quality Through
IT Collaboration**
Diplomat Room

Moderator:
Cherie Boxerberger, American Heart Association,
Dallas, TX

Invited Presenters:
Scott Rosignol, Nordic, Madison, WI
Leanna Hester, Nordic, Madison, WI
Jake Aleckson, Nordic, Madison, WI

8:30–9:00 AM
Opening Session
Grand Ballroom

- 8:30 **QCOR 2019 Program Chair Remarks**
Adrian F. Hernandez, Duke Clinical Research Institute,
Durham, NC
- 8:40 **AHA President Welcome Remarks**
Ivor J. Benjamin, Medical College of Wisconsin,
Milwaukee, WI

9:00–10:15 AM
**Plenary Session:
Behavioral Economics**
Grand Ballroom

Moderators:
Adrian F. Hernandez, Duke Clinical Research
Institute, Durham, NC
Michael Ho, University of Colorado Health
Science Center, Denver, CO

- 9:00 **Behavioral Economics and Physical Activity**
Mitesh Patel, University of Pennsylvania,
Philadelphia, PA
- 9:20 **Financial Incentives for Physical Activity and
Glucose Control**
Charlene Wong, Duke University,
Durham, NC
- 9:40 **Policy**
Elana Safran, Office of Evaluation Sciences, U.S.
General Services Administration, Washington, DC
- 10:00 **Discussion**

10:15–10:45 AM
Break and Exhibits
Ballroom Foyer

10:45 AM–12:30 PM
**QCOR 2019 Early Career
Investigator Award Finalists**
Grand Ballroom

Moderators:
Emily O'Brien, Duke Clinical Research Institute,
Durham, NC
Boback Ziaieian, UCLA, Los Angeles, CA

- 10:45 **Readmission Rates Across All Insurance Types
After Passage of the Hospital Readmissions
Reduction Program: A Nationwide Analysis**
Enrico Giuseppe Ferro, Eric A. Secemsky, Rishi K.
Wadhwa, Eunhee Choi, Jordan B. Strom, Jason H.
Wasfy, Yun Wang, Changyu Shen, Robert W. Yeh,
Smith Center for Outcomes Research in Cardiology,
Beth Israel Deaconess Medical Center, Boston, MA
- 10:55 **Discussant**
Jeremy Sussman, University of Michigan, Ann Arbor, MI
- 11:00 **Q&A/Discussion**
- 11:05 **Association of Ambient Air PM2.5 Concentration
with Health Status in Patients Following
Myocardial Infarction**
Ali O. Malik, Poghni Peri-Okonny, Vittal Hejjaji,
Philip G. Jones, Paul Chan, John Spertus, Saint
Luke's Mid America Heart Institute, Kansas City, MO
- 11:15 **Discussant**
Brahmajee Nallamothe, University of Michigan,
Ann Arbor, MI
- 11:20 **Q&A/Discussion**
- 11:25 **Association of Medicaid Expansion with
Cardiovascular Mortality — A Quasi-experimental
Analysis**
Sameed Ahmed M. Khatana, Anjali Bhatla,
Ashwin S. Nathan, Jay Giri, University of
Pennsylvania, Philadelphia, PA; Changyu Shen,
Dhruv S. Kazi, Robert W. Yeh, Beth Israel
Deaconess Medical Center, Boston, Massachusetts;
Peter W. Groeneveld, University of Pennsylvania,
Philadelphia, PA
- 11:35 **Discussant**
Larry Allen, University of Colorado, Aurora, CO
- 11:40 **Q&A/Discussion**
- 11:45 **Disparities in the Use of Direct Oral Anticoagulant
Treatment of Venous Thromboembolism in the
United States, 2010-2016**
Ashwin S. Nathan, Zhi Geng, Swathi Raman,
Elias Dayoub, Srinath Adusumalli, Sameed A.
Khatana, Steven Pugliese, Taisei Kobayashi, Jay
Giri, Peter Groeneveld, University of Pennsylvania,
Philadelphia, PA

Program Agenda (continued)

- 11:55 **Discussant**
Tracy Wang, Duke Clinical Research Institute, Durham, NC
- Noon **Q&A/Discussion**
- 12:05 **Cardiovascular Disease in Transgender Populations**
Tran Nguyen, Talal Alzahrani, Ahmad Dwairy, Raza Yunus, James McCaffery, Angela Ryan, Joseph Forgione, Christian Nagy, Ramesh Mazhari, Johnathan Reiner, George Washington Hospital, Washington, DC
- 12:15 **Discussant**
Shannon Dunlay, Mayo Clinic, Rochester, MN
- 12:20 **Q&A/Discussion**

10:45 AM–Noon
Policy to Payment to Practice
Plaza BC

Moderator:
William Borden, George Washington University, Washington, DC

- 10:45 **Health Equity and High-Value Care**
Karen Joynt Maddox, Washington University, St. Louis, MO
- 11:00 **Evolving Medicare Payment Landscape**
Janet Marchibroda, Bipartisan Policy Center, Washington, DC
- 11:15 **Innovative Care with Telehealth**
Bimal Shah, Duke University, Durham, NC
- 11:30 **Providing the Evidence for Health Policy**
Lisa Simpson, Academy Health, Washington, DC
- 11:45 **Q&A/Discussion**

10:45 AM–Noon
Quality of Care Workshop:
Tricks of the Trade – The Current State of Shared Decision Making
Diplomat Room

Moderators:
Kim Smolderen, Saint Luke's Mid America Heart Institute, Kansas City, MO
Colleen McIlvannan, University of Colorado, Aurora, CO

- 10:45 **Introduction**
- 10:55 **Risk Communication and Development of Decision Support Tools**
Dan Matlock, University of Colorado, Aurora, CO
- 11:20 **Shared Decision Making: A Powerful Tool for Improvement in Quality of Care and Clinical Outcomes**
Erica Spatz, Yale University, New Haven, CT
- 11:45 **Panel Discussion**

12:30–2:00 PM
Career Development Luncheon
***Ticketed Event**
Plaza D

Moderators:
Madeline Sterling, Cornell University, Ithaca, NY
Michael Thompson, University of Michigan, Ann Arbor, MI

Speakers:
Erica Spatz, Yale University, New Haven, CT
Jeremy Sussman, University of Michigan, Ann Arbor, MI

Table Leaders:
Karen Joynt Maddox, Washington University School of Medicine, Saint Louis, MO
Tracy Wang, Duke Clinical Research Institute, Durham, NC
Nancy Albert, Cleveland Clinic, Chesterland, OH
John Spertus, Mid America Heart Institute, Kansas City, MO
Donald Likosky, University of Michigan, Ann Arbor, MI

2:00–3:15 PM
Plenary Session:
AHA/CVCT Forum Joint Session – Real World Data for Evidence Generation in a Trial Dominated Cardiovascular Space Part I
Grand Ballroom

Moderators:
Adrian F. Hernandez, Duke Clinical Research Institute, Durham, NC
Michael Ho, University of Colorado Health Science Center, Denver, CO

- 2:00 **FDA's Framework for Evaluating the Regulatory Use of Real-World Evidence**
Amy Abernethy, Food and Drug Administration, Silver Spring, MD
- 2:15 **What is Regulatory-Grade Real World Evidence Data?**
David Martin, Food and Drug Administration, Silver Spring, MD
- 2:30 **Why Do Patients Need Real World Evidence Now?**
Marc Boutin, National Health Council, Washington, DC
- 2:45 **How Should Guidelines Leverage Real World Evidence?**
Gregg C. Fonarow, UCLA Medical Center, Los Angeles, CA
- 3:00 **Panel Discussion**

3:15–3:45 PM
Break and Exhibits
Ballroom Foyer

Program Agenda (continued)

FRIDAY/SATURDAY

3:45–5:00 PM

Real-life Perspectives in Healthcare Quality: From Skills to Projects to
Grand Ballroom

Moderator:

Michael Ho, University of Colorado, Aurora, CO

- 3:45 **Creating Your Personal Toolkit in Healthcare Quality: Skills You Need to Succeed**
Sandeep Das, UT Southwestern, Dallas, TX
- 4:00 **Visualizing and Achieving Quality: Real-Life Practical Steps to Ensure Quality**
Umesh Khot, Cleveland Clinic, Cleveland, OH
- 4:15 **Pitfalls and Challenges in the Road to Quality: Navigating and Avoiding Potholes**
Ty Gluckman, Providence, Portland, OR
- 4:30 **Career Opportunities in Healthcare Quality: From Research to Care Delivery**
Steven Bradley, Allina, Minneapolis, MN
- 4:45 **Q&A/Discussion**

3:45–5:00 PM

Get With The Guidelines: Cardiovascular Systems of Care — The past, present and future
Diplomat Room

Moderator:

Steve Dentel, American Heart Association, Dallas, TX

- 3:45 **Speaker:**
Alice Jacobs, Boston Medical Center, Boston, MA

3:45-5:00 pm
Circ:CQO Workshop
Plaza BC

- 3:45 **Speaker:**
Brahmajee Nallamothu, University of Michigan, Ann Arbor, MI
- Panelist:**
Cynthia Jackevicius, Western University, Los Angeles, CA

6:00-7:00 PM

Poster Session Reception
Salon I & II

Posters 11-20

7:00-9:30 PM

QCOR Council Dinner and Recognition of the 2019 QCOR Outstanding Achievement Award*
***Ticketed Event**
Grand Ballroom

Keynote Lecture:

Gregg C. Fonarow, UCLA, Los Angeles, CA
Recipient of the 2019 Outstanding Achievement Award

SATURDAY, APRIL 6

6:30 AM–4:00 PM

Registration Open
Plaza A

7:00-8:15 AM

GWTG: “Guide Lines” vs the Bottom Line: Using Registry Process Measures to Influence Improvement in Outcomes & Financial Performance
Plaza BC

Moderator:

Steve Dentel, American Heart Association, Dallas, TX

- 7:00 **Speaker:**
Roger London, CHSLI, Tarrytown, NY

7:00-10:15 AM

Workshop: Design Thinking in Action — How Might We Promote the New Physical Activity Guidelines?
***Ticketed event**
Diplomat Room

Moderator:

Kapil Parakh, Google Fit, Baltimore, MD

- 7:00 **Facilitators:**
Lakshmi Tummala, VA, Washington, DC
Mark Herbst, Google Fit, Washington, DC
Lalymar Havern, Walgreens, Deerfield, IL
Sara Vrbinc, Google UK, London, United Kingdom
Ted Pollari, Humana, Arlington Heights, IL
Ivy Chen, Google, Mountain View, CA
Alicia Cormie, Google, Mountain View, CA

Program Agenda (continued)

9:00-10:15 AM

Abstract Oral Session: Data Science

Plaza BC

Moderators:

Colleen McIlvennan, University of Colorado,
Aurora, CO

Emily O'Brien, Duke Clinical Research Institute,
Durham, NC

- 9:00 **Comparison of Methods to Identify Atrial Fibrillation Patients from the Electronic Medical Record**
Rebeka Mukherjee, Aubrey E. Jones, Ian Hackett, University of Utah, Salt Lake City, UT; Donald M. Lloyd-Jones, Northwestern University, Chicago, Illinois; Jennifer Springer, Benjamin A. Steinberg, Rashmee U. Shah, University of Utah, Salt Lake City, UT
- 9:15 **Deep Learning on Echocardiography to Identify Systemic Phenotypes and Unsupervised Learning of Clinical Measurements**
David Ouyang, Amirata Ghorbani, David Liang, Euan Ashley, James Zou, Stanford, Menlo Park, CA
- 9:30 **Patient Level Prediction Models Developed With Large Observational Databases Outperformed Existing Clinical Prediction Scores For Stratifying Bleeding Risk In Patients With Atrial Fibrillation**
Clair Blacketer, Jenna Repts, Lu Wang, Janssen Research and Development, Titusville, NJ; Qingqin Li, Janssen Research and Development, Pennington, New Jersey; Juliane Bernholz, Leila Larbi, Janssen Research and Development, Raritan, NJ; JoAnne Foody, Kenneth Moore, Janssen Research and Development, Spring House, PA; Anne Hermanowski-Vosatka, Janssen Research and Development, Raritan, NJ; Gary Peters, Janssen Research and Development, Raritan, NJ; Zhong Yuan, Patrick Ryan, Janssen Research and Development, Titusville, NJ
- 9:45 **Diabetic Ketoacidosis in Patients with Type 2 Diabetes Treated with Sodium Glucose Co-transporter 2 Inhibitors versus Other Antihyperglycemic Agents: An Observational Study of Four US Administrative Claims Databases**
Lu Wang, Janssen Res and Development, LLC, Titusville, NJ; Erica A. Voss, Janssen Research and Development, LLC, Raritan, NJ; James Weaver, Laura Hester, **Zhong Yuan**, Janssen Research and Development, LLC, Titusville, NJ; Frank DeFalco, Janssen Research and Development, LLC, Raritan, NJ; Martijn J. Schuemie, Patrick B. Ryan, Don Sun, Amy Freedman, Janssen Research and Development, LLC, Titusville, NJ; Maria Alba, Joan Lind, Gary Meininger, Janssen Research and Development, LLC, Raritan, New Jersey; Jesse A. Berlin, Johnson & Johnson, Titusville, NJ; Norman Rosenthal, Janssen Research and Development, LLC, Raritan, NJ

- 10:00 **Abnormalities within Normal Sinus Rhythm**
Sadip Giri, Bennington College, Bennington, VT; John L. Jefferies, Fridtjof Thomas, Robert L. Davis, **Oguz Akbilgic**, University of Tennessee Health Science Center, Memphis, TN

9:00 AM-Noon

Poster Session AM

Grand Ballroom

Posters 101-199.1

10:15-10:45 AM

Break and Exhibits

Ballroom Foyer

10:45 AM-Noon

AHA/CVCT Forum Joint Session:

Real World Data for Evidence Generation in a Trial Dominated Cardiovascular Space Part II

Diplomat Room

Moderator:

Adrian F. Hernandez, Duke Clinical Research Institute, Durham, NC

- 10:45 **How Real World Evidence May Serve Device Innovation: NEST Perspective**
Rachael Fleurence, NESTcc, Washington, DC
- 11:00 **How Real World Evidence May Serve Device Innovation: Industry Viewpoint**
Michelle McMurray-Heath, Johnson & Johnson, Washington, DC
- 11:15 **Real World Evidence for Drug Effectiveness Evaluation**
Richard Willke, ISPOR, Lawrenceville, NJ
- 11:30 **Trialist Viewpoint: Can Trials Only Tell the Truth?**
Robert Harrington, Stanford University, Stanford, CA
- 11:45 **Discussion**

10:45 AM-Noon

Young Investigator Award Semi-Finalists

Plaza BC

Moderator:

Joseph Ebinger, Cedars-Sinai, Los Angeles, CA

- 10:45 **The Corrie Myocardial infarction, COmbined-device, Recovery Enhancement (MiCORE) Study: 30-Day Readmission Rates and Cost-Effectiveness of a Novel Digital Health Intervention for Acute Myocardial Infarction Patients**
Francoise A. Marvel, Johns Hopkins University School of Medicine, Baltimore, Maryland; Erin M. Spaulding, Johns Hopkins School of Nursing, Baltimore, MD; Matthias Lee, Ciccarone Preventive Cardiology Center, Baltimore, MD; William Yang, Seth S. Martin, Johns Hopkins University School of Medicine, Baltimore, MD

SATURDAY

Program Agenda (continued)

SATURDAY

11:00 **Mining Big Data to Estimate the Frailty Index in Patients with Congestive Heart Failure: Clinical Expert vs Machine Learning**
Javad Razjouyan, Aanand D. Naik, VHA, Houston, TX; Bijan Najafi, Baylor College of Medicine, Houston, TX; Jacqueline Shahin, Salim S. Virani, Molly J. Horstman, VHA, Houston, TX

11:15 **Electronic Medical Record-Based Appointment Order Improves Cardiology Follow-Up After Discharge**
Kartik Telukuntla, Tim Sobol, Chetan Huded, Mouin Abdallah, Kathleen Kravitz, Michael Hulseman, Benico Barzilai, Randall Starling, Lars Svensson, Umesh Khot, Cleveland Clinic Foundation, Cleveland, OH

11:30 **Appropriateness of Percutaneous Coronary Intervention in Patients with Stable Coronary Artery Disease: Department of Veterans Affairs, 2013-2015**
Paul L. Hess, Eastern Colorado Health Care System, Aurora, CO; Vinay Kini, University of Colorado Anschutz Medical Campus, Aurora, CO; Wenhui Liu, Eastern Colorado Health Care System, Aurora, CO; Paola Roldan, Oregon Health & Science University School of Medicine, Portland, OR; Patrick Autruong, University of Colorado Anschutz Medical Center, Aurora, CO; Jacob A. Doll, VA Puget Sound Health Care System, Seattle, WA; P. Michael Ho, Eastern Colorado Health Care System, Aurora, CO; Steven M. Bradley, Minneapolis Heart Institute, Minneapolis, MN

11:45 **Association of Cardiovascular Risk Factor Profile with Financial Hardship from Medical Bills and Other Cost-Related Barriers to Care Among U.S. Non-Elderly Adults: The National Health Information Survey 2013-2017**
Gowtham R. Grandhi, Javier Valero-Elizondo, Center for Outcomes Research and Evaluation, Yale New Haven Hospital, New Haven, CT; Eric J. Brandt, Yale School of Medicine, New Haven, CT; Amarnath Annapureddy, Center for Outcomes Research and Evaluation, Yale New Haven Hospital, New Haven, CT; Anshul Saxena, Baptist Health South Florida, New Haven, CT; Nihar R. Desai, Erica S. Spatz, Khurram Nasir, Center for Outcomes Research and Evaluation, Yale New Haven Hospital, New Haven, CT

Noon-2:00 PM
Break and Exhibits
Ballroom Foyer

12:45-2:00 PM
Early Career Panel Discussion — Tell it to Me Straight: The Truth About Early Career
Plaza D

Moderators:
Rashmee Shah, University of Utah, Salt Lake City, UT
Faraz Ahmad, Northwestern University, Chicago, IL

12:45 **Panelists:**
John Spertus, UMKC, Kansas City, MO
Karen Joynt Maddox, Washington University, St. Louis, MO
Umesh Khot, Cleveland Clinic, Cleveland, OH
Paul Muntner, University of Alabama at Birmingham, Birmingham, AL

2:00-3:15 PM
Abstract Oral Session: Quality Improvement Initiatives
Plaza BC

Moderator:
Ty Gluckman, Providence Heart Inst, Portland, OR

2:00 **Center-specific Variation in Use of Dual Antiplatelet Therapy Prior to Coronary Surgery: an Outcomes Analysis from the Maryland Cardiac Surgery Quality Initiative**
Thomas Stephen Metkus, Johns Hopkins University School of Medicine, Baltimore, MD; Sari D. Holmes, University of Maryland School of Medicine, Baltimore, MD; Diane Alejo, Johns Hopkins Hospital, Baltimore, MD; Clifford E. Fonner, Maryland Cardiac Surgery Quality Initiative, Baltimore, MD; Michael Mazzeffi, University of Maryland School of Medicine, Baltimore, Maryland; Stefano Schena, Johns Hopkins University School of Medicine, Baltimore, MD; Rawn Salenger, Bradley Taylor, University of Maryland School of Medicine, Baltimore, MD; Niv Ad, Washington Adventist Hospital, Takoma Park, Maryland; Jennifer Lawton, Glenn J. Whitman, Johns Hopkins University School of Medicine, Baltimore, MD

2:15 **Implementation of Bedside CYP2C19 Genotype Testing and Personalization of Antiplatelet Therapy in Cardiac Catheterization Lab**
Kevin P. Bliden, Manila Jindal, Udaya Tantry, Ankit Vyas, Paul Gurbel, Inova Heart and Vascular Institute, Falls Church, VA

2:30 **Impact of a Mobile Application for ACLS on House Staff Performance During Cardiac Arrest Simulations**
Ali O. Malik, Vittal Hejjaji, Poghni Peri-Okonny, Yuanyuan Tang, Saint Luke's Mid America Heart Institute, Kansas City, MO; Merrill Thomas, David Wooldridge, University of Missouri, Kansas City, Kansas City, MO; Paul S. Chan, Saint Luke's Mid America Heart Institute, Kansas City, MO

Program Agenda (continued)

2:45 **Implementation of a Novel Fast-Track Extubation Protocol after Routine and Complex Adult Cardiovascular Operations**

Myra F. Ellis, Heather Pena, Debra Farrell, Duke University Hospital, Durham, NC; Allen Cadavero, Duke University School of Nursing, Durham, NC; Kelly Kester, Mollie Kettle, Carrie Parker, Emily Robinson, Alexandra Rudolph, Emily Suplee, Tonda Thomas, Duke University Hospital, Durham, NC; Bradi B. Granger, Duke University School of Nursing, Durham, NC; Kamrouz Ghadimi, Duke University Hospital, Durham, NC

3:00 **Developing a Systematic Process for Evaluating Heart Failure (HF) Patients Presenting to the Emergency Department: The Code HF Project**

Vittal Hejjaji, University of Missouri Kansas City, Kansas City, MO; Alison M. Scholes, Saint Luke's Health System of Kansas City, Kansas City, MO; Yevgeniy Khariton, University of Missouri Kansas City, Kansas City, MO Kevin Kennedy, Evelyn Dean, Joseph Barrios, Saint Luke's Health System of Kansas City, Kansas City, MO; John A. Spertus, University of Missouri Kansas City, Kansas City, MO

2:00-3:15 PM

Transforming Cardiovascular Care Using Digital Health Technology: Where Are We Now and Where are We Going?

Diplomat Room

Moderators:

Tariq Ahmad, Yale University, New Haven, CT
Erica Spatz, Yale University, New Haven, CT

2:00 **Transforming Cardiovascular Care Using Digital Health: Barriers and Opportunities**

Mintu Turakhia, Stanford University, Stanford, CA

2:15 **Incorporating Novel Technologies into Clinical Practice**

Maulik Majmudar, Amazon, Boston, MA

2:30 **How Will Digital Health Transform Clinical Trials**

Robert Harrington, Stanford University, Stanford, CA

2:45 **Using Digital Health to Empower Patients**

Christina Silcox, Duke-Margolis Center for Health Policy, Washington, DC

2:00-5:00 PM

Poster Session PM

Grand Ballroom

Posters 201-294

3:15-3:45 AM

Break and Exhibits

Ballroom Foyer

3:45-5:00 PM

Get With The Guidelines:

Improving Heart Failure Care in a Public Hospital
Diplomat Room

Moderator:

Cherie Boxerberger, American Heart Association, Dallas, TX

3:45 **Invited Presenter:**

Nasser Lakkis, Baylor Medical Center, Houston, TX

3:45-5:00 PM

Abstract Oral Session: Health IT

Plaza BC

Moderator:

Shannon Dunlay, Mayo Clinic, Rochester, MN

3:45 **WITHDRAWN**

4:00 **Experiences and Perspectives of Low Income Patient Populations in Using a Mobile Health Application with Tailored Assistance of a Community Health Worker**

Patrick Liu, Yale University, New Haven, CT; Katia Astudillo, Damaris Velez, Lauren Kelley, Project Access New Haven, New Haven, CT; Dave Hutten, Leslie Krumholz, Hugo Health, Guilford, CT; Darcey Cobbs-Lomax, Project Access New Haven, New Haven, CT
Erica Spatz, Yale University, New Haven, CT

4:15 **Digital Strategies for Controlling High Blood Pressure**

Donald E. Casey Jr., Jefferson College of Population Health, Philadelphia, PA; Kate Kirley, American Medical Association, Chicago, IL

4:30 **Creating a Dilated Cardiomyopathy Registry to Drive Population-level Quality Improvement Projects**

Bryanna Schwartz, Ranjodh Badh, Children's Natl Health System, Washington, DC; Lisa Jones, Cerner Corp., Washington, DC; Brian Jacobs, Niti Dham, Children's Natl Health System, Washington, DC

Adjourn

SATURDAY

Poster Sessions

APS.01. Poster Session and Reception Friday, April 5, 2019, 6:00-7:00 PM <i>Salon I & II</i> Poster Presenter Available: 6:00-7:00 PM			
Presentation Number	Poster Board Number	Title	Author Block
11	11	Comparative Effectiveness and Safety of Oral Anticoagulants across Baseline Kidney Function	Xiaoxi Yao , Jonathan W Inselman, Nilay D Shah, Mayo Clinic, Rochester, MN; Joseph S Ross, Yale Sch of Med, New Haven, CT; Rima Izem, Children's Natl Hosp, Washington DC, DC; David Graham, David Martin, US Food and Drug Admin, White Oak, MD; Aliza Thompson, Mary R Southworth, U.S. Food and Drug Admin, White Oak, MD; Konstantinos C Siontis, Che G Ngufor, Karl Nath, Mayo Clinic, Rochester, MN; Nihar R Desai, Yale-New Haven Hosp, New Haven, CT; Brahmajee Nallamothu, Rajiv Saran, Univ of Michigan, Ann Arbor, MI; Peter A Noseworthy, Mayo Clinic, Rochester, MN
12	12	Overutilization and Financial Impact of Intravenous Magnesium Repletion – a High Value Care Initiative	Nimish N Shah , Christopher Mathew, Timothy J Brown, Deepak Agrawal, Sandeep R Das, Univ of Texas Southwestern Medical Ctr, Dallas, TX
13	13	Evaluation of a FHIR-based Clinical Decision Support Tool for Calculating CHA2DS2-VASc Scores	Zameer Abedin , Robert Hoerner, Kensaku Kawamoto, Univ of Utah, Salt Lake City, UT; Joseph Habboushe, MD Aware, New York, NY; Yi Lu, MD Aware, New York, NY; Phillip B Warner, David E Shields, Rashmee U Shah, Univ of Utah, Salt Lake City, UT
14	14	Secular Trends in Racial and Socioeconomic Status Disparities in the Rate of Coronary Revascularization Among Post-Menopausal Women Before and After 2005 for Acute Coronary Syndrome: The Women Health Initiative	Tarryn Tertulien , Brown Univ, Providence, RI; K Breathett, Div of Cardiology, Advanced Heart Failure & Transplant, Univ of Arizona, Tucson, AZ; C W Cene, Dept of Med, Univ of North Carolina at Chapel Hill, Chapel Hill, NC; G Corbie-Smith, Dept of Social medicine and Med Univ of North Carolina at Chapel Hill, Chapel Hill, NC; R Nassir, Dept of Pathology Sch of medicine, Umm Al-Quara Univ, Mecca, Saudi Arabia; M Allison, Dept of Family Med and Public Health, Univ of California, San Diego, CA; M B Roberts, Ctr for Primary Care and Prevention, Memorial Hosp of Rhode Island, Pawtucket, RI; J Manson, Dept of Med, Harvard Medical Sch, Boston, MA; C B Eaton, Dept of Med, Alpert Medical Sch of Brown Univ, Dept of Epidemiology, Brown Univ Sch of Public Health, Providence, RI
15	15	Telephone Intervention to Improve Quality and Safety After Percutaneous Coronary Intervention	Jeffrey P Chidester , Daniel Bennett, Kim Berger, Univ of Texas Southwestern, Dallas, TX; Laurie Beall, Tiffany Denkins, Chris Mathew, Kristin Alvarez, Parkland Health and Hosp System, Dallas, TX; Michael Luna, Tayo Addo, Rebecca Vigen, Sandeep R Das, Univ of Texas Southwestern, Dallas, TX
16	16	WITHDRAWN	
17	17	WITHDRAWN	

Poster Sessions (continued)

18	18	Factors Associated with Variation in Diagnostic Testing of Patients Admitted with Syncope	Timothy S Anderson, Grace Lin, Univ of California San Francisco, San Francisco, CA
19	19	Cardiovascular Health Amongst Asian-Americans: National Health and Nutrition Examination Study	Rajat Kalra, Univ of Minnesota, Minneapolis, MN; Nirav Patel, Univ of Alabama at Birmingham, Birmingham, AL; Rajkumar Doshi, Univ of Nevada, Reno, NV; Garima Arora, Pankaj Arora, Univ of Alabama at Birmingham, Birmingham, AL
20	20	Are We Ready for High(er) Sensitivity Troponin Assays? The Positive Predictive Value of a Contemporary Troponin Assay for Acute Myocardial Infarction	Andrew E. Levy, Karen S. Ream, Andrew Hammes, Eric Rudofker, Natalie Beck, Joshua D. Raines, Kimberly J. Marshall, Jessica D. Nensel, Debra L. Anoff, John C. Messinger, Frederick A. Masoudi, Larry A. Allen, P. Michael Ho, Univ of Colorado, Aurora, CO
APS.02. Poster Session AM Saturday, April 6, 2019, 9:00 AM-Noon <i>Grand Ballroom</i> Poster Presenter Available: 9:30-11:00 AM			
Presentation Number	Poster Board Number	Title	Author Block
101	101	The Development and Initial Validation of PROMIS-Plus-HF Profile Measure	Faraz S Ahmad , Michael A Kallen, Northwestern Univ Feinberg Sch of Med, Chicago, IL; Karen E Schifferdecker, Kathleen L Carluzzo, Geisel Sch of Med at Dartmouth, Lebanon, NH; Susan E Yount, Northwestern Univ Feinberg Sch of Med, Chicago, IL; Jill M Gelow, Oregon Health & Science Univ Knight Cardiovascular Inst, Portland, OR; Peter A McCullough, Baylor Univ Medical Ctr, Dallas, TX; Stephen E Kimmel, Univ of Pennsylvania Perelman Sch of Med, Philadelphia, PA; Elliot S Fisher, Geisel Sch of Med at Dartmouth, Lebanon, NH; David Cella, Northwestern Univ Feinberg Sch of Med, Chicago, IL
102	102	The Association of Patient Navigator Program Features and Hospital Strategies with Processes and Outcome Metrics in Acute Myocardial Infarction and Heart Failure	Nancy M Albert , Cleveland Clinic, Cleveland, OH; Ty J Gluckman, Providence Heart and Vascular Inst, Portland, OR; Robert McNamara, Yale Univ Sch of Med, New Haven, CT; Gregg C Fonarow, UCLA Medical Ctr, Los Angeles, CA; Adnan Malik, WellSpan Health, York, PA; Ralph G. Brindis, Univ of California, San Francisco, San Francisco, CA; Di Lu, Duke Clinical Res Inst, Durham, NC; Smita Negi, Louisiana State Univ, Lafayette, LA; Susan Rogers, American Coll of Cardiology, Washington DC, DC; Julie Mobayed, American Coll of Cardiology, Washington, DC
103	103	Clinical Process and Outcome Improvements Based on Within Site Communication: Insights from the Patient Navigator Acute Myocardial Infarction and Heart Failure Program	Nancy M Albert , Cleveland Clinic, Cleveland, OH; Ty J Gluckman, Providence Heart and Vascular Inst, Portland, OR; Robert L McNamara, Yale Univ Sch of Med, New Haven, CT; Gregg C Fonarow, UCLA Medical Ctr, Los Angeles, CA; Adnan Malik, Wellspan Health, York, PA; Ralph G. Brindis, Univ of California, San Francisco, San Francisco, CA; Di Lu, Duke Clinical Res Inst, Durham, NC; Smita Negi, Louisiana State Univ, Lafayette, LA; Susan Rogers, American Coll of Cardiology, Washington DC, DC; Julie Mobayed, American Coll of Cardiology, Washington DC, DC

Poster Sessions (continued)

104	104	The Use of Nitrated apolipoprotein A1 (NT-ApoA1) to Predict Mortality in Patients with Known or Suspected Coronary Artery Disease	Mohammed Al-Sadawi , Alexander Parpas, Abid Ullah, Sriya Avadhani, SUNY Downstate Medical Ctr, Brooklyn, NY; Kiran Javaid, Hunter Coll of CUNY, New York, NY; Samantha Cavusoglu, Bronx High Sch of Science, Bronx, NY; Lena Woo, Univ of Chicago, Chicago, IL; Haroon Kamran, Jonathan D Marmur, Erdal Cavusoglu, SUNY Downstate Medical Ctr, Brooklyn, NY
105	105	Improving Compliance and Follow-Up for Chemotherapy-Induced Heart Failure in an Urban Underserved Tertiary Hospital	Mohammed Al-Sadawi , Kurnvir Singh, Violeta Capric, Amena Mohiuddin, Michael Haddadin, Shakil Shaikh, SUNY Downstate Medical Ctr, Brooklyn, NY; Inna Bukharovich, Kings County Hosp, Brooklyn, NY
106	106	Predicting Pulmonary Hypertension Readmission Using Machine Learning Models	Priyanka T Bhattacharya, Hosp of Univ of Pennsylvania, Univ of Pennsylvania Perelman Sch of Med, Philadelphia, PA; Shubhadeep T Bhattacharya , Johns Hopkins, Baltimore, MD; Asif A Hameed, Mercy Catholic Medical Ctr, Drexel Univ Coll of Med, Philadelphia, PA; Julio A Chirinos, Hosp of Univ of Pennsylvania, Univ of Pennsylvania Perelman Sch of Med, Philadelphia, PA; Phyllis Gimotty, Univ of Pennsylvania Perelman Sch of Med, Philadelphia, PA; Saurav Chatterjee, Hoffman Heart Inst, St Francis Hosp of the Univ of Connecticut, Hartford, CT; Jay S Giri, Steve M Kawut, Jeremy A Mazurek, Hosp of Univ of Pennsylvania, Univ of Pennsylvania Perelman Sch of Med, Philadelphia, PA
107	107	The Impact of Out-of-Hospital Cardiac Arrest Patients on Hospital Quality Reporting of Percutaneous Coronary Intervention; Can Prediction Models Do Better?	Antoinette S Birs , Dept of Internal Med, Univ of Washington, Seattle, WA; Bryn M Smith, Univ of Washington, Medical Ctr, Seattle, WA; Kate Kearney, Dept of Med, Div of Cardiology, Univ of Washington, Seattle, WA; Thomas Rea, Dept of Internal Med, Univ of Washington, Seattle, WA; Chuck Maynard, Dept of Health Services, Univ of Washington, Seattle, WA; James M McCabe, Dept of Med, Div of Cardiology, Univ of Washington, Seattle, WA
108	108	Identifying and Addressing Gaps in Utilization of Cardiac Resynchronization Therapy	wteven M Bradley , Minneapolis Heart Inst, Minneapolis, MN; Chelsey Thomas, Shaina Witt, Pam Rush, Allina Health, Minneapolis, MN; Craig E. Strauss, Peter Eckman, Minneapolis Heart Inst, Minneapolis, MN
109	109	Impact of Socio-Economic Factors on Health Care Visits Among Patients with Heart Failure	Olajide Buhari , Jacobi Medical Ctr/Albert Einstein Coll of Med, New York, NY; Adebayo Atanda, George Washington Univ Hosp, Washington DC, DC; Oluwafunmilayo Atanda, Howard Univ Hosp, Washington DC, DC; Fitsumberhan Medhane, Jacobi Medical Ctr/Albert Einstein Coll of Med, New York, NY; Talal Alzharani, Shaneke Weerakoon, Marco Mercader, Mohammed Shirazi, Nardos Temesgen, George Washington Univ Hosp, Washington DC, DC; Robert Faillace, Jacobi Medical Ctr/Albert Einstein Coll of Med, New York, NY; William Borden, Gurusher Panjraht, George Washington Univ Hosp, Washington DC, DC
110	110	Clinical Characteristics and Anticoagulant Transition Patterns of Hospitalized Patients with Venous Thromboembolism: A Retrospective Analysis Using Electronic Health Record Data	T Burton , Optum, Boston, MA; P Hlavacek, Pfizer Inc, New York, NY; J D Guo, L Rosenblatt, Bristol-Myers Squibb, Lawrenceville, NJ; J Mardekian, Pfizer Inc, New York, NY; M Ferri, Bristol-Myers Squibb, Lawrenceville, NJ; C Russ, Pfizer Inc, New York, NY; J A Kline, Indiana Univ Sch of Med, Indianapolis, IN

Poster Sessions (continued)

111	111	External Validations of Clinical Predictive Models for Patients with Sudden Cardiac Arrest	Richard T Carrick , Christine M Lundquist, Kristen Brown, Jinny G Park, Tufts Medical Ctr, Boston, MA; William A Janes III, Maine Medical Ctr, Portland, ME; David M Kent, Benjamin S Wessler, Tufts Medical Ctr, Boston, MA
112	112	WITHDRAWN	
113	113	Mitral Leaflet Clip Procedure Outcomes: Analysis from the National Cardiovascular Data Registry	Pedro Covas , Talal Alzahrani, James McCaffrey, Raza Yunus, Joseph Krepp, Ramesh Mazhari, Christian Nagy, Jonathan Reiner, The George Washington Univ, Washington, DC
114	114	Trends in Aortic Valve Interventions in The Netherlands	Edgar J Daeter , Dennis van Veghel, Saskia Houterman, Jules Olsthoorn, Mohamed A Soliman-Hamad, NHR, Utrecht, Netherlands
115	115	Gender Based Disparity in Transcatheter Aortic Valve Replacement Utilization: Insights from Nationwide Inpatient Sample 2012-2016	Garima Dahiya , Michael Nestasie, Juliette E Power, Allegheny General Hosp, Pittsburgh, PA; Kendra J Bobby, Yin Qing, Anran Liu, Univ of Pittsburgh, Graduate Sch of Public Health, Pittsburgh, PA; Aditya A Joshi, Allegheny General Hosp, Pittsburgh, PA; Jeanine Marie Buchanich, Univ of Pittsburgh, Graduate Sch of Public Health, Pittsburgh, PA; Indu G Poornima, Allegheny General Hosp, Pittsburgh, PA
116	116	Velocity Max Based Cardiovascular Exercise Prescription Leads to Higher Maximal Oxygen Consumption vs Sub Maximal Graded Exercise Test Cardiovascular Exercise Prescription	Sankalp Das , Brian Betancourt, Maribeth Rouseff, Doris Brown, Henry Guzman, Angelica Ruiz, Joseph Mora, Terry C Ochoa, Natalie D Castro, Cynthia Gilliam, Shoshana B Sheriff, Baptist Health South Florida, Miami, FL
117	117	Improving Efficiency in a Cardiac Catheterization Laboratory	Ali E Denktas , Pooja Prasad, Shannon Kenyon, Laura A Petersen, Baylor Coll of Med/MEDVAMC, Houston, TX
118	118	Impact of an Early HF Discharge Follow-up Intervention on 30-Day Outcomes in a Veterans Hospital	Sandesh Dev , Janet Fawcett, Phoenix VA Health Care System, Phoenix, AZ; Wen-Chih Wu, Providence VA Health Care System, Providence, RI; Dawn C. Schwenke, VA Northern California Health Care System, Sacramento, CA
119	119	Using the VA National Cardiac Device Surveillance Program to Monitor the Safety of Cardiovascular Implantable Electronic Devices	Sanket S Dhruva , Mary A Whooley, UCSF Sch of Med, San Francisco, CA; Minang P Turakhia, Stanford Univ Sch of Med, Stanford, CA; Merritt H Raitt, Portland Veterans Affairs Health Care System, Portland, OR; Gary Tarasovsky, San Francisco Veterans Affairs Health Care System, San Francisco, CA; Lindsey Rosman, Yale Univ Sch of Med, New Haven, CT; Michael E Matheny, Vanderbilt Univ Sch of Med, Nashville, TN
120	120	Effectiveness of a Pharmacist Population Health Intervention for Sacubitril/valsartan in Systolic Heart Failure	Michael P Dorsch , Sarah Adie, Kristen T Pogue, Sarah Hanigan, Univ of Michigan, Ann Arbor, MI; Monique Conway, Duke Univ, Durham, NC; Todd M Koelling, Univ of Michigan, Ann Arbor, MI

Poster Sessions (continued)

121	121	An Investigation of Plant-based, Mediterranean, Paleolithic, and Dash Diets Study (the VA Beach Diet Study)	Joshua Edwards , Eastern Virginia Medical Sch, Virginia Beach, VA; Deepak Talreja, Cardiovascular Associates, Virginia Beach, VA; Holly Buchanan, Univ of Virginia, Charlottesville, VA; Roshan Talreja, Private Practice, Virginia Beach, VA; Brant Thomas, Lifeway Family Physicians, Virginia Beach, VA; Hyeon Hyeon Choi, Sentara Pediatrics Physicians, Virginia Beach, VA; Jesse St Clair, Sarah Joyner, Cardiovascular Associates, Virginia Beach, VA; Sunita Dodani, Eastern Virginia Medical Sch, Norfolk, VA
122	122	Presentations Management and Outcomes of Arab-American Patients Hospitalized with Heart Failure Compared with Age and Gender Matched White American Patients	Ammar ELJack , Ruaa Elteriefi, Beaumont Health System, Dearborn, MI
123	123	Race, Ethnicity, and Sex-Related Differences in Anticoagulation in Patients Newly Diagnosed with Atrial Fibrillation	Utibe R Essien , Jared W Magnani, Walid F Gellad, Univ of Pittsburgh Sch of Med, Pittsburgh, PA; Michael J Fine, VA Pittsburgh Healthcare System, Pittsburgh, PA; Inmaculada Hernandez, Univ of Pittsburgh Graduate Sch of Public Health, Pittsburgh, PA
124	124	Abdominal Aortic Aneurysm Screening in Symptomatic Peripheral Artery Disease: Insights from the PORTRAIT Registry	Awais Farooq , Kim Smolderen, Saint Luke's Mid America Heart Inst, Kansas City, MO
125	125	Predictors of Positive Radionuclide Myocardial Perfusion Imaging Within 2-Years of a Normal Study: Results From The Veterans Health Administration	Marcelo Fernandes , Manuel Rivera, Salih Grevious, Louis Vincent, Stephanie Clauss, Univ of Miami Miller Sch of Med, Miami, FL; George Marzouka, Simon Chakko, Miami VA Medical Ctr, Miami, FL
126	126	Putting Into Practice: American Heart Association 2017 Standards for Hospital Electrocardiographic Monitoring and Inappropriate Telemetry Use	Raul Angel Garcia , Delyse Garg, Rosemarie Nielson, Dennis Lourdusamy, Rahul Vasudev, Raja Pullatt, Rutgers NJMS Trinitas Regional Medical Ctr, Elizabeth, NJ
127	127	The Impact of Health System Organization on Quality Performance	Lauren Gray Gilstrap , Dartmouth Hitchcock Medical Ctr; The Dartmouth Inst at Dartmouth Medical Sch, Lebanon, NH; Nancy Beaulieu, Mary Beth Ladrum, Michael McWilliams, Michael Chernew, Harvard Medical Sch, Boston, MA; Maurice Dalton, Angela Gu, Michael Briskin, Natl Bureau of Economic Res, Boston, MA; Lin Ding, Harvard Medical Sch, Boston, MA; David Cutler, Harvard Univ, Dept of Economics, Cambridge, MA
128	128	The Impact of Hospital Acquisition by a Health System on Admission Allocation	Lauren Gray Gilstrap , Dartmouth Hitchcock Medical Ctr; The Dartmouth Inst at Dartmouth Medical Sch, Lebanon, NH; Nancy Beaulieu, Peter Lyu, Harvard Medical Sch, Boston, MA; David Cutler, Harvard Univ, Dept of Economics, Boston, MA
129	129	Implications of Incorrect Documentation and Coding of Troponin Elevation	Lakshmi Gopalakrishnan , Varun Kumar, Sandeep Khosla, Sinai Health System, Chicago, IL

Poster Sessions (continued)

130	130	Social Factors Influence Readmission Rates in Women with Acute Myocardial Infarction	Faris I Haddadin , Wojciech Rzechorzek, Basera Sabharwal, Bing Yue, Mariam Khandaker, David Weininger, Ricardo De La Villa Pagán, Alba Munoz Estrella, Shawn Lee, Mount Sinai St Luke's-West, New York, NY; Syed Ahsan, Westchester Medical Ctr, Valhalla, NY; Alejandro Lemor, Henry Ford Hosp, Detroit, MI; Allison Selby, Jacqueline Tamis-Holland, Mount Sinai St Luke's-West, New York, NY
131	131	The Effect of Atrial Fibrillation on the Outcomes and Prognosis of Pulmonary Embolism, a Report From the National Inpatient Sample of 2016	Faris I Haddadin , Mount Sinai St Luke's-West, New York, NY; Sadam Haddadin, St. Agnes Hosp, Baltimore, MD; Alba Munoz Estrella, Dhruvajyoti Bandyopadhyay, Mount Sinai St Luke's-West, New York, NY; Suhail I Haddadin, Hashemite Univ, Az'zarqa, Jordan; Hassan Beidoun, Mount Sinai St Luke's-West, New York, NY
132	132	Integrated Risk Factor Management in Patients with Coronary Artery Disease: Insights from the Angina Prevalence and Provider Evaluation of Angina Relief Study	Vittal Hejjaji , Univ of Missouri Kansas City, Kansas City, MO; Kensey Gosch, Tracie Breeding, Philip G Jones, Saint Luke's Health System of Kansas City, Kansas City, MO; John A Spertus, Suzanne V Arnold, Univ of Missouri Kansas City, Kansas City, MO
133	133	Early Impact of Systematizing the Evaluation of Patients with Heart Failure Presenting to the Emergency Department	Vittal Hejjaji , Univ of Missouri Kansas City, Kansas City, MO; Allison M Scholes, Saint Luke's Health System of Kansas City, Kansas City, MO; Yevgeniy Khariton, Univ of Missouri Kansas City, Kansas City, MO; Kevin Kennedy, Evelyn Dean, Joseph Barrios, Saint Luke's Health System of Kansas City, Kansas City, MO; John A Spertus, Univ of Missouri Kansas City, Kansas City, MO
134	134	Can Coronary Calcification Scores Be Approximated by Routine Clinical CT?	Steven R Horbal , Edward Brown, Brian E. Ross, Sven A. Holcombe, Nicholas Wang, June A. Sullivan, Morphomics Analysis Group at the Univ of Michigan, Ann Arbor, MI; Aurelian Bidulescu, Indiana Univ Sch of Public Health, Bloomington, IN; Stewart C. Wang, Dept of Surgery, Univ of Michigan, Ann Arbor, MI
135	135	Urban-Rural Differences in Coronary Heart Disease Mortality in the United States in 2010-2015	Avinainder Singh, Nona M Jiang , Yale New Haven Hosp, New Haven, CT; Michael Blaha, Johns Hopkins Hosp, Baltimore, MD; Ron Blankstein, Brigham and Women's Hosp, Boston, MA; Khurram Nasir, Yale New Haven Hosp, New Haven, CT
136	136	Enrollment of Black Individuals in Cardiovascular Clinical Trials: A Meta-Analysis	Terrell Jones , Deng Madut, Larry Jackson, Duke Sch of Med, Durham, NC; Cynthia L Green, Duke Clinical Res Inst, Durham, NC; Kevin Thomas, Duke Sch of Med, Durham, NC
137	137	Using an Electronic Clinical Support Tool to Improve Anticoagulation in Patients with Atrial Fibrillation/Flutter	June Kampangkaew , Nathan Nowalk, Ihab Hamzeh, Baylor Coll of Med, Houston, TX
138	138	Effectiveness and Safety of Apixaban Compared to Warfarin among Venous Thromboembolism Patients in the United States Medicare Population	Patrick Hlavacek, Pfizer Inc., New York, NY; Jennifer D Guo , Lisa Rosenblatt, Bristol-Myers Squibb Company, Lawrenceville, NJ; Allison Keshishian, STATinMED Res, Ann Arbor, MI; Cristina Russ, Jack Mardekian, Pfizer Inc., New York, NY; Mauricio Ferri, Tayla Poretta, Bristol-Myers Squibb Company, Lawrenceville, NJ; Huseyin Yuce, New York City Coll of Technology, City Univ of New York, New York, NY; Robert McBane, Mayo Clinic, Rochester, MN

POSTERS

Poster Sessions (continued)

139	139	Adherence and Persistence to Direct Oral Anticoagulants for the Treatment of Cancer-Associated Venous Thromboembolism	Jordan B King , Univ of Utah, Salt Lake City, UT; Malti Charlu, Shiyun Zhu, Kaiser Permanente Northern California, Oakland, CA; Thomas Delate, Kaiser Permanente Colorado, Aurora, CO
140	140	Predictors of Patient Self-Advocacy (PSA) in Heart Failure (HF)	Carolyn Kleman , Univ of North Carolina Wilmington, Wilmington, NC
141	141	Using Geographic Information Systems (GIS) to Analyze Statewide Regional Data - A Feasibility Project from the Kentucky Stroke Encounter Quality Improvement Project (SEQIP)	Kari Moore, Dept of Neurology, Univ of Louisville, Louisville, KY; Allison Merritt, Bonita Bobo, Kentucky Dept for Public Health, Kentucky Heart Disease and Prevention Program, Frankfort, KY; Amy Graham, American Heart Association, Louisville, KY; Alexander Kuhn , American Heart Association, Columbus, OH; Kentucky Stroke Encounter Quality Improvement Project (SEQIP)
142	142	Feel the Burn, PCI Advances Increase Radiation Exposure of Patients	William E Lawson , Kathie Gulino, Lisa Wilbert, Osman Jaffer, Michael Bonvento, Puja Parikh, Robert Pyo, Suny Stony Brook, Stony Brook, NY
143	143	Spoke and Hub or Moat and Castle, Evolving Referral Patterns	William E Lawson , Lisa Wilbert, Suny Stony Brook, Stony Brook, NY; Mary Maliszewski, Brookhaven Memorial Hosp, Patchogue, NY; Eric Niegelberg, Ahmed Seliem, On Chen, Robert Pyo, Suny Stony Brook, Stony Brook, NY
144	144	Quality Assurance Measurement of St Jude/Abbott Tendril Pacemaker Leads in Veterans	Samuel Lee , Washington DC VAMC, Washington, DC; Kiran Kanjerla, George Washington Sch of Med, Washington, DC; Pamela Steele, Hsincheng Lo, Washington DC VAMC, Washington, DC; Merritt Raitt, Portland VAMC, Portland, OR; Ross Fletcher, Hans Moore, Washington DC VAMC, Washington, DC
145	145	Not One Decision, but Many: Results of an Interview Study Investigating the Decision-Making Experience of Left Ventricular Assist Device Patients and Their Caregivers	Lisa Carey Lohmueller , Luke M Breitfeller, Carnegie Mellon Univ, Pittsburgh, PA; Manreet K Kanwar, Allegheny General Hosp, Pittsburgh, PA; Carolyn P Rose, Carnegie Mellon Univ, Pittsburgh, PA
146	146	Evolving Clinical Benefits and Social Value of Lipid Lowering Therapies	Joanna P MacEwan , Lauren M Zhao, Katie Everson, Precision Health Economics, Los Angeles, CA; Larry Liu, Sun Fang, Merck & Co., Kenilworth, NJ; Darius N Lakdawalla, Univ of Southern California, Los Angeles, CA
147	147	The Trend of In-hospital Complications During Acute Ischemic Stroke Hospitalization Among US Elderly	Shumei Man , Neurological Inst, Cleveland Clinic, Rocky River, OH; Jesse D. Schold, Dept of Quantitative Health Sciences, Cleveland Clinic, Cleveland, OH; Ken Uchino, Cerebrovascular Ctr, Cleveland Clinic, Cleveland, OH
148	148	Differences Between Participants and Nonparticipants in a Survey of Community Patients with Heart Failure	Irmak Simsek, Sheila Manemann , Kathleen Yost, Alanna Chamberlain, Matteo Fabbri, Ruoxiang Jiang, Susan Weston, Veronique L Roger, Mayo Clinic, Rochester, MN
149	149	Identifying the Psychosocial Needs of New Stroke Patients: A Retrospective Chart Review of Stroke Patients with Previous Psychiatric Diagnosis	Lina Mayorga , Alisa Rock, Methodist Hosp of Southern Cali, Arcadia, CA

Poster Sessions (continued)

150	150	Early Administration of Ticagrelor in Patients with Non-ST Segment Elevation Myocardial Infarction is Associated with Improved Survival	Steven Mazzone , Rhys FM Chua, Stephanie A Besser, Sandeep Nathan, Atman P Shah, James K Liao, Corey E Tabit, Univ of Chicago Hosp, Chicago, IL
151	152	Therapeutic Intensity in Medically Managed Incident Heart Failure Patients with and without Mitral Regurgitation: A Claims Based Analysis	Peter A McCullough, Baylor Univ Medical Ctr, Baylor Heart and Vascular Inst, Dallas, TX; David P Cork, Hirsch S. Mehta, San Diego Cardiac Ctr, San Diego, CA; Colin M Barker, Houston Methodist Hosp, Houston, TX; Candace Gunnarsson, Michael Ryan, CTI Clinical Trial & Consulting Services, Covington, KY; Sarah Mollenkopf, Joanna Van Houten , Patrick Verta, Edwards Lifesciences, Irvine, CA
153	153	Predictors of Aspirin Nonadherence in Adults with Prior Myocardial Infarction	Aayushi A Mehta , Puja B Parikh, Stony Brook Univ Medical Ctr, Stony Brook, NY
154	154	True Outcome Determination After In-Hospital Cardiac Arrest	Art Miller , American Heart Assn, Chicago, IL; Kathie Thomas, American Heart Assn, Grand Rapids, MI; Gary Myers, American Heart Assn, Sioux Falls, SD
155	155	Undergraduate Student Nurse ACLS Certification to Improve Practice Transition and Confidence	Catherine Miller , Univ of Indianapolis, Indianapolis, IN
156	156	Cost-Effectiveness Analysis of the Sentinel Cerebral Embolic Protection Device During Transcatheter Aortic Valve Replacement	Bart S Ferket, Jacob R. Morey , Annetine C. Gelijns, Alan J. Moskowitz, Gennaro Giustino, Icahn Sch of Med Mt Sinai, New York, NY
157	157	Assessment of Financial Hardship From Medical Bills Across the Spectrum of Diabetes Mellitus and Atherosclerotic Cardiovascular Disease Among Non-Elderly Adults in the United States	Reed Mszar , Yale Sch of Public Health, New Haven, CT; Gowtham R Grandhi, Javier Valero-Elizondo, Ctr for Outcomes Res and Evaluation, Yale New Haven Hosp, New Haven, CT; Rohan Khara, Univ of Texas Southwestern Medical Ctr, Dallas, TX; Nihar Desai, Yale Sch of Med, New Haven, CT; Salim Virani, Baylor Coll of Med, Houston, TX; Ron Blankstein, Brigham and Women's Hosp, Boston, MA; Michael Blaha, Johns Hopkins Sch of Med, Baltimore, MD; Khurram Nasir, Ctr for Outcomes Res and Evaluation, Yale New Haven Hosp, New Haven, CT
158	158	A Learning Health System Approach to Reduce Time to Treatment for Out of Hospital Cardiac Arrest	Emilee Coulter-Thompson, Univ of Michigan Medical Sch, Ann Arbor, MI; Robert Neumar, Charles Friedman, Theresa Shields, Jodyn Platt, Kate Satterfield, Brahmajee Nallamothe , Univ of Michigan, Ann Arbor, MI
159	159	Did the Hospital Readmission Reduction Program Result in Delayed Readmissions Just After 30 days?	Ashwin S Nathan , Joseph Martinez, Jay Giri, Amol Navathe, Univ of Pennsylvania, Philadelphia, PA
160	160	Comparison of Baseline Characteristics Among World Health Organization Groups in Pulmonary Hypertension	Julian M Neshewat , Spencer Morgan, David Weinstein, Amanda Wasserman, Susanne McDevitt, Eva Kline-Rogers, Vallerie McLaughlin, Thomas Cascino, Univ of Michigan Health System, Ann Arbor, MI
161	161	Adding Social and Functional Determinants of Health Improves Readmission Risk Prediction in Urban Underserved Adults Hospitalized for Acute Myocardial Infarction	Oanh Nguyen , Anil N Makam, Univ of California, San Francisco, San Francisco, CA; Christopher R Clark, Parkland Health & Hosp System, Dallas, TX; Sandeep R Das, Ethan A Halm, UT Southwestern Medical Ctr, Dallas, TX

Poster Sessions (continued)

162	162	Defining 'No Significant Change': Standard Error of Standard Echocardiogram Measurements	David Ouyang , Amirata Ghorbani, Cindy Wang, Alberta Yen, Francois Haddad, James Zou, Euan Ashley, David Liang, Stanford, Menlo Park, CA
163	163	Economy of Handheld Ultrasound in an Outreach Clinic Setting	Nidhi Patel , Aarti Patel, Univ of South Florida Morsani Sch of Med, Tampa, FL
164	164	Neighborhood Socioeconomic Status is Significantly Associated with Outcomes After Coronary Artery Bypass Grafting	William L Patrick , Div of Cardiovascular Surgery, Univ of Pennsylvania, Philadelphia, PA; Markian M Bojko, Drexel Univ Coll of Med, Philadelphia, PA; Jason J Han, Amit Iyengar, Mark Helmers, Matthew L Williams, Div of Cardiovascular Surgery, Univ of Pennsylvania, Philadelphia, PA
165	165	Challenges to Self-Management of Heart Failure Among Homeless Individuals: A Qualitative Study	Akshay Pendyal , Marjorie S Rosenthal, Yale Sch of Med, New Haven, CT; Danya Keene, Yale Sch of Public Health, New Haven, CT
166	166	Blood Pressure Variability and Cardiovascular Outcomes in Heart Failure with Preserved Ejection Fraction	Poghni Allen Peri-Okonny , Vittal Hejjaji, Ali Malik, Saint Luke's Mid America Heart Inst, Kansas City, MO; Krishna K Patel, Saint Luke's Mid America Heart Inst, Kansas city, MO; Yevgeniy Khariton, Yuanyuan Tang, John Spertus, Saint Luke's Mid America Heart Inst, Kansas City, MO
167	167	Pragmatic Electronic Medical Records Registry Utilization to Identify Care-Gaps and Improve Cardiovascular Health of Cancer Patients and Cancer Survivors	Steven Philips , Vlad Zaha, Duwayne Willett, Mujeeb Basit, UTSW, Dallas, TX
168	168	A Real-World Claims Analysis of Costs Among Patients With Type 2 Diabetes Mellitus and Cardiovascular Disease Receiving Empagliflozin or Other Antihyperglycemic Agents	Aditya Raju, Xcenda, LLC, Palm Harbor, FL; Pratik Pimple , Boehringer Ingelheim Pharmaceuticals, Ridgefield, CT; Dana Stafkey-Mailey, Eileen Farrelly, Xcenda, LLC, Palm Harbor, FL; Sharash Shetty, Boehringer Ingelheim Pharmaceuticals, Ridgefield, CT
169	169	A Retrospective Cardiovascular Disease Registry to Inform Community Prevention	Irion W Pursell Jr , Jessica Ford, Elizabeth Lee, Lauren Moore, Yuxuan Mao, Ty Washington, Sam Sears, Paul Mounsey, East Carolina Univ, Greenville, NC
170	170	Worse Patency in Women After Endovascular Peripheral Vascular Intervention	Niveditta Ramkumar , The Dartmouth Inst, Lebanon, NH; Bjoern D Suckow, Dartmouth-Hitchcock Medical Ctr, Lebanon, NH; Todd A Mackenzie, The Dartmouth Inst, Lebanon, NH; Art Sedrakyan, Weil Cornell Medical Coll, New York, NY; Jeremiah R Brown, The Dartmouth Inst, Lebanon, NH; Philip P Goodney, Dartmouth-Hitchcock Medical Ctr, Lebanon, NH
171	171	User Beware: Understanding the Adjusted Estimates of Propensity Score Methods	Niveditta Ramkumar , The Dartmouth Inst, Lebanon, NH; Alexander Iribarne, Dartmouth-Hitchcock Medical Ctr, Lebanon, NH; Elaine M Olmstead, The Dartmouth Inst, Lebanon, NH; Anthony DiScipio, David J Malenka, Dartmouth-Hitchcock Medical Ctr, Lebanon, NH; Todd A Mackenzie, The Dartmouth Inst, Lebanon, NH
172	172	Improving Heart Failure Outcome, a Team Based Approach	Mohsen Saadat, Mariam Mostamand , San Joaquin General Hosp, French Camp, CA

Poster Sessions (continued)

173	173	Predictors of Medication Noncompliance in Patients with an Acute Myocardial Infarction	Basera Sabharwal , Faris Haddadin, Wojciech Rzechorzek, Mariam Khandaker, David Weinger, Bing Yue, Ricardo De La Villa, Shawn Lee, Icahn Sch of Med at Mount Sinai St Luke's and Mount Sinai West, New York, NY; Syed Ahsan, Westchester Medical Ctr, New York, NY; Alejandro Lemor, Henry Ford Hosp, Detroit, MI; Allison Selby, Jacqueline Tamis-Holland, Icahn Sch of Med at Mount Sinai St Luke's and Mount Sinai West, New York, NY
174	174	Healthcare Provider Compliance with the 2013 ACC/AHA Blood Cholesterol Guidelines for Statin Therapy for Diabetic Patients of Ages 40 to 75	Ahmed Saleh , Sarju Ganatra, Sherif Labib, Lahey Hosp and Medical Ctr, Burlington, MA
175	175	Relationship Between Hospital Cost and Quality Measures for Acute Myocardial Infarction and Heart Failure Admissions	Alexander T Sandhu , Stanford Univ, Stanford, CA; Rose Do, Univ of California, Irvine, Irvine, CA; Paul A Heidenreich, Stanford Univ, Stanford, CA
176	176	Association Between Hospital-Level Cost of Cardiovascular Care and Socioeconomic Characteristics	Alexander T Sandhu , Stanford Univ, Stanford, CA; Rose Do, Univ of California, Irvine, Irvine, CA; Paul A Heidenreich, Stanford Univ, Stanford, CA
177	177	The Burden of Sternal Wound Infections Following Coronary Artery Bypass Graft Surgery in Medicare Patients	Rhodri Saunders, Maximilian Blüher, Coreva Scientific, Königswinter, Germany; Julie Lankiewicz , Cardinal Health, Mansfield, MA
178	178	Predicting Employee Health and Cost: Application of Machine Learning on Employee Health Claims Data, Insights, and Possibilities	Anshul Saxena , Sankalp Das, Muni Rubens, Joseph Salami, Chintan Bhatt, Tian Tian, Peter McGranaghan, Louis Gidel, Emir Veledar, Baptist Health South Florida, Coral Gables, FL
179	179	Cardiac Resynchronization Therapy among Cancer Patients in the United States: Results from National Inpatient Sample	Anshul Saxena , Muni Rubens, Sankalp Das, Chintan Bhatt, Baptist Health South Florida, Coral Gables, FL; Venkataraghavan Ramamoorthy, Univ of Central Missouri, Warrensburg, MO; Ludimila Cavalcante, Emir Veledar, Baptist Health South Florida, Coral Gables, FL
180	180	Association of Risk Factor-Based Educational Programs on Stroke Hospitalization and Death Rates in West Central Florida	Megan Sheeran , Joel A Strom, Susan LeFrancois, Florida Polytechnic Univ, Lakeland, FL
181	181	Application of the 2018 Cholesterol Guideline for Secondary Prevention in Very High-risk Patients with Atherosclerotic Cardiovascular Disease in the United States	Doosup Shin , Chandrashekar Bohra, Kullatham Kongpakpaisarn, Univ of South Florida, Tampa, FL

Poster Sessions (continued)

182	182	Adverse Pregnancy Outcomes and Cardiovascular Disease in the Mother: The Women's Health Initiative (WHI)	Marc Meller Sondergaard , Mark Hlatky, Marcia L Stefanick, Stanford Univ, Stanford, CA; Eric Vittinghoff, Gregory Nah, UCSF, San Francisco, CA; Barbara Howard, MedStar Health Res Inst, Hyattsville, MD; Matthew Allison, Aladdin H Shadyab, UCSD, San Diego, CA; Linda Van Horn, Northwestern Univ, Evanston, IL; Alison Gemmill, Stony Brook Univ, Stony Brook, NY; Ki Park, UF, Gainesville, FL; Elena Salmoirago-Blotcher, Brown Univ, Providence, RI; JoAnn E Manson, Harvard Univ, Boston, MA; Shawnita Sealy-Jefferson, The Ohio State Univ, Columbus, OH; Carolina Valdiviezo, MedStar Health, Washington, DC; Maryam Sattari, UF, Gainesville, FL; Nisha I Parikh, UCSF, San Francisco, CA
183	183	Predictors of Good Functional Outcome at Discharge in Stroke Patients with Depression in the Florida Puerto Rico Collaboration to Reduce Stroke Disparities (FL-PR CReSD) Study	Amy K Starosciak , Baptist Health Neuroscience Ctr, Miami, FL; Samantha Spring, Univ of Miami Miller Sch of Med, Miami, FL; Juan Zevallos, Florida Intl Univ Herbert Wertheim Coll of Med, Miami, FL; Kefeng Wang, Carolina M. Gutierrez, Chuanhui Dong, Jose G. Romano, Ralph L Sacco, Tatjana Rundek, Univ of Miami Miller Sch of Med, Miami, FL
184	184	"I'm Gonna Have the Baby and It's Gonna Go Away:" Communicating Cardiovascular Risk After a Pregnancy Complicated by Preeclampsia	Natalie Stokes , Katy Mahraj, Lisa Levine, Jennifer Lewey, Hosp of the Univ of Penn, Philadelphia, PA
185	185	The Expanded Benefit of Nephrylsin Inhibitor Therapy on 30 Day Readmissions: A Useful Tool at a Safety Net Hospital	Nicholas Taklalsingh , Perry Wengrofsky, SUNY Downstate Medical Ctr, Brooklyn, NY; Howard Levitt, Kings County Hosp Ctr, Brooklyn, NY
186	186	Securing Cardiology Follow Up Appointments Through Sustained Utilization of Electronic Medical Record-Based Order	Kartik Telukuntla , Tim Sobol, Mouin Abdallah, Michael Hulseman, Benico Barzilai, Randall Starling, John Stephens, Umesh Khot, Cleveland Clinic Fndn, Cleveland, OH
187	187	Baseline 7 Day Follow Up Rates in Cardiology Patients: Impact of Electronic Medical Record-Based Appointment Order	Kartik Telukuntla , Tim Sobol, Mouin Abdallah, Michael Hulseman, Benico Barzilai, Randall Starling, John Stephens, Umesh Khot, Cleveland Clinic Fndn, Cleveland, OH
188	188	Burden of Complications After Thoracic Aortic Repair Surgery Among Medicare Beneficiaries	Michael P Thompson , Karen M Kim, Lourdes Cabrera, Xiaoting Wu, Min Zhang, Alexander A Brescia, Bo Yang, Shinichi Fukuhara, Himanshu J Patel, G Michael Deeb, Donald S Likosky, Univ of Michigan, Ann Arbor, MI
189	189	Why Digital Health Trials Can Fail: Lessons Learned from the SmartGUIDE Randomized Trial of Virtual Cardiac Rehabilitation	Christoph Olivier, Stephanie Middleton, Natasha Purington, Sumana Shashidhar MS, Kenneth W Mahaffey, Mintu Turakhia , Stanford Univ, Palo Alto, CA
190	190	A Systematic Alarm Management Pilot to Reduce Alarm Fatigue at a Tertiary Care Center	Ramkumar V Venkateswaran , Kevin Kreitzman, Michael Fraai, Elizabeth Brosseau, Lisa Preston, Benjamin M Scirica, Brigham and Women's Hosp, Boston, MA
191	191	BRAVE: Blood Pressure and Vascular Health Around Menopause	Muhammad Ahmer Wali , RI -McGill Univ Health Ctr, Montreal, QC, Canada; Valeria Raparelli, Sapienza - Univ of Rome, Experimental Med Dept, Rome, Italy; Louise Pilote, RI -McGill Univ Health Ctr, Montreal, QC, Canada

Poster Sessions (continued)

192	192	Disparities and Impact of Medicaid Expansion on Left Ventricular Assist Device Implantation and Outcomes	Xiaowen Wang , Alina A Luke, Justin M Vader, Thomas M. Maddox, Karen E Joynt Maddox, Washington Univ, Saint Louis, MO
193	193	Who Group III Pulmonary Hypertension Patients With Lower Socioeconomic Status Are Diagnosed at a Younger Age	Amanda Wasserman , Spencer Morgan, David Weinstein, Julian Neshewat, Susanne McDevitt, Eva Kline-Rogers, Thomas Cascino, Vallerie McLaughlin, Univ of Michigan Health System, Ann Arbor, MI
194	194	The Effect of Obstructive Sleep Apnea on the Outcomes of Patients with Supraventricular Tachycardia	David Weininger , Roberto C Ochoa, Mario Rodriguez, Saman Setareh-Shenas, Ricardo De La Villa, Alexander Manguba, Wojciech Rzechorzek, Mount Sinai St. Luke's Hosp, New York, NY
195	195	External Validations of Clinical Prediction Models for Cardiovascular Disease: A Field Synopsis	Benjamin S Wessler , Christine Lundquist, Kristen D Brown, Harshita Beeravolu, Asha Ayub, Elizabeth Berggren, Leigh Kowalski, Andrew Brown, Tatum Williamson, Jennifer Lutz, Jessica Paulus, David M Kent, Tufts Medical Ctr, Boston, MA
196	196	Omission of Heart Transplant Recipients from the Appropriate Use Criteria for Revascularization and Impact on High-Volume Heart Transplant Centers	Joe Xie , Emory Univ, Atlanta, GA; Jon Kobashigawa, Cedars-Sinai Medical Ctr, Los Angeles, CA; Kevin Kennedy, St. Luke's Health System, Kansas City, MO; Timothy Henry, Steven Tabak, Cedars-Sinai Medical Ctr, Los Angeles, CA; Robert Krebs, Anthem, Richmond, VA; Leslee Shaw, Cornell, New York, NY; J Dawn Abbott, Brown Univ, Providence, RI; Wendy Book, S Tanveer Rab, Emory Univ, Atlanta, GA; John Spertus, St. Luke's Health System, Kansas City, MO; Abhinav Goyal, Emory Univ, Atlanta, GA
197	197	Predictors of Early Left Ventricular Ejection Fraction Recovery in Patients Following Transcatheter Aortic Valve Replacement	Raza Yunus , Talal Alzahrani, James McCaffery, Haneen Ismail, Jannet Lewis, Allen Solomon, Brian Choi, Joseph Krepp, Christian Nagy MD, Andrew Choi, Jonathan Reiner, George Washington Univ, Washington, DC
198	198	Lifetime Clinical Benefit of Folic Acid Therapy for Primary Prevention of Stroke in Patients with Hypertension - Projection Based on the CSPPT	Zugui Zhang , Christiana Care Health System, Newark, DE; TianTian Zhang, Coll of Pharmacy, Jinan Univ, Guangzhou, China; Tengfei Lin, Beijing Advanced Innovation Ctr for Food Nutrition and Human Health, Coll of Food Science and Nutritional Engineering, China Agricultural Univ, Beijing, China; Yang Wang, Dept of Epidemiology, Fielding Sch of Public Health, Univ of California Los Angeles, Los Angeles, CA; Binyan Wang, Xianhui Qin, Natl Clinical Res Study Ctr for Kidney Disease; the State Key Lab for Organ Failure Res; Renal Div, Nanfang Hosp, Southern Medical Univ, Guangzhou, China; Feng Xie, Dept of Clinical Epidemiology and Biostatistics, McMaster Univ, Hamilton, ON, Canada; Yong Huo, Dept of Cardiology, Peking Univ First Hosp, Beijing, China; Xiaobin Wang, Dept of Population, Family and Reproductive Health, Johns Hopkins Univ Bloomberg Sch of Public Health, Baltimore, MD; Jie Jiang, Coll of Pharmacy, Jinan Univ, Guangzhou, China

Poster Sessions (continued)

199	199	The Clinical Outcome and Economic Impact of the 2017 ACC/AHA Guidelines on Hypertension in China	Zengwu Wang, Xin Wang, Hao Guang, Zuo Chen, Linfeng Zhang, Div of Prevention and Community Health, Natl Ctr for Cardiovascular Disease, Fuwai Hosp, Peking Union Medical Coll & Chinese Acad of Medical Sciences, Beijing, China; Zugui Zhang , Christiana Care Health System, Newark, DE; Ying Dong, Congyi Zheng, Yuting Kang, Div of Prevention and Community Health, Natl Ctr for Cardiovascular Disease, Fuwai Hosp, Peking Union Medical Coll & Chinese Acad of Medical Sciences, Beijing, China; Hao Hu, China Health Technology Assessment Ctr, Natl Health Development Res Ctr, Natl Health and Family Planning Commission, Beijing, China; William S Weintraub, MedStar Washington Hosp Ctr, Washington DC, DC; Runlin Gao, Dept of Cardiology, Fuwai Hosp, Peking Union Medical Coll & Chinese Acad of Medical Sciences, Beijing, China
		Is Our Initial Evaluation of Patients Admitted for Syncope Guideline-directed and Cost-effective?	Muhammad Hamza Saad Shaukat , Muhammad Asim Shabbir, James Desemone, Radmila Lyubarova, Albany Medical Ctr, Albany, NY
199.1	199.1	Incidence and Outcomes of Acute Kidney Injury Requiring Renal Replacement Therapy in Patients on Percutaneous Mechanical Circulatory Support with Impella CP for Cardiogenic Shock; a Single Center Experience	Muhammad Hamza Saad Shaukat , Fadi Fahad, Neil Yager, Albany Medical Ctr, Albany, NY

APS.02. Poster Session PM
Saturday, April 6, 2019, 2:00-5:00 PM
Grand Ballroom
Poster Presenter Available: 2:30-4:00 PM

Presentation Number	Poster Board Number	Title	Author Block
201	201	Evaluating Time from Electrocardiogram (ECG) Acquisition to ST-Elevation Myocardial Infarction (STEMI) Activation for Inpatients: Deployment of a Preliminary Automated ECG Reading System	Michael Ahlers , Vanderbilt Univ Sch of Med, Nashville, TN; Jared O'Leary, Stephen Zbydniewski, Barbara Jenkins, Holly Hamm, Marvin W Kronenberg, Daniel Muñoz, Vanderbilt Univ Medical Ctr, Vanderbilt Heart and Vascular Inst, Nashville, TN
202	202	Digoxin Does not Decrease Readmission Rate in Patients Hospitalized with Acute Heart Failure and Reduced Ejection Fraction	Rabah Alreshq , Mikhail Torosoff, Albany Medical Ctr, Albany, NY
203	203	Radial versus Femoral Approach for Percutaneous Coronary Intervention in Patients with Cardiogenic Shock: A Systematic Review and Meta-analysis	Rabah Alreshq , Neil Yager, Albany Medical Ctr, Albany, NY

POSTERS

Poster Sessions (continued)

204	204	Comparison of Hemodynamic Parameters and Clinical Outcomes in Jehovah's Witness Patients versus Non-Jehovah's Witness Patients Undergoing Transcatheter Aortic Valve Replacement	Francisco J Alvarado , USF Internal Med Residency, Tampa, FL; Jaymin Patel, USF Cardiology, Tampa, FL; Ajay Bhandari, USF Internal Med Residency, Tampa, FL; Anita Radhakrishnan, USF Cardiology, Tampa, FL; Christopher Bitetzakis, USF Internal Med Residency, Tampa, FL; Edin Sadic, USF Internal Med Residency, TAMPA, FL; Igor Sunjic, Thomas Kasproicz, Vishal Parikh, USF Cardiology, Tampa, FL; Andrew Mehlman, Paula Hernandez Burgos, USF Internal Med Residency, Tampa, FL; Arthur Labovitz, Allan Chen, Aarti Patel, USF Cardiology, Tampa, FL
205	205	A Systematic Review of Cardiac Rehabilitation Participation: Barriers and Facilitators	Melissa Amraotkar , Univ of Louisville, Louisville, KY
206	206	Coronary Artery Bypass Graft - Postoperative Atrial Fibrillation: Does Statin Type or Dose Matter?	Sudeep Raj Aryal , Rajat Dhungana, Univ of Alabama, Birmingham, Birmingham, AL; Nicole Cournoyer, Eastern Maine Medical Ctr, Bangor, ME; Gail Tudor, Husson Univ, Bangor, ME; Nina Vekima, Anna Boyle, David Carmack, Barbara Sorondo, Eastern Maine Medical Ctr, Bangor, ME
207	207	VITAL-AF: A Pragmatic Trial Integrating Routine Screening for Atrial Fibrillation During Primary Care Visits	Jeffrey M Ashburner , Steven J Atlas, Massachusetts General Hosp, Boston, MA; David D McManus, Univ of Massachusetts Medical Sch, Worcester, MA; Yuchiao Chang, Ana T Trisini Lipsanopoulos, Leila H Borowsky, Wyliena Guan, Wei He, Patrick T Ellinor, Daniel E Singer, Steven A Lubitz, Massachusetts General Hosp, Boston, MA
208	208	Improvement in Prediction of Readmission after CABG with Cause-Specific Readmission Models	Roland Assi , Jill Shnall, Jinbo Chen, Matthew Williams, Univ of Pennsylvania, Philadelphia, PA
209	209	Sex Differences in Characteristics, Symptoms, and Management of Geriatric Patients with Atrial Fibrillation: Insights from the SAGE-AF Study	Hamza H Awad , Mercer Univ Sch of Med, Macon, GA; Darleen Lessard, Univ of Massachusetts Medical Sch, Worcester, MA; David Parish, Mercer Univ Sch of Med, Macon, GA; Navdeep Dhillon, Univ of Massachusetts Medical Sch, Worcester, MA; Molly E Waring, Univ of Connecticut Coll of Agriculture, Health, and Natural Resources, Storrs, CT; Robert J Goldberg, Univ of Massachusetts Medical Sch, Worcester, MA; Felix O Sogade, Georgia Arrhythmia Consultants & Res Inst, Macon, GA; Jane Saczynski, Northeastern Univ, Boston, MA; David D McManus, Univ of Massachusetts Medical Sch, Worcester, MA
210	210	Rates of Drug Switching and Discontinuation among Nonvalvular Atrial Fibrillation Elderly Patients Treated with Direct Oral Anticoagulants in the US	Christine L Baker , Pfizer, Inc., New York City, NY; Amol D Dhamane, Jigar Rajpura, Bristol-Myers Squibb, Lawrenceville, NJ; Jack Mardekian, Oluwaseyi Dina, Cristina Russ, Pfizer, Inc., New York City, NY; Lisa Rosenblatt, Bristol-Myers Squibb, Lawrenceville, NJ; Melissa Lingohr-Smith, Jay Lin, Novosys Health, Green Brook, NJ
211	211	Reduction in Laboratory Associated Cost Through Education Based Gatekeeping	Abdul Basit , Hyma Polimera, Simranjit Bedi, Britt Marshall, Brian McGillen, Ron Domen, David Towery, Tariq Ahmad, Penn State Milton S. Hershey Medical Ctr, Hershey, PA

Poster Sessions (continued)

212	212	What are the Imaging Capabilities at Referring Hospitals for Large Vessel Occlusion Triage? Results from the Massachusetts Statewide Survey	Lisa A Bemben, American Heart Association, Waltham, MA; Thabele Leslie-Mazwi, Massachusetts General Hosp, Boston, MA; Abigail Egan, American Heart Association, Waltham, MA; Zainab Magdon-Ismail, American Heart Association, Albany, NY; Lee H Schwamm, Michael H Lev, Massachusetts General Hosp, Boston, MA; Massachusetts CTA Workgroup
213	213	Percutaneous Coronary Intervention at Centers with and without On-Site Surgical Backup: A Meta-Analysis and Meta-Regression	Olajide Buhari, Jacobi Medical Ctr/Albert Einstein Coll of Med, New York, NY; Chioma Onyekwelu, Vidant Medical Ctr, Greenville, NC; Pedro Villablanca-Spineto, New York Univ, New York, NY; Amit Kakkar, Jacobi Medical Ctr/Albert Einstein Coll of Med, New York, NY
214	214	Stroke Epidemiology in the State of Maine 2010-2014	Gillian Gordon Perue, Keerthi Padooru, Samreen Fathima, Barbara Sorondo, Nicole Cournoyer , Eastern Maine Medical Ctr, Bangor, ME
215	215	Risk Factors, Management, and Outcomes Among Pregnant Women with Atrial Fibrillation	Maya Dassanayake , Elizabeth Langen, Mark Norris, Timothy Cotts, Melinda Baughman Davis, Univ of Michigan, Ann Arbor, MI
216	216	Evolution of Medicare Formulary Coverage Changes for Antithrombotic Therapies after Guideline Revisions	Elias J Dayoub , Perelman Sch of Med, Univ of Pennsylvania, Philadelphia, PA; Sanket S Dhruva, Univ of California San Francisco, San Francisco, CA; Joseph Ross, Yale Univ Sch of Med, New Haven, CT
217	217	PCSK9 Inhibitor Use and Health Characteristics Among High-Risk Patients with Atherosclerotic Cardiovascular Disease	Elias J Dayoub , Ashwin S Nathan, Srinath Adusumalli, Peter W Groeneveld, Perelman Sch of Med, Univ of Pennsylvania, Philadelphia, PA
218	218	Challenges and Opportunities in Using Cardiovascular Health Metrics and Social Determinants of Health to Inform Population Health Management	Caress A Dean , Brittany Ventline, Rachita Jagirdar, Oakland Univ, Rochester, MI
219	219	Health System Integration: Heart Failure Processes of Care Vary Significantly in a Large Academic Network	Rachel Dong , Northwestern Univ Feinberg Sch of Med, Chicago, IL; Jane Domingo, Erica Saito, Northwestern Med, Chicago, IL; Allen S. Anderson, Charles Davidson, Northwestern Univ Feinberg Sch of Med, Chicago, IL; Michelle Montpetit, Northwestern Med, Chicago, IL; Clyde W. Yancy, R. Kannan Mutharasan, Northwestern Univ Feinberg Sch of Med, Chicago, IL
220	220	Understanding Recovery in Patients Following Acute Myocardial Infarction	Rachel P Dreyer , Anthony Pavlo, Yale Univ, New Haven, CT; Denise Hersey, Princeton Univ, Princeton, NJ; Anna Horne, Robert Dunn, Harlan M Krumholz, Larry Davidson, Yale Univ, New Haven, CT
221	221	Transcatheter Aortic Valve Replacement is Associated with a Reduction in Hospitalization Rates: Insights from Nationwide Readmission Database	Ahmed Elkaryoni , Mohammed Qintar, David J Cohen, Adnan K Chhatriwalla, Suzanne V Arnold, Saint Luke's Mid America Heart Inst, Univ Of Missouri Kansas-City., Kansas City, MO
222	222	Comparison of Noninvasive Testing to No Testing in Stable Angina: A Secondary Analysis of the PROMISE Trial	Robert J Gallo , Washington Univ Sch of Med, Saint Louis, MO; David L Brown, Washington Univ Sch of Med, Cardiovascular Div, Saint Louis, MO

Poster Sessions (continued)

223	223	Adherence to Warfarin and Oral Anticoagulants: Outcomes of 12 Months Follow-up in Patients With Non-valvular Atrial Fibrillation	Dalia Giedrimiene , Univ of Saint Joseph, West Hartford, CT; Marc Tarsilo, Quinnipiac Univ/Sch of Med, North Haven, CT; Deivydas Giedrimas, Univ of Connecticut, Storrs, CT
224	224	Recent Trends in Coronary Artery Disease Quality Performance and Implications for Clinical Practice in the Era of Alternative Payment Models	Lauren Gilstrap , Dartmouth Hitchcock Medical Ctr, Lebanon, NH; Micah Aaron, Robert Wild, Nancy Beaulieu, Michael Chernew, Mary Beth Landrum, Harvard Medical Sch, Boston, MA
225	225	Determinants of Compensation for US Academic Physicians: Does Gender Matter?	Jessica R Golbus, Tongan Cai, Daniel Najarian, Brad Trumpower, Timothy Kao, Akbar Waljee, Brahmajee K Nallamothu , Univ of Michigan, Ann Arbor, MI
226	226	Predicting Major Adverse Cardiac Events Using HEART Score in the Elderly	Kevin Gu , Amar Kaneria, Parija Sharedalal, Drexel Univ Coll of Med, Philadelphia, PA; David Chang, Zucker Sch of Med at Hofstra/Northwell, Hempstead, NY; Neel Patel, Kevin D'Mello, Drexel Univ Coll of Med, Philadelphia, PA; Andrew Kohut, Penn Cardiology, Philadelphia, PA
227	227	Maximum IV-tPA Dose is Associated with Greater Likelihood of Hemorrhagic Conversion, and Worse Functional Outcome at Discharge	Roboan Guillen , Florida Intl Univ, Miami, FL; Amy K Starosciak, Felipe De Los Rios La Rosa, Baptist Health Neuroscience Ctr, Miami, FL
228	228	Comparison of the Effect of Local and Long-Distance Delivery Models for a School-Based Wellness Intervention on Health Behaviors of Middle School Students	Emily Guo , Rachel Krallman, Sabrina Bernardo, Daniel Montgomery, Jean DuRussel-Weston, Eva Kline-Rogers, Kim A Eagle, Univ of Michigan Health System, Ann Arbor, MI; Elizabeth A Jackson, Univ of Alabama at Birmingham, Birmingham, AL
229	229	Atrial Fibrillation Effect on the Outcomes and Prognosis of Myocarditis, a Report From the National Inpatient Sample of 2016	Faris I Haddadin , Alba Munoz Estrella, Dhruvajyoti Bandyopadhyay, Mount Sinai St Luke's-West, New York, NY; Suhail Haddadin, Hashemite Univ, Az'zarqa, Jordan; Hassan Beidoun, Vivek Modi, Eyal Herzog, Mount Sinai St Luke's-West, New York, NY
230	230	The Efficacy of Diuretics in Hypertension Control When Multiple Agents Are Prescribed: The Importance of Adherence to the Hypertension Guidelines	Faris I Haddadin , Alba Munoz Estrella, Joshua Berookhim, Lingling Wu, Sananda Moctezuma, Claire Huang Lucas, Karan Sud, Dipal Patel, Mount Sinai St Luke's-West, New York, NY
231	231	Outcome Variations Between Patients Prescribed Direct Oral Anticoagulant or Warfarin	Lucas Harden , Rachel Krallman, Delaney Feldeisen, Daniel Montgomery, Eva Kline-Rogers, Kim A Eagle, Univ of Michigan Health System, Ann Arbor, MI; Sherry M Bumpus, Michigan State Univ, East Lansing, MI
232	232	Effect of Oral Anticoagulation Use on Thromboembolic Risk and Bleeding in Women Compared with Men with Atrial Fibrillation: Findings from the PINNACLE Data Registry	Kamal Henderson , Univ of Colorado Sch of Med, Aurora, CO; Phillip Jones, Saint Lukes Health System, Kansas City, MO; Pamela Peterson, Frederick Masoudi, Stacie Daugherty, Univ of Colorado Sch of Med, Aurora, CO
233	233	Geographic Variability in the Utilization of Remote Monitoring for Pacemakers and Implantable Cardioverter-Defibrillators	Jessica Nichole Holtzman , Harvard Medical Sch, Boston, MA; Rishi K Wadhwa, Ariane M Fraiche, Eunhee Choi, Changyu Shen, Daniel B Kramer, Smith Ctr for Outcomes Res in Cardiology, Beth Israel Deaconess Medical Ctr, Boston, MA

Poster Sessions (continued)

234	234	Remote Monitoring Utilization and Medicare Spending for Pacemakers and Implantable Cardioverter-Defibrillators	Jessica Nichole Holtzman , Harvard Medical Sch, Brookline, MA; Rishi K Wadhwa, Ariane M Fraiche, Eunhee Choi, Changyu Shen, Daniel B Kramer, Smith Ctr for Outcomes Res in Cardiology, Beth Israel Deaconess Medical Ctr, Boston, MA
235	235	Landscape of Cardiovascular Device Registries in the US	Prashant V Rajan, Smith Ctr for Outcomes Res in Cardiology, Beth Israel Deaconess Medical Ctr, Boston, MA; Jessica Nichole Holtzman , Harvard Medical Sch, Boston, MA; Aaron S Kesselheim, Div of Pharmacoepidemiology and Pharmacoeconomics, Dept of Med, Brigham and Women's Hosp, Boston, MA; Robert W Yeh, Daniel B Kramer, Smith Ctr for Outcomes Res in Cardiology, Beth Israel Deaconess Medical Ctr, Boston, MA
236	236	Investigation of the Effects of the Affordable Care Act within the BRIDGE Population	Sarah Khan , Rachel Krallman, Delaney Feldeisen, Daniel Montgomery, Eva Kline-Rogers, Kim A Eagle, Univ of Michigan Health System, Ann Arbor, MI; Sherry M Bumpus, Michigan State Univ, East Lansing, MI
237	237	An Analytic Approach to and Creation of a Data Visualization Platform for National Cardiovascular Surveillance Data	Remy Poudel, Chris Shay, Kim Stitzel, Yosef Khan , American Heart Association, Dallas, TX
238	238	Healthcare Utilization Among Adults with Non-Fatal Cardiovascular Diseases in the United States	Remy Poudel, Yosef Khan , Chris Shay, Kim Stitzel, American Heart Association, Dallas, TX
239	239	Prevalence and Predictors of Diastolic Dysfunction in HIV-Infected and HIV-Negative Tanzanian Adults: A Cross-sectional Study	Justin Kingery , Chelsea Kennard, Weill Cornell Med, New York, NY; Bernard Desarius, Edmund Damas, Salama Fadhil, Boniface Mungo, Bugando Medical Ctr, Mwanza, Tanzania, United Republic of; Kathleen Walsh, Grace Seo, Weill Cornell Med, New York, NY; Kevin Abel, Bugando Medical Ctr, Mwanza, Tanzania, United Republic of; Puja Chebrolu, Margaret McNairy, Robert Peck, Weill Cornell Med, New York, NY
240	240	A Heart Failure Collaborative to Accelerate Improved Patient Outcomes in Three Metro Markets	Robin Kiser , American Heart Association, St. Louis, MO; Lynn Mallas-Serdynski, American Heart Association, Milwaukee, WI; Jacqueline Tomei, Kathleen O'Neill, American Heart Association, Chicago, IL; Michelle Scharnott, Michele Bolles, American Heart Association, Dallas, TX
241	241	An Investigation of Sex Differences in the BRIDGE Transitional Care Clinic Population	Monica Lee , Rachel Krallman, Delaney Feldeisen, Daniel Montgomery, Eva Kline-Rogers, Kim A Eagle, Univ of Michigan Health System, Ann Arbor, MI; Sherry M Bumpus, Michigan State Univ, East Lansing, MI
242	242	Comparison of Pharmacist-Managed Initial Dosing of Direct Oral Anticoagulants with Non-Pharmacist Practitioner Prescribing Patterns	Marissa Levito , Erika Felix-Getzik, MCPHS Univ, Boston, MA; David Berkowitz, George Philippides, Newton-Wellesley Hosp, Newton, MA; Gary Tataronis, MCPHS Univ, Boston, MA
243	243	ICD-10, DRG and ACTION: Poor Agreement Between Diagnoses of Acute Myocardial Infarction Results in Significant Differences in Process and Outcome Measures	Andrew Levy , Karen Ream, Andrew Hammes, Debra L Anoff, Joshua D Raines, Natalie Beck, Eric Rudofker, Kimberly J Marshall, Jessica D Nensel, John C Messenger, Frederick A Masoudi, Larry A Allen, P Michael Ho, Univ of Colorado, Aurora, CO

Poster Sessions (continued)

244	244	Identifying Differences in Demographics, Management, and Outcomes Between Type 1 and Type 2 NSTEMI Patients	Madeline Leyden , Rachel Krallman, Delaney Feldeisen, Daniel Montgomery, Eva Kline-Rogers, Kim A Eagle, Univ of Michigan Health System, Ann Arbor, MI; Sherry M Bumpus, Michigan State Univ, East Lansing, MI
245	245	Association Between Levels of Caregiver Engagement and Rates of Self-reported Healthcare Utilization After Stroke: A Mixed Methods Study	Chelsea Liu , Johns Hopkins Univ, Baltimore, MD; Victoria R Marino, Univ of South Florida, Tampa, FL; Orla C Sheehan, Jin Huang, David L Roth, Johns Hopkins Univ, Baltimore, MD; William E Haley, Univ of South Florida, Tampa, FL
246	246	Validating the Accuracy of Routine Electrocardiogram Arrhythmia Diagnosis From an Electronic Repository	Hongwei Liu , Reid Collins, Robert J Miller, Danielle A Southern, Bryan J Har, Matthew T James, Stephen B Wilton, Univ of Calgary, Calgary, AB, Canada
247	247	Reducing Costs and Intensive Care Unit Length of Stay in Patients with Intracerebral Hemorrhage	Adam MacLellan , Kassi Kronfeld, Hans Ang, Nick Murray, Elizabeth Fox, Alicia Wilson, Karen Hirsch, Zachary Threlkeld, Stanford Univ, Palo Alto, CA
248	248	Redesign of Order Entry to Improve Noninvasive Cardiac Test Selection	Dhruv Mahtta , Anas Alani, William B Cutting, Joshua B Kramer, Garrett H Brown, David E. Winchester, Univ of Florida, Gainesville, FL
249	249	Understanding the Patient Experience of Pain and Discomfort During Cardiac Catheterization	Anna E Mall , T Andrew Girton, Kevin Yardley, Paige Rossman, E Magnus Ohman, W Schuyler Jones, Bradi B Granger, Duke Univ Hosp, Durham, NC
250	250	Does Driving Time to the Transcatheter Aortic Valve Replacement Site Impacts on Long-Term Mortality Following a Successful Procedure? Insights from the STS/ACC TVT Registry	Guillaume Marquis-Gravel , Amanda Stebbins, Andrzej Kosinski, Duke Clinical Res Inst, Durham, NC; Morgan Cox, J Kevin Harrison, J Chad Hughes, Duke Univ, Durham, NC; Vinod Thourani, MedStar Heart & Vascular Inst, Atlanta, GA; Sreekanth Vemulapalli, Duke Clinical Res Inst, Durham, NC
251	251	Thrombolysis, DAPT, and Anticoagulation Administration in the Region Around Amarillo, Texas, in Patients with ST Elevation Myocardial Infarction From 2013-2016	Kelly S McMaster , Grace C Wang, Michael A McBrayer II, Totini S Chatterjee, Manish Patel, Steven Urban, David G Brabham, TTUHSC–Amarillo, Amarillo, TX
252	252	PredischaRge Initiation of Ivabradine in the ManagEment of Heart Failure: Results of the PRIME-HF Trial	Robert John Mentz , Adam DeVore, Gudaye Tasissa, Duke Clinical Res Inst, Durham, NC; John Heitner, New York Methodist Hosp, Brooklyn, NY; Ileana Pina, Montefiore, Bronx, NY; Anuradha Lala, Mount Sinai, New York, NY; Robert Cole, Inova, Arlington, VA; David Lanfear, Henry Ford, Detroit, MI; Chetan Patel, Duke Univ Medical Ctr, Durham, NC; Mahazarin Ginwalla, Univ Hosp Cleveland Medical Ctr, Cleveland, OH; Wayne Old, Sentara Cardiovascular Res Inst, Norfolk, VA; Abraham Salacata, Great Lakes Heart Ctr of Alpena, Alpena, MI; Tim Peterson, Robert Bigelow, Duke Clinical Res Inst, Durham, NC; Gregg Fonarow, Ahmanson-UCLA Cardiomyopathy Ctr, Univ of California, Los Angeles, Los Angeles, CA; Adrian Hernandez, Duke Univ Medical Ctr, Durham, NC
253	253	Talk to Me About Your Medication Nonadherence: Stories from Older Adults with Heart Failure	Rebecca Meraz , Baylor Univ, Dallas, TX

Poster Sessions (continued)

254	254	Utilization and Outcomes of Early Respiratory Support in 6.5 Million Acute Heart Failure Hospitalizations	Thomas Stephen Metkus , R Scott Stephens, Steven Schulman, Steven Hsu, Johns Hopkins Univ Sch of Med, Baltimore, MD; David Morrow, Brigham and Women's Hosp/Harvard Medical Sch, Boston, MA; Shaker Eid, Johns Hopkins Univ Sch of Med, Baltimore, MD
255	255	Patterns of Addiction Treatment for Patients Undergoing Cardiac Surgery for Infective Endocarditis Associated with Intravenous Drug Use	Max Jordan Nguemeni Tiako , Seong Hong, Syed Usman Bin Mahmood, Umer Darr, Abeel Mangi, Manisha Jutthani-Mehta, Arnar Geirsson, Yale Sch of Med, New Haven, CT
256	256	Optimal Medical Therapy Does Not Prevent Readmission in GWG-HF Patients with Ventricular Conduction Abnormalities	Hamza Oglat , Mikhail Torosoff, Albany Medical Ctr, Albany, NY
257	257	Adherence and Persistence to Direct Oral Anticoagulants in Patients with Atrial Fibrillation	Aya F Ozaki , Austin S Choi, Quan T Le, Western Univ of Health Sciences, Pomona, CA; Dennis T Ko, ICES, Toronto, ON, Canada; Cynthia A Jackevicius, Western Univ of Health Sciences, Pomona, CA
258	258	Impact of Post-Traumatic Stress Disorder on Clinical Outcomes in Veterans with Coronary Artery Disease	Puja Parikh , Jamie Romeiser, Pam Jannello, A, Laurie Shroyer, Northport VA Medical Ctr, Northport, NY
259	259	Impact of Valvular Heart Disease on 1-Year Mortality in Veterans	Puja Parikh , Jamie Romeiser, Pam Jannello, A, Laurie Shroyer, Northport VA Medical Ctr, Northport, NY
260	260	COMPASS-CP for HF: An Electronic Application to Capture Patient-Reported Outcomes of Individuals with Heart Failure	Amy M Pastva , Duke Univ Sch of Med, Durham, NC; Rachel D Croxton, Jason P Stopyra, Pamela W Duncan, Wake Forest Sch of Med, Winston-Salem, NC
261	261	Gender-Specific Differences in Behavioral and Physiological Risk Factors Associated with Childhood Obesity	Liliana Pfeifer , Rachel Krallman, Sabrina Bernardo, Daniel Montgomery, Jean DuRussel-Weston, Eva Kline-Rogers, Kim A Eagle, Univ of Michigan Health Systems, Ann Arbor, MI; Elizabeth A Jackson, Univ of Alabama at Birmingham, Birmingham, AL
262	262	Factors Influencing the Adoption of Get With The Guidelines® Quality Improvement Registries: Findings from a Regional Survey	Gregory L Poe , American Heart Association, Indianapolis, IN; Kathie Thomas, American Heart Association, Grand Rapids, MI; Robin Kiser, American Heart Association, St. Louis, MO; Kayli Saathoff, American Heart Association, Overland Park, KS; Lynn Serdynski, American Heart Association, Milwaukee, WI; Cristin Mathew, American Heart Association, Chicago, IL
263	263	Real World Outpatient Treatment Patterns of Patients with Cancer-Associated Venous Thromboembolism in the US	Jennifer D Guo, Bristol-Myers Squibb, Lawrenceville, NJ; Patrick Hlavacek, Pfizer Inc., New York, NY; Tayla Poretta , Gail Wygant, Daniel C Lane, Bristol-Myers Squibb, Lawrenceville, NJ; Magdaliz Gorriz, Xin Wang, Chi-Chang Chen, IQVIA, Plymouth Meeting, PA; Xianying Pan, Jigar Rajpura, Brian Stwalley, Lisa Rosenblatt, Bristol-Myers Squibb, Lawrenceville, NJ
264	264	Rapid Deployment Aortic Valve Replacement is Associated with Lower Mortality and Hospital Utilization: Initial Findings from a Retrospective Multi-Institutional Hospital Database	Matt Reifenger , Edwards Lifesciences, Irvine, CA; William Irish, East Carolina Univ, Greenville, NC; Matt Moore, Edwards Lifesciences, Irvine, CA

Poster Sessions (continued)

265	265	Improving Compliance with Get with the Guidelines-Resuscitation Metrics by Standardizing Code Note Documentation	Benjamin Moss, Katherine Richards , Baylor Coll of Med, Houston, TX; Seanna Davignon, Baylor St. Luke's Medical Ctr, Houston, TX; Babith Mankidy, Christopher K Morgan, Baylor Coll of Med, Houston, TX
266	266	Referral Pathways in the Evaluation of Syncope	John Rogers , Scripps Clinic, La Jolla, CA; Sarah Rosemas, Jason Sims, Medtronic, Mounds View, MN; Diana Homsy, Audrey Garman, Catherine Richards, Boston Health Economics, Boston, MA
267	267	Impact of Socio-demographic Factors on a 30-day Readmission in Patients with Acute Myocardial Infarction	Wojciech Rzechorzek , Basera Sabharwal, Faris Haddadin, David Weininger, Bing Yue, Mariam Khandaker, Alba Munoz, Shawn Lee, Syed Ahsan, Alejandro Lemor, Allison Selby, Jacqueline Tamis-Holland, Mount Sinai St. Luke's West, New York, NY
268	268	Patients >65 Years of Age With Acute Myocardial Infarction Are Less Likely to Undergo Percutaneous Coronary Intervention and Have a Higher In-hospital Mortality	Wojciech Rzechorzek , Kirtipal Bhatia, Michel Skaf, Jan Lopes, Eyal Herzog, Mount Sinai St. Luke's West, New York, NY
269	269	Patients >65 Years of Age Have Higher Mortality After In-hospital Cardiac Arrest With Lower Utilization of Healthcare Resources	Wojciech Rzechorzek , Michel Skaf, Bharat Narasimhan, Jan Lopes, Eyal Herzog, Mount Sinai St. Luke's West, New York, NY
270	270	Patients With Acute Ischemic Stroke and Associated Diagnosis of Obstructive Sleep Apnea Have Lower In-hospital Mortality	Wojciech Rzechorzek , Kirtipal Bhatia, Bharat Narasimhan, Michel Skaf, Eyal Herzog, Mount Sinai St. Luke's West, New York, NY
273	273	Acute and Long-term Efficacy of Interleukin-1 Inhibitor Anakinra in Idiopathic and Secondary Pericarditis in Patients Refractory or Intolerant to Conventional Therapy	Muhammad Hamza Saad Shaukat, Sukhraj Singh, Albany Medical Ctr, Albany, NY; Kathryn Davis , Albany Medical Coll, Albany, NY; Mikhail Torosoff, Ruben Peredo-Wende, Albany Medical Ctr, Albany, NY
274	274	Healthcare Resource Use and Expenditures in Younger Women and Men Newly Diagnosed with Paroxysmal Supraventricular Tachycardia (PSVT)	Sean D Pokorney, Duke Univ Medical Ctr, Durham, NC; Naomi C Sacks , Philip L Cyr, Precision Xtract, Boston, MA; Katie Everson, Precision Health Economics, Austin, TX; David R Wood, Milestone Pharmaceuticals, Montreal, QC, Canada
275	275	The Association of Gout with an Increased Risk of Hypertension and Diabetes Mellitus Among Stroke Survivors in New Zealand: An Observational Study Using Routinely-collected Electronic Health Data	Dina Eufemia San Gabriel , Cleveland Clinic Abu Dhabi, Abu Dhabi City, United Arab Emirates; Julia Slark, Univ of Auckland, Auckland, New Zealand
276	276	WITHDRAWN	
277	277	WITHDRAWN	
278	278	Using mHealth to Assess Physical Activity Guideline Adherence in Smokers: A Secondary Analysis of mActive-Smoke	Rongzi Shan , Lisa R Yanek, Luke G Silverman-Lloyd, Sina Kianoush, Michael J Blaha, Seth S Martin, Johns Hopkins Univ Sch of Med, Baltimore, MD

Poster Sessions (continued)

279	279	Using the Familial Hypercholesterolemia ICD-10 Code to Track Clinical Management of Patients at a Tertiary Academic Center	Samip Sheth , Univ of Pennsylvania, Philadelphia, PA; Ezim Ajufo, Univ of Texas Southwestern, Dallas, TX; Daniel Rader, Daniel Soffer, Douglas Jacoby, Eirik Hossain, Univ of Pennsylvania, Philadelphia, PA
280	280	Adherence to Antihypertensive Prescription Medication Stratified by Gender and Age: An Employer-Sponsored Health Care Perspective	Zachary Goldberg, Univ of South Carolina Honors Coll, Columbia, SC; Judy Z Louie, Dov Shiffman , Quest Diagnostics, San Juan Capistrano, CA
281	281	Antihypertensive Pharmacotherapy Eligibility Based Upon the 2017 ACC/AHA High Blood Pressure Clinical Practice Guidelines Among Young Adults Prior to Myocardial Infarction	Avinander Singh , Bradley Collins, Ankur Gupta, Marcelo F DiCarli, Deepak L Bhatt, Brigham and Women's Hosp, Boston, MA; Khurram Nasir, Yale New Haven Hosp, New Haven, CT; Ron Blankstein, Brigham and Women's Hosp, Boston, MA
282	282	Race and Gender-Based Perceptions of Older Adults	Sade Solola MD , Univ of Arizona, Tucson, AZ; Luis Luy, Univ of Rochester, Rochester, NY; Kathryn Herrera-Theut BS, Leanne Zabala BS, Elmira Torabzadehkhorsani MS, Edward Bedrick PhD, Erica Yee BS, Ashley Larsen MS, Jeff Stone PhD, Marylyn McEwen PhD, Elizabeth Calhoun PhD, Janice D Crist PhD, RN, Megan Hebdon DNP, Natalie Pool PhD, Nancy Sweitzer MD, PhD, Khadijah Breathett MD, MS, Univ of Arizona, Tucson, AZ
283	283	Healthcare Resource Utilization and Costs Associated with Oral Anticoagulant Reversal Therapy	Alex C Spyropoulos , Northwell Health at Lenox Hill Hosp, New York, NY; Briain Ó Hartaigh, Boehringer Ingelheim Pharmaceuticals Inc, Ridgefield, CT; Zhun Cao, Premier Inc, Charlotte, NC; Harjeet Caberwal, Boehringer Ingelheim Pharmaceuticals Inc., Ridgefield, CT; Craig B Lipkin, Premier Inc, Charlotte, NC; Jessica Franchino-Elder, Cheng Wang, Boehringer Ingelheim Pharmaceuticals Inc., Ridgefield, CT; Scott B Robinson, Premier Inc, Charlotte, NC
284	284	Social Determinants of Health and 90 Day Mortality after Hospitalization for Heart Failure in the REasons for Geographic and Racial differences in Stroke (REGARDS) Study	Madeline R Sterling , Joanna Bryan Ringel, Laura C Pinheiro, Monika M Safford, Weill Cornell Medical Coll, New York, NY; Emily B Levitan, Univ of Alabama, Birmingham, AL; Erica Phillips, Parag Goyal, Weill Cornell Medical Coll, New York, NY
285	285	Do Providers Prescribe Statins to Patients Diagnosed with Carotid Artery Stenosis in Adherence with the AHA/ASA Stroke Prevention Guidelines?	Vikas Sunder , Jason Farber, Melissa McCarey, David Whellan, Thomas Jefferson Univ, Philadelphia, PA
286	286	The Heart Failure Clinic: Empowering the Armor Against 30-day All-cause Readmissions	Nicholas Taklalsingh , Perry Wengrofsky, SUNY Downstate Medical Ctr, Brooklyn, NY; Howard Levitt, Kings County Hosp Ctr, Brooklyn, NY
287	287	Does a Higher Level of Education Translate Into a Lower Prevalence of Cardiovascular Disease	Taher Mamdouh T Tayeb , Talal Alzahrani, Marco Mercader, George Washington Univ Hosp, Washington, DC
288	288	Payments, Mortality and Readmission Rates in US News and World Report "Best Hospitals" in Cardiology	Lina Vadlamani , Amarnath Annapureddy, Nihar Desai, Yale Sch of Med, New Haven, CT

Poster Sessions (continued)

289	289	Factors Associated with Costs, Resource Utilization, and Mortality in Bentall Procedures	Tara Walker , Matt Moore, Edwards Lifesciences, Irvine, CA
290	290	A Risk Prediction Model for Heart Failure in Patients with Chronic Coronary Artery Disease	Daniela Geba, Gesinger Health System, Danville, PA; Aarti Patel, Jacqueline A Pesa, Janssen Scientific Affairs, LLC, Titusville, NJ; Brent Williams , Gesinger Health System, Danville, PA
291	291	Abstract Title: Assessment of The High risk and unmet Need in Patients with CAD and Type 2 Diabetes (ATHENA): US Healthcare Resource Use and Cost in a Commercially-Insured Population	Eric Wittbrodt , AstraZeneca, Gaithersburg, MD; Karolina Andersson Sundell, AstraZeneca, Gothenburg, Sweden; Narinder Bhalla, AstraZeneca, Wilmington, DE; Phillip Hunt, AstraZeneca, Gaithersburg, MD; Carl Mellstrom, AstraZeneca, Gothenburg, Sweden; Nathan Wong, Univ of California, Irvine, CA
292	292	Depression is Associated With Decrease in Cardiac Catheterization Rate and Delay in Cardiac Catheterization in Patient With Non-ST-Segment Elevation Myocardial Infarction: Insight From National Inpatient Sample Database	Lingling Wu , Faris Haddadin, Eyal Herzog, Mount Sinai St Lukes and Mount Sina West, New York, NY



Wolters Kluwer

Circulation: Cardiovascular Quality and Outcomes

An American Heart Association Journal

EXCEPTIONAL SERVICE FOR AUTHORS AND REVIEWERS

Simple Online Submission

Our journal thrives on the work of our authors. That's why we prioritize making the manuscript submission process as easy as possible. We look forward to welcoming your work.

circoutcomes-submit.aha-journals.org

Reviewer Recognition Program

We wish to thank our reviewers for donating their valuable time to ensure the quality and integrity of the science we publish. This year, we will recognize the top reviewers at the AHA's QCOR 2019 Scientific Sessions.

Follow [@CircOutcomes](https://twitter.com/CircOutcomes) to see who's on this year's top reviewer list!



www.ahajournals.org/journal/circoutcomes

EDITOR-IN-CHIEF: Brahmajee K. Nallamothu, MD, MPH

Poster Sessions (continued)

293	293	Effect of Cardiovascular Health and Text Messaging (CHAT) on Risk Factor Management in Patients with Coronary Heart Disease: A Randomized Clinical Trial	<p>Xin Zheng, Natl Clinical Res Ctr of Cardiovascular Diseases, State Key Lab of Cardiovascular Disease, Fuwai Hosp, Natl Ctr for Cardiovascular Diseases, Chinese Acad of Medical Sciences and Peking Union Medical Coll, Beijing, China; Erica S Spatz, Ctr for Outcomes Res and Evaluation, Yale Univ/Yale-New Haven Hosp, New Haven, CT; Xueke Bai, Xiqian Huo, Natl Clinical Res Ctr of Cardiovascular Diseases, State Key Lab of Cardiovascular Disease, Fuwai Hosp, Natl Ctr for Cardiovascular Diseases, Chinese Acad of Medical Sciences and Peking Union Medical Coll, Beijing, China; Qinglan Ding, Ctr for Outcomes Res and Evaluation, Yale Univ/Yale-New Haven Hosp, New Haven, CT; Paul Horak, Stanford Univ Sch of Med, Stanford, CA; Xuekun Wu, Wenchi Guan, Natl Clinical Res Ctr of Cardiovascular Diseases, State Key Lab of Cardiovascular Disease, Fuwai Hosp, Natl Ctr for Cardiovascular Diseases, Chinese Acad of Medical Sciences and Peking Union Medical Coll, Beijing, China; Clara K Chow, Westmead Applied Res Ctr, Faculty of Med and Health, Univ of Sydney and The George Inst for Global Health, Sydney, Australia; Xiaofang Yan, Ying Sun, Xiuling Wang, Haibo Zhang, Jiamin Liu, Jing Li, Xi Li, Natl Clinical Res Ctr of Cardiovascular Diseases, State Key Lab of Cardiovascular Disease, Fuwai Hosp, Natl Ctr for Cardiovascular Diseases, Chinese Acad of Medical Sciences and Peking Union Medical Coll, Beijing, China; John A Spertus, Health Outcomes Res, Saint Luke's Mid America Heart Inst/Univ of Missouri-Kansas City, Kansas City, MO; Frederick A Masoudi, Div of Cardiology, Univ of Colorado Anschutz Medical Campus, Aurora, CO; Harlan M Krumholz, Ctr for Outcomes Res and Evaluation, Yale Univ/Yale-New Haven Hosp, Section of Cardiovascular Med, Yale Univ Sch of Med, Dept of Health Policy and Management, Yale Univ Sch of Public Health, New Haven, CT</p>
294	294	Changes in the U.S. Burden of Cardiovascular Mortality by Unique Weighting Methodologies	<p>Boback Ziaeeian, Gregg C Fonarow, UCLA, Los Angeles, CA</p>

POSTERS

Author Index (continued)

Aaron, M.	224	Bandyopadhyay, D.	131, 16, 229	Brandt, E. J.	30
Abbott, J. D.	196	Barker, C. M.	151	Breathett, K.	14
Abdallah, M.	186, 187, 28	Barrios, J.	133, 35	Breathett MD, MS, K.	282
Abedin, Z.	13	Barzilai, B.	186, 187, 28	Breeding, T.	132
Abel, K.	239	Basit, A.	211	Breitfeller, L. M.	145
Ad, N.	31	Basit, M.	167	Brescia, A. A.	188
Addo, T.	15	Baughman Davis, M.	215	Brindis, R. G.	102, 103
Ademovi , E.	276	Beall, L.	15	Briskin, M.	127
Adie, S.	120	Beaulieu, N.	127, 128, 224	Brosseau, E.	190
Adusumalli, S.	217, 4	Beck, N.	20, 243	Brown, A.	195
Agarwal, S.	17	Bedi, S.	211	Brown, D. L.	222
Agrawal, D.	12	Bedrick PhD, E.	282	Brown, D.	116
Ahlers, M.	201	Beeravolu, H.	195	Brown, E.	134
Ahmad, F. S.	101	Beidoun, H.	131, 229	Brown, G. H.	248
Ahmad, T.	211	Bemben, L. A.	212	Brown, J. R.	170
Ahsan, S.	130, 173, 267	Bennett, D.	15	Brown, K.	111
Ajufo, E.	279	Berger, K.	15	Brown, K. D.	195
Akbilgic, O.	25	Berggren, E.	195	Brown, T. J.	12
Alani, A.	248	Berkowitz, D.	242	Buchanan, H.	121
Alba, M.	24	Berlin, J. A.	24	Buchanich, J. M.	115
Albert, N. M.	102, 103	Bernardo, S.	228, 261	Buhari, O.	109, 213
Alejo, D.	31	Bernholz, J.	23	Bukharovich, I.	105
Allen, L. A.	20, 243	Berookhim, J.	230	Bumpus, S. M.	231, 236, 241, 244
Allison, M.	14	Besser, S. A.	150	Burton, T.	110
Allison, M.	182	Betancourt, B.	116	Caberwal, H.	283
Alreshq, R.	202, 203	Bhalla, N.	291	Cabrera, L.	188
Al-Sadawi, M.	104, 105	Bhandari, A.	204	Cadavero, A.	34
Alvarado, F. J.	204	Bhatia, K.	268, 270	Cai, T.	225
Alvarez, K.	15	Bhatla, A.	3	Calhoun PhD, E.	282
Alzahrani, T.	113, 197, 287, 5	Bhatt, C.	178, 179	Cao, Z.	283
Alzharani, T.	109	Bhatt, D. L.	281	Capric, V.	105
Amraotkar, M.	205	Bhattacharya, P. T.	106	Carluzzo, K. L.	101
Anderson, A. S.	219	Bhattacharya, S. T.	106	Carmack, D.	206
Anderson, T. S.	18	Bidulescu, A.	134	Carrick, R. T.	111
Andersson Sundell, K.	291	Bigelow, R.	252	Cascino, T.	160, 193
Ang, H.	247	Bin Mahmood, S.	255	Casey, D. E.	38
Annapureddy, A.	288, 30	Birs, A. S.	107	Cassidy, S.	112
Anoff, D. L.	20, 243	Bitetzakis, C.	204	Castro, N. D.	116
Arnold, S. V.	132, 221	Blacketer, C.	23	Cavalcante, L.	179
Arora, G.	19	Blaha, M.	135, 157	Cavaljuga, S.	276
Arora, P.	19	Blaha, M. J.	278	Cavusoglu, E.	104
Aryal, S. R.	206	Blankstein, R.	135, 157, 281	Cavusoglu, S.	104
Ashburner, J. M.	207	Blecker, S.	36	Cella, D.	101
Ashley, E.	162, 22	Bliden, K. P.	32	Cene, C. W.	14
Assi, R.	208	Blüher, M.	177	Chakko, S.	125
Astudillo, K.	37	Bobby, K. J.	115	Chamberlain, A.	148
Atanda, A.	109	Bobo, B.	141	Chan, P.	2
Atanda, O.	109	Bohra, C.	181	Chan, P. S.	33
Atlas, S. J.	207	Bojko, M. M.	164	Chang, D.	226
Austrian, J.	36	Bolles, M.	240	Chang, Y.	207
Autruong, P.	29	Bonvento, M.	142	Charlu, M.	139
Avadhani, S.	104	Book, W.	196	Chatterjee, S.	106
Awad, H. H.	209	Borden, W.	109	Chatterjee, T. S.	251
Ayub, A.	195	Borowsky, L. H.	207	Chebrolu, P.	239
Badh, R.	39	Boyle, A.	206	Chen, A.	204
Bai, X.	293	Brabham, D. G.	251	Chen, C. C.	263
Baker, C. L.	210	Bradley, S. M.	108, 29	Chen, J.	208

Author Index (continued)

Chen, O.....	143	De Los Rios La Rosa, F.....	227	Farrell, D.....	34
Chen, Z.....	199	Denkins, T.....	15	Farrelly, E.....	168
Chernew, M.....	127, 224	Denktas, A. E.....	117	Fathima, S.....	214
Chhatriwalla, A. K.....	221	Desai, N.....	157, 288	Fawcett, J.....	118
Chidester, J. P.....	15	Desai, N. R.....	11, 30	Feldeisen, D.....	231, 236, 241, 244
Chirinos, J. A.....	106	Desarius, B.....	239	Felix-Getzik, E.....	242
Choi, A.....	197	Dev, S.....	118	Ferket, B. S.....	156
Choi, A. S.....	257	DeVore, A.....	252	Fernandes, M.....	125
Choi, B.....	197	Dham, N.....	39	Ferri, M.....	110
Choi, E.....	1, 233, 234	Dhamane, A. D.....	210	Ferri, M.....	138
Chow, C.....	293	Dhillon, N.....	209	Ferro, E. G.....	1
Chua, R. F.....	150	Dhruva, S. S.....	119, 216	Fifer, M.....	17
Clair, J. S.....	121	Dhungana, R.....	206	Fine, M. J.....	123
Clark, C. R.....	161	DiCarli, M. F.....	281	Fisher, E. S.....	101
Clauss, S.....	125	Dina, O.....	210	Fletcher, R.....	144
Cobbs-Lomax, D.....	37	Ding, L.....	127	Fonarow, G.....	252
Cohen, D. J.....	221	Ding, Q.....	293	Fonarow, G. C.....	102, 103, 294
Cole, R.....	252	DiScipio, A.....	171	Fonner, C. E.....	31
Collins, B.....	281	D'Mello, K.....	226	Foody, J.....	23
Collins, R.....	246	Do, R.....	175, 176	Ford, J.....	169
Conway, M.....	120	Dodani, S.....	121	Forgione, J.....	5
Corbie-Smith, G.....	14	Dolan, K.....	112	Fox, E.....	247
Cork, D. P.....	151	Doll, J. A.....	29	Fraai, M.....	190
Cosgrove, T. C.....	112	Domen, R.....	211	Fraiche, A. M.....	233, 234
Cotts, T.....	215	Domingo, J.....	219	Franchino-Elder, J.....	283
Coulter-Thompson, E.....	158	Dong, C.....	183	Freedman, A.....	24
Cournoyer, N.....	206, 214	Dong, R.....	219	Friedman, C.....	158
Covas, P.....	113	Dong, Y.....	199	Fukuhara, S.....	188
Cox, M.....	250	Dorsch, M. P.....	120	Gajarski, R.....	112
Crist PhD, RN, J. D.....	282	Doshi, R.....	19	Gallo, R. J.....	222
Croxton, R. D.....	260	Dreyer, R. P.....	220	Ganatra, S.....	174
Cutler, D.....	127, 128	Duncan, P. W.....	260	Gao, R.....	199
Cutting, W. B.....	248	Dunn, R.....	220	Garcia, R.....	126
Cyr, P. L.....	274	DuRussel-Weston, J.....	228, 261	Garg, D.....	126
Daeter, E. J.....	114	Dwairy, A.....	5	Garman, A.....	266
Dahiya, G.....	115	Eagle, K. A.....	228, 231, 236, 241, 244, 261	Geba, D.....	290
Dalton, M.....	127	Eaton, C. B.....	14	Geirsson, A.....	255
Damas, E.....	239	Eckman, P.....	108	Gelijns, A. C.....	156
Darr, U.....	255	Edwards, J.....	121	Gellad, W. F.....	123
Das, S. R.....	12, 15, 161	Egan, A.....	212	Gelow, J. M.....	101
DAS, S.....	116, 178, 179, 277	Eid, S.....	254	Gemmill, A.....	182
Dassanayake, M.....	215	ELJack, A.....	122	Geng, Z.....	4
Daugherty, S.....	232	Elkaryoni, A.....	221	Ghadimi, K.....	34
Davidson, C.....	219	Ellinor, P. T.....	207	Ghorbani, A.....	162, 22
Davidson, L.....	220	Ellis, M. F.....	34	Gidel, L.....	178, 277
Davignon, S.....	265	Elteriefi, R.....	122	Giedrimas, D.....	223
Davis, K.....	273	E. Manson, J.....	182	Giedrimiene, D.....	223
Davis, R. L.....	25	Essien, U. R.....	123	Gilliam, C.....	116
Dayoub, E.....	4	Everson, K.....	146, 274	Gilstrap, L.....	224
Dayoub, E. J.....	216, 217	Fabbri, M.....	148	Gilstrap, L. G.....	127, 128
Dean, C. A.....	218	Fadhil, S.....	239	Gimotty, P.....	106
Dean, E.....	133, 35	Fahad, F.....	199.1	Ginwalla, M.....	252
Deeb, G. M.....	188	Faillace, R.....	109	Giri, J.....	159, 3, 4
DeFalco, F.....	24	Fang, S.....	146	Giri, J. S.....	106
Delate, T.....	139	Farber, J.....	285	Giri, S.....	25
De La Villa, R.....	173, 194	Farooq, A.....	124	Girton, T. A.....	249
De La Villa Pagán, R.....	130			Giustino, G.....	156

Author Index (continued)

Gluckman, T. J.	102, 103	Heitner, J.	252	Jaffer, O.	142
Golbus, J. R.	225	Hejjaji, V.	132, 133, 166, 2, 33, 35	Jagirdar, R.	218
Goldberg, R. J.	209	Helmers, M.	164	James, M. T.	246
Goldberg, Z.	280	Henderson, K.	232	Janes, W. A.	111
Goodney, P. P.	170	Henry, T.	196	Jannello, P.	258, 259
Gopalakrishnan, L.	129	Hermanowski-Vosatka, A.	23	Javaid, K.	104
Gordon Perue, G.	214	Hernandez, A.	252	Jefferies, J. L.	25
Gorritz, M.	263	Hernandez, I.	123	Jenkins, B.	201
Gosch, K.	132	Hernandez Burgos, P.	204	Jiang, J.	198
Goyal, A.	196	Herrera- Theut BS, K.	282	Jiang, N. M.	135
Goyal, P.	284	Hersey, D.	220	Jiang, R.	148
Graham, A.	141	Herzog, E. 16, 229, 268, 269, 270, 292		Jindal, M.	32
Graham, D.	11	Hess, P. L.	29	Jones, A. E.	21
Grandhi, G. R.	157, 30	Hester, L.	24	Jones, L.	39
Granger, B. B.	249, 34	Hirsch, K.	247	Jones, P. G.	132, 2
Green, C. L.	136	Hlatky, M.	182	Jones, P.	232
Grevious, S.	125	Hlavacek, P.	110	Jones, T.	136
Groeneveld, P.	4	Hlavacek, P.	138, 263	Jones, W. S.	249
Groeneveld, P. W.	217, 3	Ho, P. M.	20, 243	Joshi, A. A.	115
Gu, A.	127	Ho, P.	29	Joyner, S.	121
Gu, K.	226	Hoerner, R.	13	Joynt Maddox, K. E.	192
Guan, W.	293	Holcombe, S. A.	134	Jutthani-Mehta, M.	255
Guan, W.	207	Holmes, S. D.	31	Kakkar, A.	213
Guang, H.	199	Holtzman, J. N.	233, 234, 235	Kallen, M. A.	101
Guillen, R.	227	Homsy, D.	266	Kalra, R.	19
Gulino, K.	142	Hong, S.	255	Kampangkaew, J.	137
Gunnarsson, C.	151	Horak, P.	293	Kamran, H.	104
Guo, E.	228	Horbal, S. R.	134	Kaneria, A.	226
Guo, J. D.	110	Horne, A.	220	Kang, Y.	199
Guo, J. D.	138, 263	Horstman, M. J.	27	Kanjerla, K.	144
Gupta, A.	281	Horwitz, L.	36	Kanwar, M. K.	145
Gurbel, P.	32	Hossain, E.	279	Kao, T.	225
Gutierrez, C. M.	183	Houterman, S.	114	Kasprowicz, T.	204
Guzman, H.	116	Howard, B.	182	Katz, S.	36
Habboushe, J.	13	Hsu, S.	254	Kavinsky, C. J.	17
Hackett, I.	21	Hu, H.	199	Kawamoto, K.	13
Haddad, F.	162	Huang, J.	245	Kawut, S. M.	106
Haddadin, F.	16, 173, 267, 292	Huang Lucas, C.	230	Kazi, D. S.	3
Haddadin, F. I.	130, 131, 229, 230	Huded, C.	28	Kearney, K.	107
Haddadin, M.	105	Hughes, J.	250	Keene, D.	165
Haddadin, S.	131	Hulseman, M.	186, 187, 28	Kelley, L.	37
Haddadin, S.	229	Hunt, P.	291	Kennard, C.	239
Haddadin, S. I.	131	Huo, X.	293	Kennedy, K.	133, 196, 35
Haley, W. E.	245	Huo, Y.	198	Kent, D. M.	111, 195
Halm, E. A.	161	Hutten, D.	37	Kentucky Stroke Encounter Quality Improvement Project	141
Hameed, A. A.	106	Hyeon Choi, H.	121	Kenyon, S.	117
Hamm, H.	201	Inselman, J. W.	11	Keshishian, A.	138
Hammes, A.	20, 243	Iribarne, A.	171	Kesselheim, A. S.	235
Hamzeh, I.	137	Irish, W.	264	Kester, K.	34
Han, J. J.	164	Ismail, H.	197	Kettle, M.	34
Hanigan, S.	120	Iyengar, A.	164	Khan, S.	236
Har, B. J.	246	Izem, R.	11	Khan, Y.	237, 238
Harden, L.	231	Jackevicius, C. A.	257	Khandaker, M.	130, 173, 267
Harrison, J.	250	Jackson, E. A.	228, 261	Khariton, Y.	133, 166, 35
He, W.	207	Jackson, L.	136	Khatana, S. A. M.	4
Hebdon DNP, M.	282	Jacobs, B.	39	Khatana, S. M.	3
Heidenreich, P. A.	175, 176	Jacoby, D.	279		

Author Index (continued)

Khera, R.	157	Lee, S.	144	Magnani, J. W.	123
Khosla, S.	129	Lee, S.	130, 173, 267	Mahaffey, K. W.	189
Khot, U.	186, 187, 28	LeFrancois, S.	180	Mahraj, K.	184
Kianoush, S.	278	Lemor, A.	130, 173, 267	Mahtta, D.	248
Kim, K. M.	188	Leslie-Mazwi, T.	212	Makam, A. N.	161
Kimmel, S. E.	101	Lessard, D.	209	Malenka, D. J.	171
King, J. B.	139	Lev, M. H.	212	Malik, A.	102, 103
Kingery, J.	239	Levine, L.	184	Malik, A.	166
Kini, V.	29	Levitan, E. B.	284	Malik, A. O.	2, 33
Kirley, K.	38	Levito, M.	242	Maliszewski, M.	143
Kiser, R.	240, 262	Levitt, H.	185, 286	Mall, A. E.	249
Kleman, C.	140	Levy, A.	243	Mallas-Serdynski, L.	240
Kline, J. A.	110	Levy, A. E.	20	Man, S.	147
Kline-Rogers, E.	160, 193, 228, 231, 236, 241, 244, 261	Lewey, J.	184	Manemann, S.	148
Ko, D. T.	257	Lewis, J.	197	Mangi, A.	255
Kobashigawa, J.	196	Leyden, M.	244	Manguba, A.	194
Kobayashi, T.	4	Li, J.	293	Mankidy, B.	265
Koelling, T. M.	120	Li, Q.	23	Manson, J.	14
Kohut, A.	226	Li, X.	293	Mao, Y.	169
Kongpakpaisarn, K.	181	Liang, D.	162, 22	Mardekian, J.	110
Kosinski, A.	250	Liao, J. K.	150	Mardekian, J.	138, 210
Kowalski, L.	195	Likosky, D. S.	188	Marino, V. R.	245
Krallman, R.	228, 231, 236, 241, 244, 261	Lin, G.	18	Marmur, J. D.	104, 17
Kramer, D. B.	233, 234, 235	Lin, J.	210	Marquis-Gravel, G.	250
Kramer, J. B.	248	Lin, T.	198	Marshall, B.	211
Kravitz, K.	28	Lind, J.	24	Marshall, K. J.	20, 243
Krebbs, R.	196	Lingohr-Smith, M.	210	Martin, D.	11
Kreitzman, K.	190	Lipkin, C. B.	283	Martin, S. S.	26, 278
Krepp, J.	113, 197	Liu, A.	115	Martinez, J.	159
Kronenberg, M. W.	201	Liu, C.	245	Marvel, F. A.	26
Kronfeld, K.	247	Liu, H.	246	Marzouka, G.	125
Krumholz, H. M.	220	Liu, J.	293	Masoudi, F.	232
Krumholz, H.	293	Liu, L.	146	Masoudi, F. A.	20, 243
Krumholz, L.	37	Liu, P.	37	Masoudi, F.	293
Kuhn, A.	141	Liu, W.	29	Massachusetts CTA Workgroup,	212
Kumar, V.	129	Llyod-Jones, D. M.	21	Matheny, M. E.	119
Kuperman, G.	36	Lo, H.	144	Mathew, C.	15
Labib, S.	174	Lohmueller, L. C.	145	Mathew, C.	12
Labovitz, A.	204	Lopes, J.	268, 269	Mathew, C.	262
Ladrum, M.	127	Louie, J. Z.	280	Maynard, C.	107
Lakdawalla, D. N.	146	Lourdusamy, D.	126	Mayorga, L.	149
Lala, A.	252	Lu, D.	102, 103	Mazhari, R.	113, 5
Landrum, M.	224	Lu, Y.	13	Mazurek, J. A.	106
Lane, D. C.	263	Lubitz, S. A.	207	Mazzeffi, M.	31
Lanfeard, D.	252	Luke, A. A.	192	Mazzone, S.	150
Langen, E.	215	Luna, M.	15	McBane, R.	138
Lankiewicz, J.	177	Lundquist, C.	195	McBrayer, M. A.	251
Larbi, L.	23	Lundquist, C. M.	111	McCabe, J. M.	107
Larsen MS, A.	282	Lutz, J.	195	McCaffery, J.	197, 5
Lawson, W. E.	142, 143	Luy, L.	282	McCaffrey, J.	113
Lawton, J.	31	Lyu, P.	128	McCarey, M.	285
Le, Q. T.	257	MacEwan, J. P.	146	McConnell, P.	112
Lee, E.	169	Mackenzie, T. A.	170, 171	McCullough, P. A.	101, 151
Lee, M.	26	MacLellan, A.	247	McDevitt, S.	160, 193
Lee, M.	241	Maddox, T. M.	192	McEwen PhD, M.	282
		Madut, D.	136	McGillen, B.	211
		Magdon-Ismael, Z.	212	McGranaghan, P.	178, 277

Author Index (continued)

McLaughlin, V.	160, 193	Najafi, B.	27	Patel, J.	204
McManus, D. D.	207, 209	Najararian, D.	225	Patel, K. K.	166
McMaster, K. S.	251	Nallamothe, B.	11, 158	Patel, M.	251
McNairy, M.	239	Nallamothe, B. K.	225	Patel, N.	226
McNamara, R.	102	Narasimhan, B.	269, 270	Patel, N.	163
McNamara, R. L.	103	Nasir, K.	135, 157, 281, 30	Patel, N.	19
McWilliams, M.	127	Nassir, R.	14	Patrick, W. L.	164
Medhane, F.	109	Nath, K.	11	Paulus, J.	195
Mehlman, A.	204	Nathan, A. S.	159, 217, 3, 4	Pavlo, A.	220
Mehta, A. A.	153	Nathan, S.	150	Peck, R.	239
Mehta, H. S.	151	Navathe, A.	159	Pena, H.	34
Meininger, G.	24	Negi, S.	102, 103	Pendyal, A.	165
Mellstrom, C.	291	Nensel, J. D.	20, 243	Peredo-Wende, R.	273
Mentz, R. J.	252	Neshewat, J.	193	Peri-Okonny, P.	2, 33
Meraz, R.	253	Neshewat, J. M.	160	Peri-Okonny, P. A.	166
Mercader, M.	109, 287	Nestasia, M.	115	Pesa, J. A.	290
Merritt, A.	141	Neumar, R.	158	Peters, G.	23
Messenger, J. C.	20, 243	Nguemeni Tiako, M.	255	Petersen, L. A.	117
Metkus, T. S.	254, 31	Ngufor, C. G.	11	Peterson, P.	232
Middleton, S.	189	Nguyen, O.	161	Peterson, T.	252
Miller, A.	154	Nguyen, T.	5	Pfeifer, L.	261
Miller, C.	155	Niegelberg, E.	143	Philippides, G.	242
Miller, R. J.	246	Nielson, R.	126	Philips, S.	167
Mobayed, J.	102, 103	Norris, M.	215	Phillips, E.	284
Moctezuma, S.	230	Noseworthy, P. A.	11	Pilote, L.	191
Modi, V.	16, 229	Nowalk, N.	137	Pimple, P.	168
Mohiuddin, A.	105	Ochoa, R. C.	194	Pina, I.	252
Mollenkopf, S.	151	Ochoa, T. C.	116	Pinheiro, L. C.	284
Montgomery, D.	228, 231, 236, 241, 244, 261	Oglat, H.	256	Platt, J.	158
Montpetit, M.	219	Ó Hartaigh, B.	283	Poe, G. L.	262
Moore, H.	144	Ohman, E. M.	249	Pogue, K. T.	120
Moore, K.	141	Old, W.	252	Pokorney, S. D.	274
Moore, K.	23	O'Leary, J.	201	Polimera, H.	211
Moore, L.	169	Olivier, C.	189	Pool PhD, N.	282
Moore, M.	264, 289	Olmstead, E. M.	171	Poornima, I. G.	115
Mora, J.	116	Olsthoorn, J.	114	Poretta, T.	138, 263
Morey, J. R.	156	O'Neill, K.	240	Poudel, R.	237, 238
Morgan, C. K.	265	Onyekwelu, C.	213	Power, J. E.	115
Morgan, S.	160, 193	Ouyang, D.	162, 22	Prasad, P.	117
Morrow, D.	254	Ozaki, A. F.	257	Preston, L.	190
Moskowitz, A. J.	156	Padooru, K.	214	Pugliese, S.	4
Moss, B.	265	Pan, X.	263	Pullatt, R.	126
Mostamand, M.	172	Panjrath, G.	109	Purington, N.	189
Mounsey, P.	169	Parikh, N.	182	Pursell, I. W.	169
Mszar, R.	157	Parikh, P.	142, 258, 259	Pyo, R.	142, 143
Mukherjee, R.	21	Parikh, P. B.	153	Qin, X.	198
Mungo, B.	239	Parikh, V.	204	Qing, Y.	115
Munoz, A.	267	Parish, D.	209	Qintar, M.	221
Muñoz, D.	201	Park, J. G.	111	Rab, S. T.	196
Munoz Estrella, A.	130, 131, 229, 230	Park, K.	182	Rader, D.	279
Murray, N.	247	Parker, C.	34	Radhakrishnan, A.	204
Mutharasan, R.	219	Parpas, A.	104	Raines, J. D.	20, 243
Myers, G.	154	Pastva, A. M.	260	Raitt, M.	144
Nagy, C.	113, 197, 5	Patel, A.	163, 204, 290	Raitt, M. H.	119
Nah, G.	182	Patel, C.	252	Rajan, P. V.	235
Naik, A. D.	27	Patel, D.	230	Rajpura, J.	210, 263
		Patel, H. J.	188	Raju, A.	168

Author Index (continued)

Ramamoorthy, V.	179	Sabharwal, B.	130, 173, 267	Sheth, S.	279
Raman, S.	4	Sacco, R. L.	183	Shetty, S.	168
Ramkumar, N.	170, 171	Sacks, N. C.	274	Shields, D. E.	13
Raparelli, V.	191	Saczynski, J.	209	Shields, T.	158
Razjouyan, J.	27	Sadic, E.	204	Shiffman, D.	280
Rea, T.	107	Safford, M. M.	284	Shin, D.	181
Ream, K.	243	Saito, E.	219	Shirazi, M.	109
Ream, K. S.	20	Salacata, A.	252	Shnall, J.	208
Reifenberger, M.	264	Salami, J.	178, 277	Shroyer, A.	258
Reiner, J.	5	Saleh, A.	174	Shroyer, A.	259
Reiner, J.	113, 197	Salenger, R.	31	Silverman-Lloyd, L. G.	278
Reps, J.	23	Salmoirago-Blotcher, E.	182	Sims, J.	266
Richards, C.	266	Sandhu, A. T.	175, 176	Simsek, I.	148
Richards, K.	265	San Gabriel, D.	275	Singer, D. E.	207
Ringel, J. B.	284	Saran, R.	11	Singh, A.	135, 281
Rivera, M.	125	Sattari, M.	182	Singh, K.	105
Roberts, M. B.	14	Satterfield, K.	158	Singh, S.	273
Robinson, E.	34	Saunders, R.	177	Siontis, K. C.	11
Robinson, S. B.	283	Saxena, A.	178, 179, 276, 277, 30	Skaf, M.	268, 269, 270
Rock, A.	149	Scharnott, M.	240	Slark, J.	275
Rodriguez, M.	194	Schena, S.	31	Smith, B. M.	107
Roger, V. L.	148	Schifferdecker, K. E.	101	Smolderen, K.	124
Rogers, J.	266	Schold, J. D.	147	Sobol, T.	186, 187, 28
Rogers, S.	102, 103	Scholes, A. M.	133, 35	Soffer, D.	279
Roldan, P.	29	Schuemie, M. J.	24	Sogade, F. O.	209
Romano, J. G.	183	Schulman, S.	254	Soliman-Hamad, M. A.	114
Romeiser, J.	258, 259	Schwamm, L. H.	212	Solola MD, S.	282
Rose, C. P.	145	Schwartz, B.	39	Solomon, A.	197
Rosemas, S.	266	Schwenke, D. C.	118	Sondergaard, M.	182
Rosenblatt, L.	110	Scirica, B. M.	190	Sorondo, B.	206, 214
Rosenblatt, L.	138, 210, 263	Sealy-Jefferson, S.	182	Southern, D. A.	246
Rosenthal, M. S.	165	Sears, S.	169	Southworth, M. R.	11
Rosenthal, N.	24	Secemsky, E. A.	1	Spatz, E.	37
Rosman, L.	119	Sedrakyan, A.	170	Spatz, E. S.	30
Ross, B. E.	134	Selby, A.	130, 173, 267	Spatz, E.	293
Ross, J.	216	Seliem, A.	143	Spaulding, E. M.	26
Ross, J. S.	11	Seo, G.	239	Spertus, J.	166, 196, 2
Rossman, P.	249	Serdynski, L.	262	Spertus, J. A.	132, 133, 35
Roth, D. L.	245	Setareh-Shenas, S.	194	Spertus, J.	293
Rouseff, M.	116	Shadyab, A.	182	Spring, S.	183
Rubens, M.	178, 179, 277	Shah, A. P.	150	Springer, J.	21
Rudofker, E.	20, 243	Shah, N. D.	11	Spyropoulos, A. C.	283
Rudolph, A.	34	Shah, N. N.	12	Stafkey-Mailley, D.	168
Ruiz, A.	116	Shah, R. U.	13, 21	Starling, R.	186, 187, 28
Rundek, T.	183, 277	Shahin, J.	27	Starosciak, A. K.	183, 227
Rush, P.	108	Shaikh, S.	105	Stebbins, A.	250
Russ, C.	110	Shan, R.	278	Steele, P.	144
Russ, C.	138, 210	Sharedalal, P.	226	Stefanick, M.	182
Ryan, A.	5	Sharma, A.	17	Steinberg, B. A.	21
Ryan, M.	151	Shashidhar, S.	189	Stephens, J.	186, 187
Ryan, P.	23	Shaw, L.	196	Stephens, R.	254
Ryan, P. B.	24	Shay, C.	237, 238	Sterling, M. R.	284
Rzechorzek, W.	130, 173, 194, 267, 268, 269, 270	Sheehan, O. C.	245	Stitzel, K.	237, 238
Saadat, M.	172	Sheeran, M.	180	Stokes, N.	184
Saad Shaukat, M.	199.1, 273	Shelley, D.	36	Stone PhD, J.	282
Saathoff, K.	262	Shen, C.	1, 233, 234, 3	Stopyra, J. P.	260
		Sheriff, S. B.	116	Strauss, C. E.	108

Author Index (continued)

Strom, J. A.	180	Valdiviezo, C.	182	Whooley, M. A.	119
Strom, J. B.	1	Valero-Elizondo, J.	157, 30	Wilbert, L.	142, 143
Stwalley, B.	263	Van Horn, L.	182	Wild, R.	224
Suckow, B. D.	170	Van Houten, J.	151	Willett, D.	167
Sud, K.	16, 230	van Veghel, D.	114	Williams, B.	290
Sullivan, J. A.	134	Vasudev, R.	126	Williams, M.	208
Sun, D.	24	Vekima, N.	206	Williams, M. L.	164
Sun, Y.	293	Veledar, E.	178, 179, 276, 277	Williamson, T.	195
Sunder, V.	285	Velez, D.	37	Wilson, A.	247
Sunjic, I.	204	Vemulapalli, S.	250	Wilton, S. B.	246
Suplee, E.	34	Venkateswaran, R. V.	190	Winchester, D. E.	248
Svensson, L.	28	Ventline, B.	218	Witt, S.	108
Sweitzer MD, PhD, N.	282	Verta, P.	151	Wittbrodt, E.	291
Tabak, S.	196	Vigen, R.	15	Wong, N.	291
Tabit, C. E.	150	Villablanca-Spineto, P.	213	Woo, L.	104
Taklalsingh, N.	185, 286	Vincent, L.	125	Wood, D. R.	274
Talreja, D.	121	Virani, S.	157	Wooldridge, D.	33
Talreja, R.	121	Virani, S. S.	27	Wu, L.	230, 292
Tamis-Holland, J.	130, 173, 267	Vittinghoff, E.	182	Wu, W. C.	118
Tang, Y.	166, 33	Voss, E. A.	24	Wu, X.	188
Tantry, U.	32	Vyas, A.	32	Wu, X.	293
Tarasovsky, G.	119	Wadhera, R. K.	1, 233, 234	Wygant, G.	263
Tarsilo, M.	223	Wali, M.	191	Xie, F.	198
Tasissa, G.	252	Waljee, A.	225	Xie, J.	196
Tataronis, G.	242	Walker, T.	289	Yager, N.	199.1, 203
Tayeb, T. M.	287	Walsh, K.	239	Yan, X.	293
Taylor, B.	31	Wang, B.	198	Yancy, C. W.	219
Telukuntla, K.	186, 187, 28	Wang, C.	283	Yanek, L. R.	278
Temesgen, N.	109	Wang, C.	162	Yang, B.	188
Tertulien, T.	14	Wang, G. C.	251	Yang, W.	26
Thomas, B.	121	Wang, K.	183	Yao, X.	11
Thomas, C.	108	Wang, L.	23, 24	Yardley, K.	249
Thomas, F.	25	Wang, N.	134	Yee BS, E.	282
Thomas, K.	154, 262	Wang, S. C.	134	Yeh, R. W.	1, 235, 3
Thomas, K.	136	Wang, X.	198	Yen, A.	162
Thomas, M.	33	Wang, X.	192	Yost, K.	148
Thomas, T.	34	Wang, X.	199, 263	Yount, S. E.	101
Thompson, A.	11	Wang, X.	293	Yuan, Z.	23, 24
Thompson, M. P.	188	Wang, Y.	198	Yuce, H.	138
Thourani, V.	250	Wang, Y.	1	Yue, B.	130, 173, 267
Threlkeld, Z.	247	Wang, Z.	199	Yunus, R.	113, 197, 5
Tian, T.	178	Waring, M. E.	209	Zabala BS, L.	282
Tomei, J.	240	Warner, P. B.	13	Zaha, V.	167
Torabzadehkhosrassani MS, E.	282	Wasfy, J. H.	1	Zbydniowski, S.	201
Torosoff, M.	202, 256, 273	Washington, T.	169	Zevallos, J.	183
Towery, D.	211	Wasserman, A.	160, 193	Zhang, H.	293
Trisini Lipsanopoulos, A. T.	207	Weaver, J.	24	Zhang, L.	199
Trumpower, B.	225	Weerakoon, S.	109	Zhang, M.	188
Tudor, G.	206	Weininger, D.	130, 173, 194, 267	Zhang, T.	198
Turakhia, M. P.	119	Weinstein, D.	160, 193	Zhang, Z.	198, 199
Turakhia, M.	189	Weintraub, W. S.	199	Zhao, L. M.	146
Uchino, K.	147	Wengrofsky, P.	185, 286	Zheng, C.	199
Ullah, A.	104	Wessler, B. S.	111, 195	Zheng, X.	293
Urban, S.	251	Weston, S.	148	Zhu, S.	139
Vader, J. M.	192	Whellan, D.	285	Ziaean, B.	294
Vadlamani, L.	288	Whitman, G. J. R.	31	Zou, J.	162, 22



American
Heart
Association®

Membership provides you...

- Savings on registration for AHA Scientific Meetings
- The opportunity to apply for AHA research grants (only members can apply)
- Savings on OnDemand Sessions and Stroke programs
- Access to all 11 AHA scientific journals online
- 50+ opportunities annually for networking
- Complimentary/discounted online education offerings for CME/CE credit
- The path to becoming a Fellow of the American Heart Association (FAHA)
- Volunteer opportunities such as becoming peer reviewers, journal reviewers and more!

Learn more and join us at
professional.heart.org/membership

Cardiovascular diseases afflict people of all races, ethnicities, genders, religions, ages, sexual orientations, national origins and disabilities. The American Heart Association is committed to ensuring that our workforce and volunteers reflect the world's diverse population. We know that such diversity will enrich us with the talent, energy, perspective and inspiration we need to achieve our mission: building healthier lives, free of cardiovascular diseases and stroke.

For information on upcoming
American Heart Association
Scientific Conferences,
visit **professional.heart.org**



American Heart Association.
Quality of Care &
Outcomes Research

National Center
7272 Greenville Avenue
Dallas, Texas 75231-4596

©2019, American Heart Association, Inc.
All rights reserved. Unauthorized use prohibited. 2/19JN0944