

Contents

Abstract Information	9
Author Index.....	43
Conference Awards	10
Conference Highlights	9
Faculty.....	3
General Information	7
Hotel Map	5
Policy Information	11
Poster Presentations	16
Program Agenda	12
Sunday, April 2	12
Monday, April 3.....	12
Program Committee	2
Room Locator	6
Speaker Resource Desk	9

Questions and Information

If you have questions about this program, contact the American Heart Association National Center, Dallas, Texas:

Telephone 888-242-2453 (inside the United States)
 214-570-5935 (outside the United States)

Fax 214-373-3406

Email scientificconferences@heart.org

Website professional.heart.org

Professional Membership Customer Service

Wolters Kluwer

Telephone 800-787-8984 (inside the United States)
 301-223-2307 (outside the United States)

Fax 301-223-2327

Email ahaonline@lww.com

*The American Heart Association is a national voluntary health agency whose mission is:
"Building healthier lives, free of cardiovascular diseases and stroke."*



The American Heart Association would like to acknowledge the following companies for their generous support of the Quality of Care and Outcomes Research in CV Disease and Stroke 2017 Scientific Sessions:

Pfizer, Inc.

The American Heart Association is grateful to the members of the Program Committee for their dedication and leadership in planning the program.

QCOR 2017 Program Committee

Mikhail Kosiborod, MD, FACC, FAHA, Conference Chair, Mid-American Heart Institute/UMKC, Kansas City, Kansas City, Missouri
Adrian F. Hernandez, MD, MHS, FAHA, Conference Vice-Chair, Duke University Medical Center, Durham, North Carolina
Suzanne Arnold, MD, MHA, Saint Luke's Mid America Heart Institute/University of Missouri-Kansas City, Kansas City, Missouri
William B. Borden, MD, FAHA, George Washington University, Washington, District of Columbia.
Ralph G. Brindis, MD, MPH, MACC, FSCAI, University of California-San Francisco, San Francisco, California
Joseph C. Cleveland, Jr., MD, University of Colorado Anschutz Medical Center, Aurora, Colorado
Lesley H. Curtis, PhD, Duke Clinical Research Institute, Durham, North Carolina
Nehar Desai, MD, MPH, Yale Internal Medicine-Cardiology, New Haven, Connecticut
Kumar Dharmarajan, MD, MBA, Yale School of Medicine, New Haven, Connecticut
Shannon Dunlay, MD, MS, Mayo Clinic, Rochester, Minnesota
T. Bruce Ferguson, Jr., MD, East Carolina University, Greenville, North Carolina
Elizabeth A. Jackson, MD, MPH, FACC, FAHA, University of Michigan Health Systems, Ann Arbor, Michigan
Patricia Kearney, MD, University College Cork, Cork, Ireland
David Maron, MD, Stanford University, Stanford, California
Pamela Peterson, MD, MSPH, Denver Health Medical Center, Denver, Colorado
Deborah (Debbie) Summers, MSN, RN, ACNS-BC, CNRN, SCRNP, Saint Luke's Hospital of Kansas City, Kansas City, Missouri



Circulation: Cardiovascular Quality and Outcomes

An American Heart Association Journal

Dedicated to promoting safe, effective, efficient, equitable, timely, and patient-centered care.

EDITOR
Brahmajee K. Nallamothu, MD, MPH

WEBSITE
circoutcomes.ahajournals.org

MANUSCRIPT SUBMISSION SITE
circoutcomes-submit.aha-journals.org

PUBLISHING METRICS
www.ahajournals.org/site/metrics



Rapid Publication Online
Open Access Options for Original Research

Through its articles and contributions, *Circulation: Cardiovascular Quality and Outcomes* equips you with the knowledge you need to improve clinical care and population health, and allows you to engage

 New Twitter Journal Club — Follow along with **#outcomesjc**

Faculty

Nancy Albert, PhD, RN, FAHA, Cleveland Clinic, Cleveland, Ohio
Larry Allen, MD, University of Colorado, Aurora, Colorado
Suzanne Arnold, MD, MHA, Saint Luke's Mid America Heart Institute, Kansas City, Missouri
William Borden, MD, George Washington University, Washington, District of Columbia
Robert Califf, MD, (Former Commissioner, Food & Drug Administration) Duke University, Durham, North Carolina
David Cohen, Saint Luke's Mid America Heart Inst, Kansas City, Missouri
Jacqueline Corrigan-Curay, JD, MD, Food and Drug Administration, Silver Spring, Maryland
Gregory Daniel, PhD, MPH, RPh, Duke – Robert J. Margolis, MD, Ctr for Health Policy, Washington, District of Columbia
Sandeep Das, MD, MPH, UT Southwestern, Dallas, Texas
Carole J Decker, PhD RN, CPHQ, Mid America Heart Institute, Kansas City, Missouri
Kumar Dharmarajan, MD, MBA, Yale School of Medicine, New Haven, Connecticut
Michael Engelgau, MD, National Heart, Lung, and Blood Institute, Bethesda, Maryland
David Goff, MD, PhD, FAHA, FACP, NIH, Bethesda, Maryland
Paul Heidenreich, MD, MS, Palo Alto VA Medical Center, Palo Alto, California
Adrian Hernandez, MD, Duke University, Durham, North Carolina
Michael Ho, MD, University of Colorado, Aurora, Colorado
Karen Joynt, MD, Brigham and Women's Hospital, Boston, Massachusetts
Sana M. Al-Khatib, MD, Duke Univ, Durham, North Carolina
Umesh Khot, MD, Cleveland Clinic, Cleveland, Ohio
Ruth Kleinpell, RN, PhD, FAAN, CCRN, Rush University, Chicago, Illinois
Mikhail Kosiborod, MD, Saint Luke's Mid America Heart Institute, Kansas City, Missouri
Harlan Krumholz, MD, SM, FAHA, Yale University School Medicine, New Haven, Connecticut
Julie Lesch, MPA, PCORI, Washington, District of Columbia
Thomas Maddox, MD, University of Colorado, Aurora, Colorado
Marilyn Mann, Kensington, Maryland
Frederick Masoudi, MD, University of Colorado Anschutz Medical Campus, Aurora, Colorado
Daniel Matlock, MD, MPH, University of Colorado, Aurora, Colorado
Colleen McIlvannan, DNP, University of Colorado, Aurora, Colorado
William Murray, Medical Device Innovation Consortium, Minneapolis, Minnesota
Brahmajee Nallamothu, MD, MPH, Ann Arbor Veterans Affairs Medical Center, Ann Arbor, Michigan
Sharon-Lise Normand, PhD, Harvard Medical School, Boston, Massachusetts
Emily O'Brien, PhD, Duke Clinical Research Institute, Durham, North Carolina
Sara Rosenbaum, JD, George Washington University, Washington, District of Columbia
Kori Sauser-Zachrisson, MD, MSc, Massachusetts General Hospital, Boston, Massachusetts
David Schopfer, MD, San Francisco VA Medical Center, San Francisco, California
Rashmee Shah, MD, University of Utah, Salt Lake City, Utah
John Spertus, MD, MPH, FACC, Mid America Heart Institute, Kansas City, Missouri
Debbie R. Summers, MSN, ACNS-BC, CNRN, CCRN, Saint Luke's Hospital, Kansas City, Missouri
Tracy Wang, MD, MHSc, Duke University, Durham, North Carolina
Jason Wasfy, MD, Massachusetts General Hospital, Boston, Massachusetts
Gail Wilensky, PhD, Project HOPE, Bethesda, Maryland

Abstract Reviewers

The conference organizers gratefully acknowledge the following individuals for their assistance with the abstract grading process:

Larry A. Allen, MD, University of Colorado School of Medicine, Aurora, Colorado
Suzanne Arnold, MD, MHA, Saint Luke's Mid America Heart Institute, Kansas City, Missouri
Geoffrey Barnes, MD, University of Michigan, Ann Arbor, Michigan
John Beltrame, MD, University of Adelaide, Adelaide, Australia
William B. Borden, MD, Weill Cornell Medical College, New York, New York
Ralph Brindis, MD, University of California-San Francisco, San Francisco, California
John Brush, MD, Cardiology, Norfolk, Virginia
Emily Bucholz, Yale University, New Haven, Connecticut
Alanna Chamberlain, PhD, Mayo Clinic, Rochester, Minnesota
Adnan Chhatiwalla, MD, Saint Luke's Mid America Heart Institute, Kansas City, Missouri
Joseph Cleveland, MD, UCD Cardiothoracic Surgery, Aurora, Colorado
David Cohen, MD, Saint Luke's Mid America Heart Institute, Kansas City, Missouri
Lawton Cooper, MD, MPH, NHLBI, Bethesda, Maryland
Lesley Curtis, MD, Duke University, Durham, North Carolina
Carole Decker, RN, PhD, Mid America Heart Institute, Kansas City, Missouri
Shannon Dunlay, MD, Mayo Clinic Rochester, Rochester, Minnesota
Zach Goldberger, MD, University of Washington, Seattle, Washington
Philip Goodney, MD, Dartmouth Hitchcock Medical Center, Lebanon, New Hampshire
Michael Ho, MD, PhD, Colorado Health Outcomes, Aurora, Colorado
Cynthia Jackevicius, PharmD, MSc, Western University of Health Sciences and University of Toronto, Pomona, California
W. Schuyler Jones, MD, Duke University Medical Center, Durham, North Carolina
Karen Joynt, MD, Brigham and Women's Hospital, Boston, Massachusetts
Dharam Kumbhani, MD, UT Southwestern, Dallas, Texas
David Lanfear, MD, Henry Ford Hospital, Detroit, Michigan
Donald Likosky, PhD, University of Michigan, Ann Arbor, Michigan
Thomas Maddox, MD, University of Colorado Health Science Center, Aurora, Colorado
David Malenka, MD, Dartmouth Hitchcock Medical Center, Lebanon, New Hampshire
Frederick Masoudi, MD, MSPH, FAHA, University of Colorado, Aurora, Colorado
Khurram Nasir, MD, MPH, Johns Hopkins, Baltimore, Maryland
Colleen M. Norris, RN, PhD, FAHA, University of Alberta Hospitals, Edmonton, Alberta, Canada
Pam Peterson, MD, Denver Health Medical Center, Denver, Colorado
Kristi Reynolds, PhD, MPH, Kaiser Permanente, Pasadena, California
Kim Smolderen, PhD, Mid America Heart and Vascular Institute, Kansas City, Missouri
Debbie Summers, RN, MSN, FAHA, ARNP, Saint Luke's Hospital, Kansas, Missouri
Javier Valle, MD, University of Colorado, Aurora, Colorado
Paul Varosy, MD, University of Colorado, Aurora, Colorado
Salim Virani, MD, PhD, Michael E. DeBakey Veterans Affairs Hospital and Baylor College of Medicine, Houston, Texas
Tracy Wang, MD, MHSc, Duke University, Durham, North Carolina
Ying Xian, MD, PhD, Duke University, Durham, North Carolina

Hotel Map

CONFERENCE LEVEL

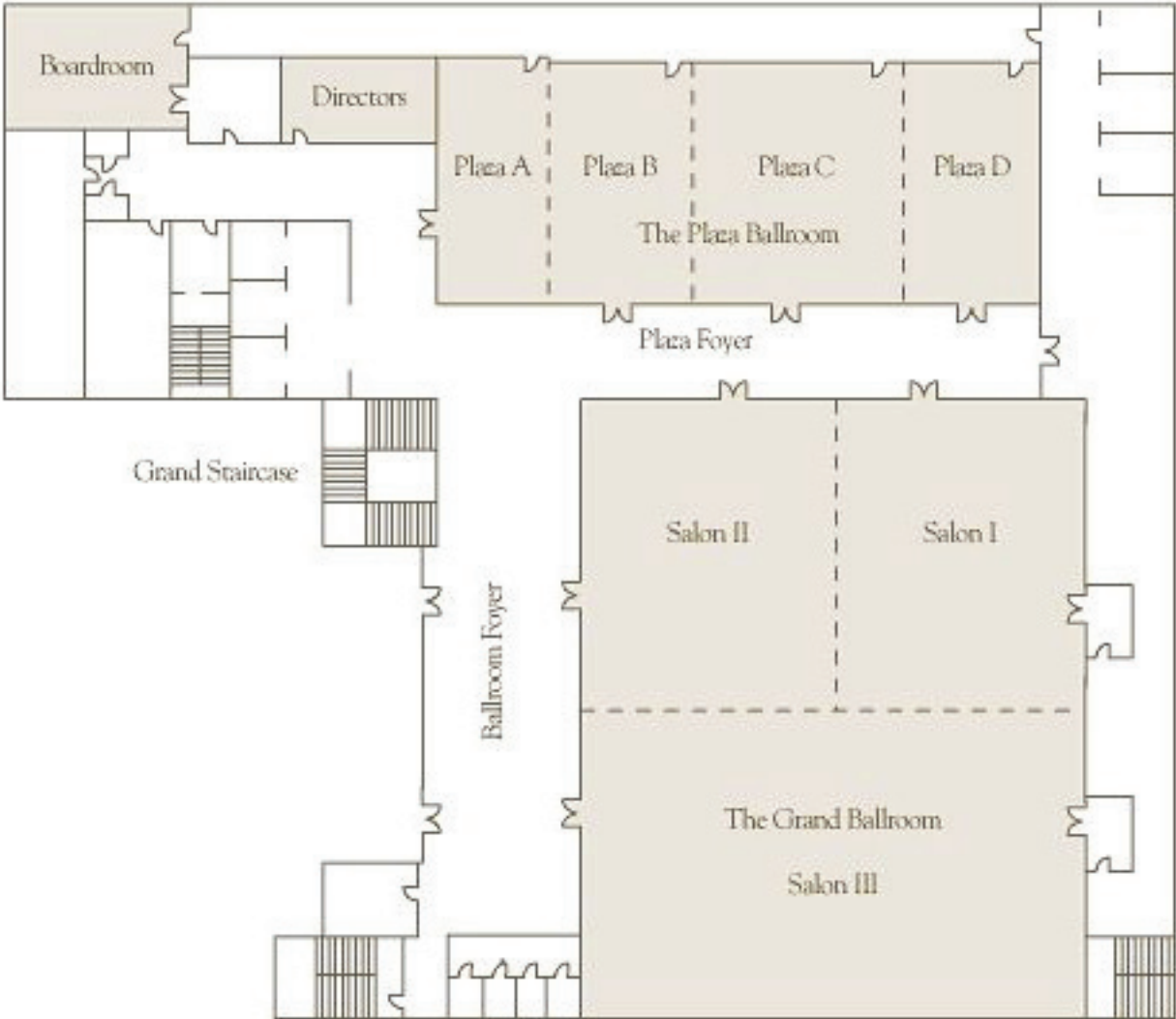

Room Locator

All Conference	
Meeting Name	Hotel Location
Conference Registration and Information	Ballroom Foyer
Exhibits	Ballroom Foyer
Speaker Resource Desk	Ballroom Foyerr

Sunday, April 2		
Time	Meeting Name	Hotel Location
1:00–5:00 PM	Quality of Care Workshop	Plaza C and D
5:00–6:30 PM	Poster Session I	Salon I and II
6:30–9:30 PM	QCOR Council Dinner	Salon III

Monday, April 3		
Time	Meeting Name	Hotel Location
7:00–8:30 AM	Early Career Roundtable Breakfast Session	Plaza B
8:30–9:00 AM	Conference Welcome and Opening	Salonn III
9:00–10:15 AM	Plenary I Real World Evidence Generation in the 21st Century	Salon III
10:15–10:45 AM	Break and Exhibits	Ballroom Foyer
10:45 AM–12:00 PM	Concurrent Session I Implementation Science	Plaza C and D
10:45 AM–12:25 PM	Abstract Oral Session I QCOR 2017 Young Investigator Awards	Salon III
12:45–2:00 PM	Career Development Lunch	Plaza B
12:30–2:00 PM	Poster Session II	Salon I and II
2:00–3:15 PM	Concurrent Session II Circ: CQO Town Hall	Plaza C and D
2:00–3:15 PM	Abstract Oral Session II General	Salon III
3:15–3:45 PM	Break and Exhibits	Ballroom Foyer
3:45–5:00 PM	Plenary II The Future of Health Care Policy	Salon III

General Information

Program Description

Participants in the Quality of Care and Outcomes Research (QCOR) in Cardiovascular Disease and Stroke 2017 Scientific Sessions play a major role in efforts to improve the quality of cardiovascular medical care and patient outcomes. It is the only major international meeting focused on cardiovascular issues in which clinical researchers interact in a meaningful way with policy makers and quality outcomes experts. The confluence of these three players is critical in today's changing healthcare environment, in which quality and cost issues can no longer be divorced from the clinical care provided or from patient outcomes.

The quality improvement efforts that form the core of QCOR 2017 include an exploration of the future directions for the U.S. healthcare system and the impact on cardiovascular disease management, as well as the role of real-world evidence (RWE) generation for drugs and devices in the current regulatory environment. The target audience for this educational activity includes clinicians, researchers, medical students and trainees, nurses, pharmacists, administrators, healthcare and managed care professionals, policymakers and other healthcare professionals interested in quality of care and outcomes research in cardiovascular disease and stroke.

Learning Objectives

At the completion of this program, attendees should be able to:

1. Discuss the potential for focused quality improvement efforts to reduce variation, spread innovation and significantly improve the quality of care in the cardiovascular arena, including identifying the key components of all such efforts.
2. Discuss MACRA and its two payment models, understand how to prepare for success in the four performance categories (quality, resource use, clinical practice improvement activities, and advancing care information), implement strategies to report under MIPS, examine the associated incentives and penalties, and understand the steps needed to begin the path to APMs.
3. Identify different sources for RWE, describe the benefits of the use of RWE to guide clinical practice, discuss the challenges in generating RWE, understand the drivers of RWD policy and practice and discuss the implications associated with the use of RWE.
4. Recognize opportunities to address identifiable, behavioral and biological risk factors for CVD to meet the AHA definition of ideal cardiovascular health.

Registration

Registration is located in the Ballroom Foyer in the Ritz-Carlton Pentagon City. Registration is open throughout the conference. All conference attendees (including abstract presenters and speakers) must be registered to participate in the conference.

Registration Hours:

Sunday	April 2, 2017	11:00 AM–7:00 PM
Monday	April 3, 2017	7:00 AM–5:00 PM

CME/CE Information

The American Heart Association is accredited by the American Nurses Credentialing Center (ANCC), the Accreditation Council for Pharmacy Education (ACPE), and the Accreditation Council for Continuing Medical Education (ACCME), to provide continuing education for the healthcare team.

Continuing Medical Education Accreditation – Physicians

This activity has been planned and implemented in accordance with the Essential Areas and policies of the Accreditation Council for Continuing Medical Education. The American Heart Association is accredited by the ACCME to provide continuing medical education for physicians.

The American Heart Association designates this live activity for a maximum of 11.00 *AMA PRA Category 1 Credits*[™]. Physicians should claim only the credit commensurate with the extent of their participation in the activity.

Continuing Medical Education Accreditation – Physician Assistants

AAPA accepts certificates of participation for educational activities certified for *AMA PRA Category 1 Credit*[™] from organizations accredited by ACCME or a recognized state medical society. Physician assistants may receive a maximum of 11.00 hours of Category I credit for completing this program.

General Information

Continuing Education Accreditation – Nurse Practitioners

American Academy of Nurse Practitioners (AANP) accepts *AMA PRA Category 1 Credit™* from organizations accredited by the ACCME.

***AMA Credit must be claimed within 6 months of attendance. Credit will no longer be available to claim after October 3, 2017.*

Continuing Education Accreditation – Nurses

The maximum number of hours awarded for this CE activity is 11.00 contact hours.

***ANCC Credit must be claimed within 6 months of attendance. CME/CE will no longer be available to claim after October 3, 2017.*

Continuing Education Accreditation – Pharmacists

The American Heart Association is accredited by the Accreditation Council for Pharmacy Education as a provider of continuing pharmacy education. ACPE Credit: ____ Contact Hours or ____ CEUs. Universal Program Number: XXXXXXXX. Successful completion of this CME/CE activity includes the following: (1) Attend the program lecture and/or poster sessions. (2) Complete the activity evaluation survey and claim CME/CE credit online at learn.heart.org. (3) Statements of credit may be printed on your printer following completion of the required information. There is no fee for continuing education credits for this activity.

Steps for Successful Completion

To successfully complete this activity, learners must fully participate in the sessions. Learners also must provide feedback that will be used for evaluative and outcomes measurement. Learners will check in on site for attendance verification purposes and will be required to provide evaluative feedback before CME/CE credit can be claimed.

Disclosure

All persons who develop and/or control educational content in CME/CE activities provided by the American Heart Association will disclose to the audience all financial relationships with any commercial supporters of this activity as well as with other commercial interests whose lines of business are related to the CME/CE-certified content of this activity. In addition, presenters will disclose unlabeled/unapproved uses of drugs or devices discussed in their presentations. Such disclosures will be made in writing in course presentation materials.

Obtain Accreditation Certificate

1. Go to <http://learn.heart.org>.
2. Sign in with your username and password.
 - a. If you have an existing account on our Professional site (i.e., you registered online), please enter that username and password.
 - b. If you do not have an existing account with us, please create one on <http://learn.heart.org>.
 - c. If you do not remember your username and password, please click the “Forgot Username/Password?” link on the log in page. Enter your first name, last name and email address in the spaces provided and your account information will be emailed to you. You may also call 1-888-242-2453 (8 a.m.-5 p.m. Central Standard Time) for assistance.
3. Find the course under delivery method/Conferences, Workshops and Symposia.
4. Select to enroll.
5. Authorization code is with your conference badge materials.
6. Click submit now.
7. Once enrolled, the course will go into your “my courses” tab.
8. Launch the course.
9. Click on the evaluation survey link and submit your answers; this must be completed to claim CME/CE.
10. Click on the Claim CME/CE credit link.
11. Select the type of certificate you need from the drop-down menu.
12. Enter your time spent at the conference in hours and click update.
13. Claim and print your certificate.
14. Your course will be moved to “My Transcript” and will remain there for future reference.

For customer support, please contact our Service Center at 1-888-242-2453 (8:00 AM–5:00 PM Central Standard Time) or email learn@heart.org.

Information for Presenters

Abstract Information

Abstracts presented at the Quality of Care and Outcomes Research 2017 Scientific Sessions will be published in *Circulation: Cardiovascular Quality and Outcomes*, an AHA journal. To access this information, please go to professional.heart.org.

Abstracts 1–10 will be presented as oral presentations throughout the conference.

Abstracts 11 and above will be presented as follows:

Sunday, April 2, 5:00–6:30 PM	Poster Session I	Abstracts 11-137
Monday, April 3, 12:30–2:00 PM	Poster Session II	Abstracts 130–260

All poster sessions will be held in Salon I and II.

Abstract poster presenters are asked to comply with the setup and tear-down schedule shown below:

Poster Session Date	Presentation Time	Attendance Time	Setup Time	Tear-Down Time
Session I, Sunday, April 2	5:00–6:30 PM	5:00–6:30 PM	3:00–5:00 PM	6:30–7:30 PM
Session II, Monday, April 3	12:30–2:00 PM	12:30–2:00 PM	10:30 AM–12:30 PM	2:00–3:00 PM

Speaker Resource Desk

The Speaker Resource Desk is in the Ballroom Foyer in the Ritz-Carlton. Speakers are asked to deliver their presentations by email to the conference manager. Speakers may review and finalize their presentations on site. **It is imperative that you review your presentation at the Speaker Resource Desk if it contains video files or was created on a Mac computer. Staff will be on hand to assist with technical issues.**

Speaker Resource Room Hours:

Sunday, April 2	Monday, April 3
11:00 AM–7:00 PM	6:00 AM–5:00 PM

Conference Highlights

Don't miss the following speakers at QCOR 2017:

- David Goff Jr., MD, PhD, NHLBI Division of Cardiovascular Sciences
 - William Murray, Medical Device Innovation Consortium
 - Jacqueline Corrigan-Curay, JD, MD, Office of Medical Policy, Food & Drug Administration
 - Robert Califf, MD, Duke University
 - Gregory Daniel, Duke-Robert J. Margolis, MD, Ctr for Health Policy
 - Gayle Wilensky, PhD, Project HOPE
 - Sara Rosenbaum, JD, George Washington University
 - Sean Cavanaugh, Center for Medicare
 - And much, much more!
- QCOR Lifetime Achievement Award — Dr. Sharon-Lise Normand is the 2017 recipient of this award, and will be a keynote speaker at the Council dinner
 - QCOR Council Dinner
 - Quality of Care Workshop: Patient Centered Care: Enhancing Engagement, Optimizing Outcomes
 - Early Career Breakfast and Early Career Development Luncheon
 - Poster Sessions with Poster Professors

Council Dinner

At 6:30 PM Sunday, join us for dinner with the council. The keynote speaker will be Dr. Sharon-Lise Normand, Harvard Medical School, Boston, Massachusetts, recipient of this year's Recognition of 2017 QCOR Outstanding Achievement Award. Tickets may be purchased in advance at the AHA registration desk.

Exhibits

Please visit our exhibitors in the foyer area during breaks throughout the conference. The full list of exhibitors is provided at the conference registration desk.

Conference Awards

The AHA Council on Quality of Care and Outcomes Research Recognition of Outstanding Achievement Award



Sharon-Lise Normand, PhD

Harvard Medical School, Boston, Massachusetts

The award is presented to Dr. Sharon-Lise Normand for her significant long-term contribution to outcomes research and the improvement of cardiovascular care. Normand will be honored at the QCOR council dinner at 6:30 PM on Sunday in Salon III.

Young Investigator Abstract Award

The award recognizes contributions of young investigators in cardiovascular outcomes research. The five finalists' highly rated abstracts will be presented during a special oral abstract session at 10:45 AM–12:30 PM on Monday. The winner will be announced at the Career Development Luncheon to follow.

The finalists, listed in order of presentation, are:

1. **Yuan Lu**, Yale University, New Haven, Connecticut
2. **Victor Okunrintemi**, Baptist Health South Florida, Miami, Florida
3. **Krishna K. Patel**, Saint Luke's Mid America Hear Institute, Kansas City, Missouri
4. **Eric Y. Shin**, Emory University, Atlanta, Georgia
5. **Xiaoting Wu**, University of Michigan, Ann Arbor, Michigan

Council Early Career Investigator Travel Stipend Awards

The awards provide travel support to the most outstanding early career investigator and trainee members of the council who are presenting research at the meeting and encourage and enable young investigators, graduate students, women and under-represented minority participation in council and AHA activities.

Presentation/ Poster Board No.	Name	Day/Time	Session Title
10	LaPrincess Brewer	Sunday, 5:00–6:30 PM	Poster Session I
54	Anna Grodzinsky	Sunday, 5:00–6:30 PM	Poster Session I
6	Sameed Ahmed M. Khatana	Monday, 2:00–2:15 PM	Abstract Oral Session: General
39	Maulik D. Majmudar	Sunday, 5:00–6:30 PM	Poster Session I
18	Michael P. Thompson	Sunday, 5:00–6:30 PM	Poster Session I
78	Gladys P. Velarde	Sunday, 5:00–6:30 PM	Poster Session I

Policy Information

Disclaimer

The Quality of Care and Outcomes Research in Cardiovascular Disease and Stroke 2017 Scientific Sessions is a scientific and educational conference for exchanging and discussing research results and scientific developments in cardiovascular outcomes research. Accordingly, the American Heart Association cannot and does not offer any assurance or warranty of the accuracy, truthfulness or originality of the information presented at the conference.

Embargo Guidelines

Abstracts, lectures and presentations in QCOR 2017 are embargoed for release at the time of presentation. Information may not be released before the scheduled presentation time.

Photography/Recording Policy

Unauthorized recording of the AHA Scientific Sessions, scientific conferences and the ASA International Stroke Conference is prohibited, whether by video, still or digital photography, audio or any other recording or reproduction mechanism. This includes recording of presentations and supporting audio-visual materials, poster presentations and supporting poster materials.

The American Heart Association and America Stroke Association reserve the rights to all recordings or reproductions of presentations at AHA/ASA scientific conferences and meetings. Check the program for information about the availability of videotapes or audiotapes for purchase. Exceptions to this policy prohibition are:

1. Non-flash photography of the speaker and his/her presentation materials is permitted by attendees or AHA/ASA accredited reports upon the prior written consent of the AHA/ASA and of the speaker.
2. Audiotape recording for strictly personal and non-commercial use is permitted if not disruptive; and exhibitors may photograph their own booth for promotional purposes upon prior written consent of the AHA/ASA.

Conference Photography

Please be aware that during QCOR 2017, attendees, vendors and guests may be photographed and videotaped by AHA vendors in capturing the event. Some of these photographs or videos may be displayed by the AHA in future publications or materials connected with the event. If you do not wish your image to be displayed by the AHA, please contact the AHA in writing at 7272 Greenville Avenue, Dallas, TX 75231, Attention: Manager, Scientific Conferences, QCOR 2017 Scientific Sessions, no later than April 15, 2017.

No-Smoking Policy

AHA policy prohibits smoking in conference meeting rooms and exhibits/registration areas. Thank you for your cooperation.

Seating/Badge Requirement

Seating is on a first-come, first-served basis. According to fire code, a session must be closed if the room fills to capacity. You must wear your name badge at all times during the symposium. Nonregistered guests may not be permitted into the sessions or food and beverage events. Be sure to remove your badge when you leave the conference or your hotel room.

The American Heart Association reserves the right to revoke or deny attendance to any registered participant, speaker, exhibitor, news media reporter, or photographer of presentations or activities at AHA/ASA scientific conferences and meetings.

Program Agenda

SUNDAY/MONDAY

SUNDAY, APRIL 2

11:00 AM–7:00 PM
Registration Open
Ballroom Foyer

1:00–5:00 PM
Quality of Care Workshop
Patient-centered Care – Enhancing Engagement, Optimizing Outcomes
Plaza C and D

**Free for conference attendees*
***\$75 members/\$100 nonmembers to attend workshop only*

Moderators:
 Debbie R. Summers, Saint Luke’s Hospital, Kansas City, MO
 Carole J. Decker, Mid-America Heart Institute, Kansas City, MO

- 1:00 **Welcome and Introduction**
Debbie R. Summers, Saint Luke’s Hospital, Kansas City, MO
- 1:05 **Disseminating Patient-Centered Outcomes Research to Healthcare Professions**
Ruth Kleinpell, Rush University, Chicago, IL
- 1:55 **Enhancing Patients and Stakeholders Engagement: Lessons Learned**
Julie Lesch, PCORI, Washington, DC
- 2:45 **Intermission/Break**
- 3:00 **Patient Engagement Strategies**
Nancy Albert, Cleveland Clinic, Cleveland, OH
- 3:45 **Organizing and Executing Patient Engagement in Clinical Research**
Umesh Khot, Cleveland Clinic, Cleveland, OH
- 4:30 **Speaker Panel Q&A/Discussion**

5:00–6:30 PM
Poster Session I
Salon I and II

Poster Board Number 1- 128
 Presentation Numbers 11-137

6:30–9:30 PM
QCOR Council Dinner and Recognition of the 2017 Recipient of the Outstanding Achievement Award Winner*
Salon III
**Ticketed event.*

Keynote Lecture
Dr. Sharon-Lise Normand,
 Harvard Medical School, Boston, MA

MONDAY, APRIL 3

7:00 AM–5:00 PM
Registration Open
Ballroom Foyer

7:00–8:30 AM
Early Career Roundtable Breakfast Session*
Plaza B
**Ticketed event. Space is limited.*

Title	Author Block
Table I	Tracy Wang, Duke University Durham, NC
Table I	Rashmee U. Shah, University of Utah, Salt Lake City, UT
Table II	Dan Matlock, University of Colorado, Aurora, CO
Table II	Colleen K. McIlvannan, University of Colorado, Aurora, CO
Table III	Frederick A. Masoudi, University of Colorado Anschutz Medical Campus, Aurora, CO
Table III	Kori Sauser, Massachusetts General Hospital, Boston, MA
Table IV	John Spertus, Mid America Heart Institute, Kansas City, MO
Table IV	Emily C. O’Brien, Duke Clinical Research Institute, Durham, NC
Table V	Suzanne V. Arnold, Saint Luke’s Mid America Heart Institute, Kansas City, MO
Table V	David Schopfer, San Francisco VA Medical Center, San Francisco, CA
Panelist	Sana M. Al-Khatib, Duke University, Durham, NC

8:30–9:00 AM
Conference Welcome and Opening Session
Salon III

- 8:30 **Opening Remarks from the Conference Chair**
Mikhail Kosiborod, Mid-American Heart Institute/UMKC, Kansas City, MO
- 8:35 **Welcome Remarks from AHA President (Pre-recorded video)**
Steven R. Houser, Temple University School of Medicine, Philadelphia, PA
- 8:35 **Strategic Vision and Key Priorities for NHLBI Cardiovascular Sciences Division**
David C. Goff, National Institutes of Health, Bethesda, MD

Program Agenda (continued)

9:00–10:15 AM

Plenary I

Real World Evidence Generation in the 21st Century

Salon III

Moderators:

Adrian Hernandez, Duke University, Durham, NC

Harlan Krumholz, Yale University, New Haven, CT

9:00 **Imagining Evidence Generation in the 21st Century**

Robert Califf, (Former Commissioner, Food and Drug Administration), Duke University, Durham, NC

9:15 **Emerging Policies and Dilemma for Real World Evidence Generation**

Gregory Daniel, Duke-Robert J. Margolis, MD, Center for Health Policy, Washington, DC

9:30 **FDA Perspective on Real-World Evidence Generation in the Future**

Jacqueline Corrigan-Curay, Food and Drug Administration, Silver Spring, MD

9:45 **Evidence Generation Using NEST**

William Murray, Medical Device Innovation Consortium, Minneapolis, MN

10:00 **Q&A/Discussion**

10:15–10:45 AM

Break and Exhibits

Ballroom Foyer

10:45 AM–12:25 PM

Abstract Oral Session

QCOR 2017 Young Investigator Awards

Salon III

Moderators:

Rashmee Shah, University of Utah, Salt Lake City, UT

Emily O'Brien, Duke Clinical Research Institute, Durham, NC

10:45 **Clinical Course After Elective Percutaneous Coronary Intervention in China: A Report From China PEACE Prospective Study of Percutaneous Coronary Interventions** **1**

Yuan Lu, Yale University, New Haven, Connecticut; Haibo Zhang, China Oxford Center for International Health Research, Fuwai Hospital, National Center for Cardiovascular Diseases, Beijing, China; Yongfei Wang, John Welsh, Yale University, New Haven, Connecticut; Jiamin Liu, Wenchi Guan, Jing Li, Xi Li, Xin Zheng, China Oxford Center for International Health Research, Fuwai Hospital, National Center for Cardiovascular Diseases, Beijing, China; John A. Spertus, Health Outcomes Research,

Saint Luke's Mid America Heart Institute/ University of Missouri-Kansas City, Kansas City, Missouri; Frederick A. Masoudi, Division of Cardiology, University of Colorado Anschutz Medical Campus, Aurora, Colorado; Harlan M. Krumholz, Yale University, New Haven, Connecticut; Lixin Jiang, China Oxford Center for International Health Research, Fuwai Hospital, National Center for Cardiovascular Diseases, Beijing, China

10:55 **Discussant**

Sharon-Lise Normand, Harvard Medical School, Boston, MA

11:00 **Q&A/Discussion**

11:05 **Patient Provider Communication and Patient-centered Outcomes Among Patients With Atherosclerotic Cardiovascular Disease in United States: Medical Expenditure Panel Survey 2010–2013** **2**

Victor Okunrintemi, Baptist Health South Florida, Miami, Florida; Erica Spatz, Yale School of Medicine, New Haven, Connecticut; Joseph Salami, Baptist Health South Florida, Miami, Florida; Haider Warraich, Duke University School of Medicine, Durham, North Carolina; Salim Virani, Baylor College of Medicine, Houston, Texas; Michael Blaha, Johns Hopkins, Baltimore, Maryland; Ron Blankstein, Brigham and Women's Hospital, Boston, Massachusetts; Harlan Krumholz, Yale School of Medicine, New Haven, Connecticut; Khurram Nasir, Baptist Health South Florida, Miami, Florida

11:15 **Discussant**

Karen Joynt, Brigham and Women's Hospital, Boston, MA

11:20 **Q&A/Discussion**

11:25 **Personalizing the Intensity of Blood Pressure Control: Modeling the Heterogeneity of Risks and Benefits from the SPRINT Trial** **3**

Krishna K. Patel, Suzanne V. Arnold, Paul S. Chan, Yuanyuan Tang, Yashashwi Pokharel, Philip G. Jones, John A. Spertus, Saint Luke's Mid America Heart Institute, University of Missouri-Kansas City, Kansas City, Missouri

11:35 **Discussant**

Thomas Maddox, University of Colorado, Aurora, CO

11:40 **Q&A/Discussion**

11:45 **Electronic Health Record-Based Overestimation of Failure to Prescribe Statins in Patients With Coronary Artery Disease in a Large, Academic, Multispecialty Clinic Practice** **4**

Eric Y. Shin, Emory University School of Med, Atlanta, Georgia; Patricia Ochuko, Emory Healthcare, Atlanta, Georgia; Kunal Bhatt,

MONDAY

Program Agenda (continued)

Emory University School of Medicine, Atlanta, Georgia; Brian Howard, Wellstar Health System, Atlanta, Georgia; Gerard McGorisk, Emory University School of Medicine, Atlanta, Georgia; Linda Delaney, Kristan Langdon, Marjan Khosravanipour, Andiran Nambi, Allison Grahovec, Emory Healthcare, Atlanta, Georgia; Douglas Morris, Penny Castellano, Leslee Shaw, Laurence Sperling, Abhinav Goyal, Emory University School of Medicine, Atlanta, Georgia

11:55 **Discussant**
Jason Wasfy, Massachusetts General Hospital, Boston, MA

12:00 **Q&A/Discussion**

12:05 **A Comparison of Methods for Identifying Hospital Performance Outliers in Cardiac Surgery**

Xiaoting Wu, Min Zhang, Richard L. Prager, Donald S. Likosky, University of Michigan, Ann Arbor, MI

12:15 **Discussant**

David Cohen, Saint Luke's Mid America Heart Inst, Kansas City, MO

12:20 **Q&A/Discussion**

10:45 AM–12:00 PM

**Concurrent Session I
Implementation Science**

Plaza C and D

Moderators:

John Spertus, Mid America Heart Institute, Kansas City, MO

Daniel Matlock, University of Colorado, Denver, CO

10:45 **Overview**

Daniel Matlock, University of Colorado, Aurora, CO

11:00 **Case #1: QUERI**

Paul Heidenreich, Palo Alto Medical Center, Palo Alto, CA

11:15 **Case #2: Intervention – Shared Decision Making DECIDE-LVAD**

Larry Allen, University of Colorado, Aurora, CO

11:30 **Tips for Funding**

Michael Engelgau, National Heart, Lung, and Blood Institute, Bethesda, MD

12:00 **Q&A/Discussion**

12:45–2:00 PM

Career Development Luncheon

Plaza B

**Ticketed event.*

Moderator:

Rashmee Shah, MD, University of Utah, Salt Lake City, UT

Table Leaders:

Kumar Dharmarajan, Yale School of Medicine, New Haven, CT

Thomas Maddox, University of Colorado, Denver, CO

Jason H. Wasfy, Massachusetts General Hospital, Boston, MA

Rashmee U. Shah, University of Utah, Salt Lake City, UT

Colleen K. McIlvennan, University of Colorado, Aurora, CO

Tracy Wang, Duke University, Durham, NC

Emily C. O'Brien, Duke Clinical Research Institute, Durham, NC

12:30–2:00 PM

Poster Session II

Salon I and II

Poster Board Numbers 2–125

Presentation Numbers 138–260

2:00–3:15 PM

Concurrent Session II

Oral Abstracts: General

Salon III

Moderators:

Paul Heidenreich, Palo Alto VA Medical Center, Palo Alto, CA

Tracy Wang, Duke University, Durham, NC

2:00 **Association Between Percutaneous Coronary Intervention Outcomes and Physician Education and Board Certification in New York State 2010-2012**

Sameed Ahmed M. Khatana, Paul N. Fiorilli, Peter W. Groeneveld, Jay S. Giri, Hospital of the University of Pennsylvania, Philadelphia, Pennsylvania

MONDAY

Program Agenda (continued)

- 2:15 **Titration From Low/moderate to High Intensity Statins Following Myocardial Infarction Among Patients With Diabetes**
Paul Muntner, Lisandro D. Colantonio, Todd M. Brown, April P. Carson, Yu Ling Dai, University of Alabama at Birmingham, Birmingham, Alabama; Michael E. Farkouh, Icahn School of Medicine at Mount Sinai, New York, New York; Keri Monda, Ben Taylor, Amgen Inc., Thousand Oaks, California; Hong Zhao, University of Alabama at Birmingham, Birmingham, Alabama; Robert S. Rosenson, Icahn School of Medicine at Mount Sinai, New York, New York
- 2:30 **Statin Use and Its Facility Level Variation in Patients With Peripheral Artery Disease: Insights From the Department of Veterans Affairs**
Cameron L. McBride, Julia Akaroyd, David J. Ramsey, Vijay Nambi, Baylor College of Medicine, Houston, Texas; Khurram Nasir, Baptist Health South Florida, Miami, Florida; Erin D. Michos, Ciccarone Center for the Prevention of Heart Disease - John Hopkins University School of Medicine, Baltimore, Maryland; Kim K. Birtcher, University of Houston College of Pharmacy, Houston, Texas; Pamela B. Morris, Medical University of South Carolina, Charleston, South Carolina; Vera A. Bittner, University of Alabama at Birmingham, Birmingham, Alabama; Christie M. Ballentyne, Laura A. Peterson, Salim S. Virani, Baylor College of Medicine, Houston, Texas
- 2:45 **The Impact of Participation in a Telestroke Network on In-hospital Mortality in Georgia**
Donglan Zhang, University of Georgia, Athens, Georgia; Moges S. Ido, Georgia Department of Public Health, Atlanta, Georgia; Lu Shi, Clemson University, Clemson, South Carolina; Dale Green, University of Georgia, Athens, Georgia
- 3:00 **Characteristics of Patients and Hospitals Utilizing Advanced Providers for Post-myocardial Infarction Outpatient Care**
Jennifer Rymer, Anita Y. Chen, Duke University School of Medicine, Durham, North Carolina; Laine Thomas, Judith Stafford, Duke Clinical Research Institute, Durham, North Carolina; Jonathan Enriquez, University of Missouri Kansas City, Kansas City, Missouri; Abhinav Goyal, Emory School of Medicine, Atlanta, Georgia; Eric Peterson, Tracy Y. Wang, Duke University School of Medicine, Durham, North Carolina

2:00–3:15 PM

Concurrent Session II

Circ: CQO Town Hall

Plaza C and D

Moderator:

Brahmajee Nallamothu, Ann Arbor Veterans Affairs Medical Center, Ann Arbor, MI

- 2:00 **State-of-the-Journal**
Brahmajee Nallamothu, Ann Arbor Veterans Affairs Medical Center, Ann Arbor, MI
- 2:15 **Evaluating Value Series**
Michael Ho, University of Colorado, Aurora, CO
- 2:30 **Interaction between CQO and Circulation**
Sandeep Das, UT Southwestern, Dallas, TX
- 2:45 **Social Media**
Marilyn Mann, Kensington, MD
- 3:00 **Q&A/Discussion**

3:15–3:45 PM

Break and Exhibits

Ballroom Foyer

3:45–5:00 PM

Plenary II

The Future of Health Care Policy

Salon III

Moderators:

Karen Joynt, Brigham and Women's Hospital, Boston, MA
 William Borden, George Washington University, Washington, DC

- 3:45 **Health Care Priorities in the Trump Administration**
Gail Wilensky, Project HOPE, Bethesda, MD
- 4:05 **HealthCare Access and Vulnerable Populations**
Sara Rosenbaum, George Washington University, Washington, DC
- 4:25 **Delivering Value-based Care**
Sean Cavanaugh, Center for Medicare, Baltimore, MD
- 4:45 **Q&A/Discussion**

5:00 PM

Adjourn

MONDAY

Poster Sessions

Abstract Poster Session I
Sunday, April 2, 2017
5:00–6:30 PM
Salon I and II

Abstract Title	Author Block	Presentation Number	Board Number
Elevation of B-Type Natriuretic Peptide at Discharge is With 2-Year Mortality After Transcatheter Aortic Valve Implantation in Patients with Severe Aortic Stenosis: A Multicenter Prospective OCEAN Registry	Kazuki Mizutani , Masahiko Hara, Shinichi Iwata, Takashi Murakami, Toshihiko Shibata, Minoru Yoshiyama, Osaka City Univ Graduate Sch of Med, Osaka, Japan; Toru Naganuma, New Tokyo Hosp, Chiba, Japan; Futoshi Yamanaka, Shonan Kamakura Hosp, Kanagawa, Japan; Akihiro Higashimori, Kishiwada Tokusyukai Hosp, Osaka, Japan; Norio Tada, Sendai Kousei Hosp, Miyagi, Japan; Kensuke Takagi, Ogaki Municipal Hosp, Gifu, Japan; Motoharu Araki, Saiseikai Yokohama Eastern Hosp, Kanagawa, Japan; Hiroshi Ueno, Toyama Univ Graduate Sch of Med, Toyama, Japan; Minoru Tabata, Tokyobay Urayasulchikawa Medical Ctr, Chiba, Japan; Shinichi Shirai, Kokura Memorial Hosp, Osaka, Japan; Yusuke Watanabe, Teikyo Univ Sch of Med, Tokyo, Japan; Masanori Yamamoto, Toyohashi Heart Ctr, Aichi, Japan; Kentaro Hayashida, Keio Univ Graduate Sch of Med, Tokyo, Japan	011	1
Differences in Quantitative Coronary Angiographic (QCA) Characteristics of Coronary Artery Disease Between Human Immunodeficiency Virus (HIV) Patients Pre-treated With versus Without Statins on Admission	Omar A. Meelu , Kleanthis Theodoropoulos, Samantha Sartori, Mount Sinai Heart, New York, NY	012	2
Using the Diabetes Collaborative Registry (DCR) to Estimate the Potential Real-world Impact of the Iris Trial on Improving Outcomes in Patients With Cerebrovascular Disease	Suzanne V. Arnold , Saint Luke's Mid America Heart Inst, Kansas City, MO; Silvio E Inzucchi, Yale Univ Sch of Med, New Haven, CT; Fengming Tang, Saint Luke's Mid America Heart Inst, Kansas City, MO; Darren K. McGuire, Univ of Texas Southwestern Medical Ctr, Dallas, TX; Sanjeev N Mehta, Joslin Diabetes Ctr, Boston, MA; Thomas M. Maddox, VA Eastern Colorado Health Care System and Univ of Colorado Sch of Med, Denver, CO; Abhinav Goyal, Laurence S. Sperling, Emory Univ Sch of Med, Atlanta, GA; Daniel Einhorn, Univ of California, San Diego, San Diego, CA; Nathan D. Wong, Univ of California, Irvine Sch of Med, Irvine, CA; Mikhail Kosiborod, Saint Luke's Mid America Heart Inst, Kansas City, MO	013	3
Evaluation of Readmission after Acute Myocardial Infarction for Patients Included in Medicare's Hospital Readmissions Reduction Program	Lila M. Martin , Ryan W. Thompson, Timothy G. Ferris, Dept of Med, Massachusetts General Hosp, Harvard Medical Sch, Boston, MA; Jagmeet P. Singh, Elizabeth Laikhter, Vijeta Bhambhani, Jason H. Wasfy, Cardiology Div, Dept of Med, Massachusetts General Hosp, Harvard Medical Sch, Boston, MA	014	4
Importance of Balanced Follow-up Time and Other Study Design Considerations When Evaluating Adherence Using Two Novel Oral Anticoagulants	Craig Coleman, Hartford Hosp, Hartford, CT; Zhong Yuan, Janssen Rsch and Development, LLC, Titusville, NJ; Jeffrey Schein, Concetta Crivera, Veronica Ashton, Janssen Scientific Affairs, LLC, Raritan, NJ; François Laliberté , Patrick Lefebvre, Groupe d'Analyse Ltée, Montreal, QC, Canada; Eric Peterson, Duke Clinical Res Inst, Durham, NC	015	5

Poster Sessions (continued)

Abstract Title	Author Block	Presentation Number	Board Number
Endovascular Management of Major Vascular Access Site Complications During Transcatheter Aortic Valve Implantation (TAVI).	Muhammad U. Majeed , Lehigh Valley Health Network, Allentown, PA; Kelly D. Green, Marat Fudim, Mark A. Robbins, Vanderbilt Univ, Nashville, TN; David X. Zhao, Wake Forest Medical Ctr, Winston-Salem, NC	016	6
Feasibility of Audit and Feedback for Reducing Rarely Appropriate Nuclear Myocardial Perfusion Imaging Among Veterans	David E. Winchester , Carsten Schmalfluss, David C. Wymer, Univ of Florida, Gainesville, FL; Christian D. Helfrich, VA Puget Sound Health Care System, Seattle, WA; Rebecca J. Beyth, Univ of Florida, Gainesville, FL	017	7
Prior Authorization for Diagnostic Catheterization: The Value of Reviewers When There is Clinical Ambiguity	Adam C. Powell , HealthHelp, LLC, Houston, TX; Stephen E Price, Humana Inc., Louisville, KY; Khoa Nguyen, Gary L. Smith, HealthHelp, LLC, Houston, TX; James W. Long, Humana Inc., Louisville, KY; Uday U Deshmukh, HealthHelp, LLC, Houston, TX	018	8
Real-World Use of Sacubitril/Valsartan in Heart Failure in the First Year Following FDA Approval	Lindsey R. Sangaralingham, S. Jeson Sangaralingham, Holly K. Van Houten, Nilay D. Shah, Rosalyn O. Adigun, Shannon M. Dunlay , Mayo Clinic, Rochester, MN	019	9
Stress and Achievement of Cardiovascular Health Metrics: The American Heart Association Life's Simple 7™ in African-Americans of the Jackson Heart Study	LaPrincess Brewer , Mayo Clinic, Rochester, MN; Nicole Redmond, Natl Heart, Lung, and Blood Inst (NHLBI)/ Natl Insts of Health (NIH), Bethesda, MD; Joshua Slusser, Christopher Scott, Alanna Chamberlain, Mayo Clinic, Rochester, MN; Luc Djousse, Brigham and Women's Hosp, Harvard Medical Sch, Boston, MA; Christi Patten, Veronique Roger, Mayo Clinic, Rochester, MN; Mario Sims, Univ of Mississippi Medical Ctr, Jackson, MS	020	10
Most People Who Need to Perform CPR in Their Home Cannot	Robert H. Trenkamp Jr. , Saving Lives In Chatham County, Savannah, GA; Fernando J. Perez, St. Josephs Candler Healthcare System, Savannah, GA	021	11
Assessing Attitudes and Treatment Preferences Among Patients With Hyperlipidemia: Patient Focus Groups	Amy M. Barrett , Dana B. DiBenedetti, RTI Health Solutions, Research Triangle Park, NC; Pratik Rane, Amgen, Thousand Oaks, CA; Sally Wade, Wade Outcomes Res and Consulting, Salt Lake City, UT; Yi Qian, Amgen, Thousand Oaks, CA	022	12
Mission Lifeline Regional Reports Impact Performance in Two Major Metropolitan EMS Regions	Robin Y. Kiser , American Heart Association, St. Louis, MO; Art Miller, Kathleen O'Neill, American Heart Association, Chicago, IL; Gwendolyn Woods, American Heart Association, Kansas City, MO; Michelle Scharnott, American Heart Association, Milwaukee, WI	023	13
Public Access Defibrillation State Law Assessment: Do Current Laws Align With Best Available Evidence?	Andrew Kunka , CDC & Temple Univ, Philadelphia, PA	024	14
Factors Influencing Blood Pressure Control and Adherence in a Middle income Country That Provides Universal Free Access to a Comprehensive Hypertension Program	Daniela Sandoval Huenchual , Univ of Chile. Faculty of Med. Dept of Primary Care and Health Family, Santiago, Chile; Carolina Nazzari, Univ of Chile. Faculty of Med. Sch of Public Health, Santiago, Chile; Tomás Romero, Univ of California. Sch of Med., San Diego, CA	025	15
Development and Validation of an Electronic Health Record Model for Predicting 30-Day Readmissions in Acute Myocardial Infarction: the AMI READMITS Score	Oanh K. Nguyen , Anil N. Makam, Christopher Clark, Song Zhang, Sandeep R. Das, Ethan A. Halm, UT Southwestern, Dallas, TX	026	16

Poster Sessions (continued)

Abstract Title	Author Block	Presentation Number	Board Number
Comparing Changes in Hospital Readmission Rates by Frequency and Total Financial Penalties Over the First Five Years	Michael P Thompson, Cameron M. Kaplan, Univ of Tennessee Health Science Ctr, Memphis, TN; Gloria J. Bazzoli, Virginia Commonwealth Univ, Richmond, VA; Teresa M. Waters, Univ of Tennessee Health Science Ctr, Memphis, TN	027	17
Electronic Health Record Meaningful Use Did Not Improve Pay-for-Performance Outcomes	Michael P. Thompson , Ilana Graetz, Univ of Tennessee Health Science Ctr, Memphis, TN; Naleef Fareed, Pennsylvania State Univ, University Park, PA; Gloria J Bazzoli, Virginia Commonwealth Univ, Richmond, VA; Teresa M Waters, Univ of Tennessee Health Science Ctr, Memphis, TN	028	18
Design, Safety and Effectiveness of Exercise Interventions in Patients With ICDs and CRT: a Systematic Review	Daniel A. Steinhaus , Mid-America Heart Inst, Kansas City, MO; Steven A. Lubitz, Massachusetts General Hosp, Boston, MA; Peter A. Noseworthy, Mayo Clinic, Rochester, MN; Daniel B. Kramer, Beth Israel Deaconess Medical Ctr, Boston, MA	029	19
WITHDRAWN		030	20
Determination of Drivers of Cost Variation in Aortic Valve Replacement; a Case Costing Approach	Claire E. Warren , Gregory M. Hirsch, Queen Elizabeth II Health Science Ctr, Halifax, NS, Canada	031	21
Is Bigger Data Better? Predicting Readmissions in Acute Myocardial Infarction on Admission versus Discharge With Electronic Health Record Data	Oanh K. Nguyen , Anil N. Makam, UT Southwestern, Dallas, TX; Christopher Clark, Parkland Health and Hosp System, Dallas, TX; Song Zhang, Sandeep R. Das, Ethan A. Halm, UT Southwestern, Dallas, TX	032	22
Understanding Diagnostic Factors Predicting Negative Coronary Angiography in Patients With Suspected Ischemic Heart Disease: Can We Prevent the Cost of Unnecessary Procedures?	Vamsi Gaddipati , Adel Elsayed, Kevin Kip, Sachin Diwadkar, Sanders Chae, Michael Berlowitz, Univ of South Florida, Tampa, FL	033	23
Rapid Response Activation and In-hospital Mortality	Kinan Kassar , Dorothy Pusateri, Anastasios Kapetanos, Allegheny General Hosp, Pittsburgh, PA	034	24
A Clinician's Transfusion Trigger Predicts Variation in Red Blood Cell Transfusions During Cardiac Surgery	Joyce W. Loh , Univ of Michigan Medical Sch, Ann Arbor, MI; Darin B Zahuranec, Univ of Michigan Dept of Neurology, Ann Arbor, MI; Gaetano Paone, Henry Ford Hosp Div of Cardiac Surgery, Detroit, MI; Robert S. Kramer, Tufts Univ Sch of Med Div of Cardiothoracic Surgery, Boston, MA; Alphonse DeLucia III, Bronson Methodist Hosp Dept of Cardiac Surgery, Kalamazoo, MI; Warren D. Behr, Bronson Blood Management, Kalamazoo, MI; Min Zhang, Univ of Michigan Dept of Biostatistics, Ann Arbor, MI; Milo C Engoren, Univ of Michigan Dept of Anesthesiology, Ann Arbor, MI; Richard L. Prager, Donald S. Likosky, Univ of Michigan Dept of Cardiac Surgery, Ann Arbor, MI; Michigan Society of Thoracic and Cardiovascular Surgeons Quality Collaborative	035	25
LDL-Cholesterol Lowering Among Young Adults Who Experience a First Myocardial Infarction	Bradley Collins , Avinainder Singh, Sanjay Divakaran, Arman Qamar, Julio Baez, Josh Klein, Jon Hainer, Ravi Shah, Donna Polk, Hicham Skali, Jorge Plutzky, Marcelo Di Carli, Khurram Nasir, Deepak Bhatt, Ron Blankstein, Brigham and Women's Hosp, Boston, MA	036	26

Poster Sessions (continued)

Abstract Title	Author Block	Presentation Number	Board Number
The Accuracy of Self-reported Blood Pressure in the Medication Adherence Improvement Support App for Engagement - Blood Pressure (MedlSAFE-BP) Trial	Kyle Morawski , Roya Ghazinouri, Alexis Krumme, Julie Lauffenburger, Jessica Lee, Brigham and Women's Hosp, Boston, MA; Shefali Kumar, Leslie Oley, Evidation Health, San Mateo, CA; Namita Mohta, Brigham and Women's Hosp, Boston, MA; Jessie Juusola, Evidation Health, San Mateo, CA; Niteesh K Choudhry, Brigham and Women's Hosp, Boston, MA	037	27
American Heart Association Mission: Lifeline Breakthrough Series Collaborative Improving the Survival Rates for Out of Hospital Cardiac Arrest by Focusing on Early CPR With an Emphasis on Chest Compressions	Charles R. Siegel , Univ of Virginia Undergraduate Human Biology Major, Charlottesville, VA; Anjan Chakrabarti, Interventional Cardiology, Cardiovascular Associates, Chesapeake, VA; Lewis Siegel, Chesapeake Fire Dept Operational Medical Director, Chesapeake, VA; Forrest Winslow, Chesapeake Fire Dept, Lieutenant, Chesapeake, VA; Thomas Hall, American Heart Association Mission: Lifeline Resuscitation Manager, Dallas, TX	038	28
Comparison of Costs & Outcomes of Dapagliflozin With Dipeptidyl Peptidase-4 Inhibitors Added to Metformin Using a Short-term Cost-effectiveness Model	Abhiroop Chakravarty, Mohini Rastogi, Complete HEOR Solutions, Gurgaon, India; Praveen Dhankhar, Complete HEOR Solutions, North Wales, PA; Kelly Bell , AstraZeneca, Wilmington, DE	039	29
Mineralocorticoid Receptor Antagonists After Hospitalization of Patients With Heart Failure With a Reduced Ejection Fraction	Matthew S. Durstenfeld , Stuart D Katz, Hannah Park, Saul Blecker, New York Univ, New York, NY	040	30
Trends in Publication and Methodological Quality of Major Non-inferiority Cardiovascular Trials From 1990-2016: a Systematic Review	John W. Welsh , Behnood Bikdeli, Yale Univ, New Haven, CT; Yasir Akram, Saint Vincent Hosp, Worcester, MA; Ike Lee, Nihar R. Desai, Yale Univ, New Haven, CT; Gregg W. Stone, Columbia Univ, New York, NY; Joseph S. Ross, Harlan M. Krumholz, Yale Univ, New Haven, CT	041	31
Association Between Preexisting Valvular Heart Disease and Takotsubo Cardiomyopathy Among Hospitalized Patients in the United States	Akintunde Akinjero , Icahn Sch of Med at Mount Sinai, New York, NY; Oluwole Adegbola, Seton Hall Univ Sch of Health and Medical Sciences at Englewood Hosp and Medical Ctr, Englewood, NJ; Tomi Akinyemiju, Univ of Alabama at Birmingham, Birmingham, AL	042	32
Health Insurance and the Risk of Incident Cardiovascular Disease in the Multi-Ethnic Study of Atherosclerosis	Matthew T. Crim , Joe X. Xie, Yi-An Ko, Emory Univ, Atlanta, GA; Roger S. Blumenthal, Michael J. Blaha, Johns Hopkins Univ, Baltimore, MD; Khurram Nasir, Baptist Health South, Miami, FL; Matthew J. Budoff, Harbor-UCLA Medical Ctr, Los Angeles, CA; Leslee J. Shaw, Emory Univ, Atlanta, GA	043	33
The Differences of Heart Failure in Young-old, Old-old and Oldest Old	Mengxi Yang , China-Japan Friendship Hosp, Beijing, China; Hui An, Xin Yang, Peking Univ People's Hosp, Beijing, China; Xi Wang, Rui Li, Jingyi Ren, China-Japan Friendship Hosp, Beijing, China	044	34
Incremental Medical Expenditures Attributable to Hypertension in China's Middle-aged and Elderly Population	Donglan Zhang , Univ of Georgia, Athens, GA; Shukai Li, Peking Univ, Beijing, China	045	35
Variation by Provider in Echocardiographic Surveillance of Mitral Regurgitation	Varsha Tanguturi , Michael Hidrue, Michael Picard, Steven Atlas, Jeffrey Weillburg, Timothy Ferris, Katrina Armstrong, Jason Wasfy, Massachusetts General Hosp, Boston, MA	047	37
Decision Regret in Patients With Durable Ventricular Assist Devices	Stephanie G. Cooper , Sharon Whyte, Cole Hansell, Katelyn Horvath, Nahush A. Mokadam, Claudius W Mahr, James Kirkpatrick, Univ of Washington Medical Ctr, Seattle, WA	048	38
Smart Rx	Shaan-Chirag C. Gandhi, Emily K. Zern, Maulik D. Majmudar , Massachusetts General Hosp, Boston, MA	049	39

Poster Sessions (continued)

Abstract Title	Author Block	Presentation Number	Board Number
Improvements in Door to Groin Puncture Time for Surgical Stroke After Quality Protocol Interventions at the University of California, San Diego	Arvin R. Wali , David R. Santiago-Dieppa, Vincent Cheung, Jeffrey Steinberg, Brian Hirshman, Peter Abraham, Kevin Porras, Mike Brandel, Julie Jurf, Emily Botts, Scott Pannell, Alexander Khalessi, Univ of California, San Diego, La Jolla, CA	050	40
A Feasibility Study on 10-year CVD Risk Assessment as a Primary Prevention Tool for Cardiovascular Disease	Ruizhi Shi , Yong Lan, Pfizer, Beijing, China; Chunyang Lu, Peking Univ, Beijing, China; Wei Yu, Pfizer, Beijing, China	051	41
Improved Hospital Outcomes With Hypokalemia on Admission in Cardiac Arrest Survivors Treated With Therapeutic Hypothermia	Angelo de la Rosa , Manuel Tapia, Yong Ji, Basil Saour, Mikhail Torosoff, Albany Medical Coll, Albany, NY	052	42
Does Sudden Cardiac Arrest Affect Long-term Outcomes Following Revascularization in MI Patients? Results From the Home Automated External Defibrillator (HAT) Trial	Monique L. Anderson , Eric D Peterson, Anne Hellkamp, Sana M. Al-Khatib, Kevin L. Thomas, Duke Univ, Durham, NC; Graham Nichol, Univ of Washington, Seattle, WA; Christopher Fordyce, Univ of British Columbia, Vancouver, BC, Canada; Daniel B. Mark, Kerry L. Lee, Duke Univ, Durham, NC; Jeanne Poole, Gust H. Bardy, Univ of Washington, Seattle, WA	053	43
Mortality Decline After Ischemic Stroke—the Medicare Cohort From 2009 to 2013	Shumei Man , The Clinical Neuroscience Inst, Miami Valley Hosp, Wright State Univ Boonshoft Sch of Med, Dayton, OH; Jesse D. Schold, Dept of Quantitative Health Sciences, Cleveland Clinic, Dayton, OH; Ken Uchino, Cerebrovascular Ctr, Neurological Inst, Cleveland Clinic, Cleveland, OH	054	44
Changes in Disease-specific versus Generic Health Status Measures After Left Ventricular Assist Device Implantation: Insights From INTERMACS	Michael E. Nassif , John A. Spertus, Philip G. Jones, Timothy J. Fendler, Saint Lukes Mid America Heart Inst/Univ of Missouri Kansas City, Kansas City, MO; Larry A. Allen, Univ of Colorado Sch of Med Anschutz Medical Campus, Denver, CO; Kathleen L. Grady, Feinberg Sch of Med, Northwestern Univ, Chicago, IL; Suzanne V. Arnold, Saint Lukes Mid America Heart Inst/Univ of Missouri Kansas City, Kansas City, MO	055	45
Age-specific Differences in Baseline Characteristics, Peripheral Arterial Disease Specific Health Status, and Patterns of Care in Patients With Peripheral Arterial Disease: Insights From the Patient-centered Outcomes Related to Treatment Practices in Peripheral Arterial Disease: Investigating Trajectories (PORTRAIT) Registry	David Halpin , Erica Spatz, Bennet Cua, Sunny Jhamnani, Yale Sch of Med, New Haven, CT; Kim Smolderen, John Spertus, St. Luke's Mid America Heart Inst, Kansas City, MO; Alan Hirsch, Univ of Minnesota Health, Minneapolis, MN; Kensey Gosch, St. Luke's Mid America Heart Inst, Kansas City, MO; Nihar Desai, Carlos Mena-Hurtado, Yale Sch of Med, New Haven, CT	056	46

Poster Sessions (continued)

Abstract Title	Author Block	Presentation Number	Board Number
Understanding of Treatment Strategies Among Patients Newly Diagnosed With Atrial Fibrillation: Findings From SATELITTE	Brystana G. Kaufman , Sunghee Kim, Karen Pieper, Duke Clinical Res Inst, Durham, NC; Michael D. Ezekowitz, Thomas Jefferson Medical Coll and the Heart Ctr, Wynnewood, PA; Gregg C. Fonarow, UCLA Div of Cardiology, Los Angeles, CA; Gerald V. Naccarelli, Penn State Coll of Med, Hershey, PA; Kenneth W. Mahaffey, Stanford Univ Sch of Med, Palo Alto, CA; Jack Ansell, New York Univ Sch of Med, New York, NY; Peter B. Berger, Northwell Health, New Hyde Park, NY; James A. Reiffel, Columbia Univ, New York, NY; Paul S. Chan, Saint Luke's Mid America Heart Inst, Kansas City, MO; Daniel E. Singer, Harvard Univ, Cambridge, MA; Larry A. Allen, Univ of Colorado, Boulder, CO; James V. Freeman, Yale Univ, New Haven, CT; Peter R. Kowey, Jefferson Medical Coll, Philadelphia, PA; Bernard Gersh, Mayo Clinic, Rochester, MN; Jonathon P. Piccini, Eric D. Peterson, Emily C. O'Brien, Duke Clinical Res Inst, Durham, NC	057	47
Early Effect of Medicare Accountable Care Organizations on Acute Myocardial Infarction Episode Payments	Shashank S. Sinha , Nicholas M. Moloci, Andrew M. Ryan, Brahmajee K. Nallamothu, John M. Hollingsworth, Univ of Michigan, Ann Arbor, MI	058	48
Developing a Mobile Application for Cardiac Rehabilitation	Alexis L. Beatty , John C. Fortney, VA Puget Sound Health Care System / Univ of Washington, Seattle, WA; P Michael Ho, VA Eastern Colorado Health Care System / Univ of Colorado, Denver, Denver, CO; George G. Sayre, VA Puget Sound Health Care System / Univ of Washington, Seattle, WA; Mary A. Whooley, San Francisco VA Medical Ctr / UCSF, San Francisco, CA	059	49
Association of Body Mass Index With Risk Factor Optimization and Guideline Directed Medical Therapy in Veterans With Cardiovascular Disease	Ravi S. Hira , Univ of Washington, Seattle, WA; Julia M Akeroyd, David J. Ramsey, Baylor Coll of Med, Houston, TX; Yashashwi Pokharel, Univ of Missouri, Kansas City, MO; Hani Jneid, Michael E. Debakey VA Medical Ctr and Baylor Coll of Med, Houston, TX; Christie M. Ballantyne, Baylor Coll of Med, Houston, TX; Laura A Petersen, Salim S. Virani, Michael E. Debakey VA Medical Ctr and Baylor Coll of Med, Houston, TX	060	50
Sex-specific Trends in Acute Myocardial Infarction Hospitalization, 2000 to 2014	Stephanie R. Reading , Kristi Reynolds, Bonnie H. Li, Lei X. Qian, Denison S. Ryan, Teresa N. Harrison, Ronald D. Scott, Jeffrey J. Cavendish, Steven J. Jacobsen, Michael H. Kanter, Kaiser Permanente of Southern California, Pasadena, CA	061	52
Physiological and Psychological Stress Response are Related to QOL and Functional Status Among People Living With a Left Ventricular Assist Device	Martha Abshire , Gayle G. Page, Chakra Budhathoki, Patricia M. Davidson, Stuart D. Russell, Haera Han, Johns Hopkins Univ, Baltimore, MD; Shashank Desai, Inova Fairfax Hosp, Falls Church, VA; Cheryl Dennison Himmelfarb, Johns Hopkins Univ, Baltimore, MD	062	53
Diagnostic and Treatment Patterns of Cardiac Sarcoidosis: a Single Center Experience	Anna Grodzinsky , Timothy Fendler, Bhaskar Bhardwaj, Akshit Sharma, Stephanie Lawhorn, Siva Taduru, Ibrahim Saeed, Gregory Howell, Saint Luke's Mid America Heart Inst, Kansas City, MO	063	54
Improving Aortic Valve Replacement Risk Prediction: The Role of Geographically Derived Socioeconomic Factors	Fenton H. McCarthy , Lingjiao Zhang, Jingbo Che, Desmond Graves, W. Clark Hargrove, Wilson Y. Szeto, Nimesh D. Desai, Peter W. Groeneveld, Matthew L. Williams, Univ of Pennsylvania, Philadelphia, PA	064	55

POSTERS

Poster Sessions (continued)

Abstract Title	Author Block	Presentation Number	Board Number
Hospital Teaching Status and TAVR Outcomes in the United States - Analysis of the National Inpatient Sample (NIS)	Emmanuel Akintoye , Wayne State Univ Sch of Med, Detroit, MI; Samson Alliu, Maimonides Medical Ctr, Brooklyn, NY; Oluwole Adegba, Englewood Medical Ctr, Mount Sinai Health System, Englewood, NJ; Haider Aldiwani, Mohamed Shokr, Wayne State Univ Sch of Med, Detroit, MI; Vwaire Orhurhu, Beth Isreal Deaconess Medical Ctr, Harvard Medical Sch, Boston, MA; Karim Mahmood, Tesfaye Telila, Tomo Ando, Wayne State Univ Sch of Med, Detroit, MI	065	56
Perioperative Stroke as a Predictor of Mortality and Morbidity in Patients Undergoing CABG	Amol Mehta , Univ of Pittsburg Sch of Med, Pittsburgh, PA	066	57
Predictors of High-sensitivity C-reactive Protein Elevation Among Patients With Myocardial Infarction: Insights From VIRGO and TRIUMPH	Mohammed Qintar , Mid America Heart Inst, Kansas City, MO; Puza P. Sharma, US Health Economics & Outcomes Res Novartis Pharmaceuticals, One Health Plaza, East Hanover, NJ; Yuanyuan Tang, Philip Jones, Yashashwi Pokharel, Mid America Heart Inst, Kansas City, MO; Rachel Dreyer, Yale Univ, New Haven, CT; John Spertus, Mid America Heart Inst, Kansas City, MO	067	58
High Sensitivity C-reactive Protein Levels Among Patients With Myocardial Infarction: Insights From Triumph	Mohammed Qintar , Mid America Heart Inst, Kansas City, MO; Puza P. Sharma, Novartis, East Hanover, NJ; Yashashwi Pokharel, Yuanyuan Tang, Philip Jones, Mid America Heart Inst, Kansas City, MO; Rachel Dreyer, Yale Univ, New Haven, CT; John Spertus, Mid America Heart Inst, Kansas City, MO	068	59
Leveraging Data With the Use of REDCap to Improve Nursing Care Delivery for Stroke Patients Undergoing Carotid Procedures	Tiffany Sheehan , Nicolle Davis, UF Health Shands Hosp, Gainesville, FL; Jeannie Cimiotti, Univ of Florida, Coll of Nursing, Gainesville, FL	069	60
A Precision Medicine Test Influenced Costs of Care Among Patients Presenting With Stable Symptoms Suggestive of Obstructive Coronary Artery Disease: Economic Endpoint Analysis From the PRESET Registry	Joseph Ladapo , David Geffen Sch of Med at UCLA, Los Angeles, CA; Matthew Budoff, UCLA Torrance, Torrance, CA; David Sharp, Doctors for Health, Omaha, NE; Pejman Azarmina, Lin Huang, CardioDx, Inc., Redwood City, CA; Bruce Maniet, Bells Medical Clinic, Bells, TX; Lee Herman, Johns Creek Primary Care, Suwanee, GA; Mark Monane, CardioDx, Inc., Redwood City, CA	070	61
The Association Between Comorbid Atrial Fibrillation and the Type of Coronary Stent Implanted in Acute Coronary Syndrome Patients	Amarnath Annapureddy , Yale Univ Sch of Med, New Haven, CT; Erin R. Weeda, Univ of Connecticut Sch of Pharmacy, Hartford, Hartford, CT; Elaine Nguyen, Craig I. Coleman, Univ of Connecticut Sch of Pharmacy, Hartford, CT	071	62
Impact of Chronic Diabetes on Periprocedural Outcomes Among Patient With Atrial Fibrillation and Flutter Who Underwent Radiofrequency Catheter Ablation Therapy (RFA). Report From the NIS 2014	Samson E. Alliu , Maimonides Medical Ctr, Brooklyn, NY; Adeyinka Adejumo, Univ of Massachusetts Medical Sch, Worcester, MA; Modupeolowa Durojaiye, Univ of Alabama at Birmingham, Birmingham, AL; Akintoye Emmanuel, Wayne State Univ, Detroit, MI; Lawrence Wolf, Maimonides Medical Ctr, Brooklyn, NY; Edgar Lichstein, Albert Einstein Coll of Med, Bronx, NY; Melvyn Hecht, Kamholz Stephan, Maimonides Medical Ctr, Brooklyn, NY; Oluwole Adegba, Englewood Hosp and Medical Ctr, Englewood, NJ; Nnaemeka Onyeakusi, Bronx-Lebanon Hosp, Bronx, NY; Tokunbo Ajayi, Johns Hopkins Hosp, Baltimore, MD	072	63

Poster Sessions (continued)

Abstract Title	Author Block	Presentation Number	Board Number
Maximizing Sacubitril/Valsartan Clinical Benefit Under Budget Constraints	Ronen Arbel , Sapir Coll, Sderot, Israel; Ariel Hammerman, Clalit Health Services Headquarters, Tel Aviv, Israel; Noa Triki, Maccabi Healthcare Services, Tel Aviv, Israel; Jean Marc Weinstein, Soroka Univ Medical Ctr, Beer Sheva, Israel; Dan Grrenberg, Ben-Gurion Univ of the Negev, Beer Sheva, Israel	073	64
Door to Balloon Time in Patients With ST Elevation Myocardial Infarction With and Without Cardiopulmonary Arrest: is Exclusion From Public Reporting Justified?	Chetan Huded , Kathleen Kravitz, Travis Gullett, Samir Kapadia, Scott Hantz, Stephen Ellis, Venu Menon, Deborah Brosovich, Elizabeth Smith, Umesh Khot, Cleveland Clinic Fndn, Cleveland, OH	074	65
Heterogeneity in Treatment Effect in Patients With Peripheral Artery Disease: Insights From the CLEVER Trial	Yashashwi Pokharel , Phillip Jones, Garth Graham, John Spertus, Kim Smolderen, Saint Luke's Mid America Heart Inst, Kansas City, MO	075	66
Modeling Heterogeneity of Benefit in Patients Eligible for Implantable Cardiac Defibrillators: Insights From the SCD-HeFT Registry	Yevgeniy Khariton , Michael Nassif, John A. Spertus, Suzanne V. Arnold, Yuanyuan Tang, Saint Luke's Mid-America Heart Inst/UMKC, Kansas City, MO	076	67
Hospitalized Heart Failure Epidemiology: Active Surveillance to Enhance Inpatient Cardiology Consultation Rates	Quentin Youmans , Preeti Kansal, Hannah Alphs Jackson, Robin Fortman, Daniel Navarro, Michael Abecassis, Gary Noskin, Allen Anderson, Charles Davidson, Clyde Yancy, R. Kannan Mutharasan, Northwestern Univ, Chicago, IL	077	68
Implications of Patient-Reported Treatment Satisfaction for Discontinuation of Rivaroxaban versus Warfarin in ROCKET-AF	Fatima Rodriguez , Leo Ungar, Stanford Univ, Stanford, CA; Anne Hellkamp, Duke Univ, Durham, CA; Richard C. Becker, Univ of Cincinnati Coll of Med, Cincinnati, OH; Scott D. Berkowitz, Bayer HealthCare Pharmaceuticals, Parsippany, NJ; Günter Breithardt, Hosp of the Univ of Münster, Münster, Germany; Keith A Fox, Univ of Edinburgh and Royal Infirmary of Edinburgh, Edinburgh, United Kingdom; Werner Hacke, Ruprecht-Karls-Univ, Heidelberg, Germany; Jonathan L. Haperin, Mt. Sinai, New York City, NY; Graeme J. Hankey, Sch of Med and Pharmacology, The Univ of Western Australia, Crawley, Australia; Christopher C. Nessel, Janssen Res & Development, Raritan, NJ; Jonathan P. Piccini, Duke Univ, Durham, NC; Daniel E. Singer, Massachusetts General Hosp and Harvard Medical Sch, Boston, MA; Manesh Patel, Duke Univ, Durham, NC; Kenneth Mahaffey, Stanford Univ, Stanford, CA	078	69
Health-related Quality of Life With Routine Invasive versus Ischemia-guided Strategies for the Elderly With Non-ST Elevation Myocardial Infarction (NSTEMI)- Insights From PREMIER/TRIUMPH	Krishna K. Patel , Suzanne V. Arnold, Mohammed Qintar, Philip G. Jones, Mid America Heart Inst, Kansas City, MO; Karen P. Alexander, Duke Clinical Res Inst, Durham, NC; John A. Spertus, Mid America Heart Inst, Kansas City, MO	079	70
Validity of Performance Measures for Heart Failure	Jay M. Patel , Paul A. Heidenreich, Stanford Univ, Stanford, CA	080	71

Poster Sessions (continued)

Abstract Title	Author Block	Presentation Number	Board Number
Effectiveness and Safety of Apixaban Compared to Warfarin in Non-Valvular Atrial Fibrillation Patients in “Real-World” US Clinical Practice: An Analysis of Three Large Databases	Gregory Y. Lip , Univ of Birmingham Inst of Cardiovascular Sciences, Birmingham, United Kingdom; Xiaoyan Li, Bristol-Myers Squibb Company, Princeton, NJ; Allison Keshishian, STATinMED Res, Ann Arbor, MI; Melissa Hamilton, Bristol-Myers Squibb Company, Princeton, NJ; Ruslan Horblyuk, Pfizer Inc, New York, NY; Kiran Gupta, Bristol-Myers Squibb Company, Plainsboro, NJ; Xuemei Luo, Pfizer Inc, Groton, CT; Jack Mardekian, Pfizer Inc, New York, NY; Anagha Nadkarni, Bristol-Myers Squibb Company, Plainsboro, NJ; Xianying Pan, Bristol-Myers Squibb Company, Princeton, NJ; Steven B. Deitelzweig, Ochsner Health System, Dept of Hosp Med, New Orleans, LA	081	72
Health and the Patient-Doctor Interaction in a Behavioral Framework	Ada C. Stefanescu Schmidt , Ami Bhatt, Massachusetts General Hosp, Boston, MA; Cass Sunstein, Harvard Law Sch, Cambridge, MA	082	73
In-hospital Outcomes in Acute Myocardial Infarction Patients Who Receive Morphine	Cian P. McCarthy , Vijeta Bhambhani, Eugene Pomerantsev, Jason H. Wasfy, Massachusetts General Hosp, Boston, MA	083	74
Discordance in Patient-Physician Perceptions of Angina Experiences and Delivery of Care	Suzanne V. Arnold , Saint Luke’s Mid America Heart Inst, Kansas City, MO; Prakash C Deedwania, Univ of California, San Francisco Sch of Med, San Francisco, CA; Cheryl Hegggen-Peay, Laurence Greene, Jeffrey D. Carter, Tamar Sapir, PRIME Education, Inc, Tamarac, FL	085	76
Secondary Prevention of Cardiovascular Disease in Patients With Type 2 Diabetes: International Insights From the TECOS Trial	Neha J. Pagidipati , Ann Marie Navar, Karen S. Pieper, Jennifer B. Green, DCRI, Durham, NC; M. A. Bethel, DTU, Oxford, United Kingdom; Paul W. Armstrong, Canadian VIGOUR Ctr, Edmonton, AB, Canada; Robert G. Josse, St. Michael’s Hosp, Toronto, ON, Canada; Darren K. McGuire, Univ. of Texas Southwestern Medical Ctr, Dallas, TX; Yuliya Lokhnygina, DCRI, Durham, NC; Jan H. Cornel, Noordwest Ziekenhuisgroep, Alkmaar, Netherlands; Sigrun Halvorsen, Univ of Oslo, Oslo, Norway; Timo E. Strandberg, Univ of Oulu, Oulu, Finland; Tuncay Delibasi, Hacettepe Univ, Ankara, Turkey; Rury R. Holman, DTU, Oxford, United Kingdom; Eric D. Peterson, DCRI, Durham, NC; on behalf of the TECOS Study Group	086	77
Impact of High Intensity Statin on Biologic and Clinical Markers of the Metabolic Syndrome in Women	Gladys P. Velarde , Emilio Garcia, Univ of Florida, Jacksonville, FL; Saadia Sherazi, Univ of Rochester, Rochester, NY; Naila Choudhary, Dale Kraemer, Univ of Florida, Jacksonville, FL	087	78
Characteristics of Congestive Heart Failure Patients Included in The Centers for Medicare and Medicaid Services Hospital Readmissions Reduction Program	Alexandra J. Coromilas , Ryan W. Thompson, Jagmeet P. Singh, Gregory D. Lewis, Timothy G. Ferris, Jason H. Wasfy, Massachusetts General Hosp, Boston, MA	088	79
Can Medical Claims Accurately Assess Cardiovascular and Bleeding Events in an All-Aged Post-Myocardial Infarction Population? Insights From the TRANSLATE-ACS Study	Patricia O. Guimaraes , Arun Krishnamoorthy, Lisa A. Kaltenbach, Kevin J. Anstrom, Duke Clinical Res Inst, Durham, NC; Mark B. Efron, Eli Lilly & Company, Indianapolis, IN; Daniel B. Mark, Duke Clinical Res Inst, Durham, NC; Patrick L. McCollam, Eli Lilly & Company, Indianapolis, IN; Linda Davidson-Ray, Eric D. Peterson, Tracy Y. Wang, Duke Clinical Res Inst, Durham, NC	089	80
Armenian Ethnicity: An Independent Risk Factor for Positive Exercise Treadmill Tests	Ara H. Rostomian , Daniel Sanchez, Jonathan Soverow, Olive View Medical Ctr - UCLA, Sylmar, CA	090	81

Poster Sessions (continued)

Abstract Title	Author Block	Presentation Number	Board Number
The Association of Invasive Treatment on Health Status Outcomes in Patients with Non-ST Elevation Myocardial Infarction and Pre-infarct Angina	Hani J. Alturkmani , Mohammed Qintar, Krishna Patel, Saint Luke's Mid America Heart Inst/UMKC, Kansas City, MO; Philip Jones, Saint Luke's Mid America Heart Inst, Kansas City, MO; John Spertus, Saint Luke's Mid America Heart Inst/UMKC, Kansas City, MO	091	82
No Change in Peripartum Cardiomyopathy Outcomes or Risk Factors Over the Past Decade	Nivedita Basu, Madeline Mahowald, Kris Kawamoto, Melinda Davis , Univ of Michigan, Ann Arbor, MI	092	83
Use of Echocardiography Following an Elevated B-Type Natriuretic Peptide Level	Parhum Namdaran , Dept of Med, Stanford Univ Sch of Med, Stanford, CA; Paul Heidenreich, Veterans Affairs Palo Alto Health Care System, Palo Alto, CA	093	84
Evaluation of Readmission and Survival Rates After Heart Failure Hospitalization in the Veterans Affairs Health Care System Between 2006 and 2013	Justin Parizo , Shoutzu Lin, Anju Sahay, Paul Heidenreich, Stanford, Palo Alto, CA	094	85
Lessons Learned from the BRIDGE Registry: Major Findings From 8 Years of BRIDGE	Morgan Bradford , Rachel Krallman, Colin McMahon, Daniel Montgomery, Eva Kline-Rogers, Kim A. Eagle, Melvyn Rubenfire, Univ of Michigan, Ann Arbor, MI; Sherry M. Bumpus, Eastern Michigan Univ, Ypsilanti, MI	095	86
Association of Body Mass Index With Bleeding in Patients Taking Warfarin for Atrial Fibrillation or Venous Thromboembolism	Kyle Stahlbaum , Eva Kline-Rogers, Xiaowen Kong, Geoffrey D. Barnes, Brian Haymart, Univ of Michigan, Ann Arbor, MI; Jay H. Kozlowski, Huron Valley Sinai, Commerce, MI; Steven L. Almany, William Beaumont Hosp, Troy, MI; Scott Kaatz, Gregory D. Krol, Vinay Shah, Henry Ford, Detroit, MI; Michael W. McNamara, Spectrum Health, Grand Rapids, MI; James B. Froehlich, Univ of Michigan, Ann Arbor, MI	096	87
Effects of BRIDGE Attendance on the Outcomes of Diabetic Patients	Caitlin Fette , Rachel Krallman, Colin McMahon, Daniel Montgomery, Jennifer Wang, Benjamin Erjavac, Eva Kline-Rogers, Kim A. Eagle, Univ of Michigan, Ann Arbor, MI; Sherry M. Bumpus, Eastern Michigan Univ, Ypsilanti, MI	097	88
The Prevalence of Racial and Socioeconomic Disparities in an Outpatient Transitional Care Clinic	Khadijah Hussain , Colin McMahon, Rachel Krallman, Daniel Montgomery, Thane Feldeisen, Spencer Morgan, Todd Koelling, Melvyn Rubenfire, Eva Kline-Rogers, Kim A. Eagle, Univ of Michigan, Ann Arbor, MI; Sherry M. Bumpus, Eastern Michigan Univ, Ypsilanti, MI	098	89
Prevalence of Headaches in Patients with Fibromuscular Dysplasia: A Report from the US Registry for FMD	Kirby Swan , Xiaokui Gu, Eva Kline-Rogers, Univ of Michigan, Ann Arbor, MI; Bryan J. Wells, Adrienne Repack, Emory Univ Hosp Midtown, Atlanta, GA; Rachel Krallman, Univ of Michigan, Ann Arbor, MI; Esther S. Kim, Vanderbilt Univ Medical Ctr, Nashville, TN; Jeffrey W. Olin, Icahn Sch of Med at Mount Sinai, New York, NY; Heather L. Gornik, Cleveland Clinic, Cleveland, OH; Pamela D. Mace, Fibromuscular Dysplasia Society of America, Rocky River, OH; James B. Froehlich, Univ of Michigan, Ann Arbor, MI; Sherry M. Bumpus, Eastern Michigan Univ, Ypsilanti, MI	099	90

Poster Sessions (continued)

Abstract Title	Author Block	Presentation Number	Board Number
Prevalence of Peripheral Vascular Disease Among Patients Using Cannabis, an Analysis of the 2014 National Inpatient Sample data	Adeyinka C. Adejumo , Univ of Massachusetts Medical Sch, Worcester, MA; Samson Alliu 11203, Maimonides Medical Ctr, Brooklyn NY, NY; Tokunbo O. Ajayi, Johns Hopkins Med, Howard County General Hosp, Columbia, MD; Adegbala M. Oluwole, Englewood Hosp and Medical Ctr., Englewood, NJ; Nnaemeka Onyeakusi, Bronx-Lebanon Hosp Ctr, Bronx, NY; Kelechi Adejumo, Univ of Massachusetts Lowell, Lowell, MA; Modupeoluwa Durojaiye, Univ of Alabama at Birmingham, Birmingham, AL; Tamunoinemi Bob-manuel, Dept of Internal Med, Univ of Tennessee Health Science Ctr, Memphis, TN; Nureddin Almaddah, North Shore Medical Ctr, Salem, MA; Edgar Lichstein, Albert Einstein Coll of Med, Bronx, NY	100	91
Qualitative Evaluation of a State Stroke Registry	David J. Reynen , Christina R. Welter, D. Patrick Lenihan, Eve C. Pinsker, Steven M. Seweryn, Univ of Illinois at Chicago, Chicago, IL; Mary G. George, Ctrs for Disease Control and Prevention, Atlanta, GA	101	92
The Association of Sleep Duration with Healthcare Expenditure Across Cardiovascular Health Profiles: The Baptist Health South Florida Employee Study	Ehimen C. Aneni , Mount Sinai Medical Ctr, Miami, FL; Chukwuemeka U Osondu, Baptist Health South Florida, Miami, FL; Javier Valero-Elizondo, Tecnológico de Monterrey (ITESM), Nuevo León, Mexico; Emir Veledar, Baptist Health South Florida, Miami, FL; Khurram Nasir, Mount Sinai Medical Ctr, Miami, FL	102	93
Hospital-Level Differences in Use of Do Not Resuscitate Orders in PaWith Pneumonia, Acute Myocardial Infarction, and Congestive Heart Failure in California	Sanketh Kolli , Evan Reynolds, Apurba Chakrabarathi, Mousumi Banerjee, Brahmajee Nallamothu, Univ of Michigan, Ann Arbor, MI	103	94
Statin Advisor: A Model to Predict Low-Density Lipoprotein Responsiveness	Saira Samani , Univ of New Mexico, Albuquerque, NM; Allison Murata, Glen Murata, Gerald Charlton, Veterans Affairs Hosp, Albuquerque, NM	104	95
Racial Differences in Health Status, Clinical Characteristics and Treatment Patterns Among Patients With Peripheral Artery Disease: Insights From the PORTRAIT Registry	Qurat-ul-ain Jelani , Bridgeport Hosp- Yale New Haven Health, Bridgeport, CT; Kim Smolderen, Univ of Missouri-Kansas City, Kansas City, MO; John A. Spertus, Univ of Missouri- Kansas City, Kansas City., MO; Wang Jingyan, Univ of Missouri- Kansas City, Kansas City, MO; Edward R. Tuohy, Stuart Zarich, Bridgeport Hosp- Yale New Haven Health, Bridgeport, CT; Phil Jones, Univ of Missouri-Kansas City, Kansas City, MO; Garth Graham, Univ of Missouri, Kansas City, MO; Rachel P. Dreyer, Yale Univ Sch of Med, New Haven, CT	105	96
Success in Failure: Reduction in 30-Day Readmissions in Primary and Secondary Heart Failure	Sushee Gadde , Catharine Aune, Bassam Omar, Barbara Burckhart, Univ of South Alabama, Mobile, AL	106	97
Cardiovascular Risk Predictors Among Black and African American Women: A Preliminary Analysis of the P4 Study	Obiora E Egbuche , Meldra Hall, Folake Ojutalayo, Ernest Alemah-Mensah, Brenda Lankford, Priscilla Pemu, Elizabeth Ofili, Morehouse Sch of Med, Atlanta, GA	107	98

Poster Sessions (continued)

Abstract Title	Author Block	Presentation Number	Board Number
Transparent Plastic Medication Bag to Improve Medication Reconciliation and Transitional Care In Geriatric Patients With Heart Failure At the time of Discharge from Heart Failure Quality Improvement Prospective Cohort Study in Harlem, New York	Hong Seok Lee , Keerthana Paladugu, Hans Cativo, Ayoola Oladejo, Sophi Lin, Metropolitan Hosp, New York Medical Coll, New York, NY	109	100
Disparities in TTE Surveillance of Mitral Regurgitation	Varsha K. Tanguturi , Vijeta Bhambhani, Michael Picard, Katrina Armstrong, Jason Wasfy, Massachusetts General Hosp, Boston, MA	110	101
Health Status Implications for Comorbid Diabetes in Patients with Symptomatic Peripheral Arterial Disease: Insights from PORTRAIT Registry	Hani J. Alturkmani , Krishna Patel, Saint Luke's Mid America Heart Inst/UMKC, Kansas City, MO; Kensey L. Gosch, Saint Luke's Mid America Heart Inst, Kansas City, MO; Mikhail N. Kosiborod, John Spertus, Kim G. Smolderen, Saint Luke's Mid America Heart Inst/UMKC, Kansas City, MO	111	102
Statin Utilization in the Outpatient Clinic of a University Based Residency Training Program	Eric Chang , Demilade Adedinsewo, Camille Calcano, Obiora Egbuche, Aneese Chaudhry, Nicolas Bakinde, Marshaleen King, Anekwe Onwuanyi, Morehouse Sch of Med, Atlanta, GA	112	103
Racial Comparisons in the Outcomes of SAVR and TAVR	Christian McNeely , Alan Zajarias, Raymond Fohung, Washington Univ Sch of Med, Saint Louis, MO; Randall Robbs, Stephen Markwell, Southern Illinois Univ – Sch of Med, Springfield, IL; Christina Vassileva, Univ of Massachusetts, Amherst, MA	113	104
Relationship Between Duration of QRS Complex and Long Term Mortality in U.S. Veterans With Atherothrombotic Risk Factors	Amish Patel , Jonathan Pollock, Edward Sam Roberto, Thein Tun Aung, Ronald Markert, Ajay Agarwal, Wright State Univ/Dayton VA Medical Ctr, Dayton, OH	114	105
Beta-blocker Therapy in Cocaine Users With Heart Failure: Insights From an Urban Academic Center	Obiora E. Egbuche , Axiyan Maihemuti, Valery Effoe, Morehouse Sch of Med, Atlanta, GA; Heather R Millard, Ctr for Intl Blood and Marrow Transplant Res, Medical Coll of Wisconsin, Milwaukee, WI; Leonard Addae, Demilade Adedinsewo, Anekwe Onwuanyi, Morehouse Sch of Med, Atlanta, GA	115	106
Relationship of Stroke Unit Status With Quality of Care and Outcome for Acute Stroke Patients: Results From China National Stroke Registry II	Xinmiao Zhang , Zixiao Li, Chunjuan Wang, Caiyun Wang, Xin Yang, Hongqiu Gu, Yuesong Pan, Liping Liu, Xingquan Zhao, Yilong Wang, Yongjun Wang, Dept of Neurology, Beijing Tiantan Hosp, Capital Medical Univ, Beijing, China, Beijing, China	116	107
A Value-Based Assessment of a Mature Cardiology E-Consult Program	Neil M. Kalwani , Brigham and Women's Hosp, Boston, MA; Sandhya K. Rao, Melissa D. Chittle, Eric M. Issebacher, Timothy G. Ferris, Jason H. Wasfy, Massachusetts General Hosp, Boston, MA	117	108
Physician Specific Practice Patterns and 30-day Heart Failure Readmission Rates: Is One Way Better Than the Other?	Anish B. Bhatt , Daniel Cheeran, Sandeep Das, Univ of Texas Southwestern, Dallas, TX	118	109
Comparison of Gated SPECT, Echocardiography and Angiography Ejection Fractions	Pavani Kolakalapudi , Mazen Omar, Bassam Omar, Christopher Malozzi, Univ of South Alabama, Mobile, AL	119	110

Poster Sessions (continued)

Abstract Title	Author Block	Presentation Number	Board Number
A Retrospective Study on Heart-lung Transplantation Patient Utilizing United Network for Organ Sharing Database to Identify the Effect of CMV Donor Recipient Serostatus, Age, Sex, or Anti-thymocyte Immunoglobulin Therapy on Mortality	Prakrity Urja , Nagarjuna Reddy Gujjula, Dixita Anugula, Jai Parekh, Creighton Univ Medical Ctr, Omaha, NE; Mukund Kumar, Nepal Medical Association, Kathmandu, Nepal; Ryan W. Walters, Creighton Univ Medical Ctr, Omaha, NE; Mahesh Anantanarayan, Univ of Minnesota, Minneapolis, MN; Renuga Vivekanandan, Creighton Univ Medical Ctr, Omaha, NE	120	111
Improvement in Functional Mitral Regurgitation After Isolated Aortic Valve Replacement for Aortic Insufficiency	Griffin Boll , Frederick Y. Chen, Tufts Medical Ctr, Boston, MA	121	112
Quality of Care for Patients With Acute Ischemic Stroke as a Function of Hospital Intravenous Thrombolysis With Recombinant Tissue Plasminogen Activator Capability: Insights From China National Stroke Registry II	Zhenzhen Rao , Zixiao Li, Hongqiu Gu, Yilong Wang, Yongjun Wang, Tiantan Clinical Trial and Res Ctr for Stroke, Beijing, China	122	113
Temporal Variation Affect Stroke Unit Admission Rates, Observations From the National Swedish Stroke Register	David Darehed , Dept of Public Health and Clinical Med, Umeå, Sweden; Mathias Blom, IKVL, Department of Med, Lund, Sweden; Eva-Lotta Glader, Dept of Med, Umeå, Sweden; Johan Niklasson, Sunderby Hosp, Luleå, Sweden; Bo Norrving, Dept of Clinical Sciences, Lund, Sweden; Marie Eriksson, Dept of Public Health and Clinical Med, Umeå, Sweden	123	114
Recovery From Acute Myocardial Infarction in China: A Report From China PEACE Prospective Study of Acute Myocardial Infarction	Yuan Lu , Yale Univ, New haven, CT; Jiamin Liu, China Oxford Ctr for Intl Health Res, Fuwai Hosp, Natl Ctr for Cardiovascular Diseases, Beijing, China; Yongfei Wang, John Welsh, Yale Univ, New haven, CT; Haibo Zhang, Wenchi Guan, Jing Li, Xi Li, Xin Zheng, Libo Hou, China Oxford Ctr for Intl Health Res, Fuwai Hosp, Natl Ctr for Cardiovascular Diseases, Beijing, China; John A Spertus, Health Outcomes Res, Saint Luke's Mid America Heart Inst/Univ of Missouri-Kansas City, Kansas City, MO; Frederick A Masoudi, Div of Cardiology, Univ of Colorado Anschutz Medical Campus, Aurora, CO; Harlan M Krumholz, Yale Univ, New haven, CT; Lixin Jiang, China Oxford Ctr for Intl Health Res, Fuwai Hosp, Natl Ctr for Cardiovascular Diseases, Beijing, China	124	115
Natural Language Processing Identifies an Association Between Canadian Cardiovascular Society Angina Severity and Mortality Within the Department of Veterans Affairs	Mina Owlia , John A Dodson, New York Univ Sch of Med, New York, NY; Scott L DuVall, George E. Wahlen Dept of Veterans Affairs Medical Ctr, Salt Lake City, UT; Joanne LaFleur, Univ of Utah, Salt Lake City, UT; Olga Patterson, George E. Wahlen Dept of Veterans Affairs Medical Ctr, Salt Lake City, UT; Rashmee Shah, Univ of Utah, Salt Lake City, UT; Steven P. Sedlis, Veterans Affairs Medical Ctr, New York, NY; Adam Bress, George E. Wahlen Dept of Veterans Affairs Medical Ctr, Salt Lake City, UT	125	116
The Association Between Medication Aherence and Time in Therapeutic Range (TTR) Among Patients with Atrial Fibrillation Treated With Warfarin: Lessons From the Parkland Health and Hospital System	Joseph Wang , Rebecca Vigen, Christopher Clark, Sandeep Das, Univ of Texas at Southwestern Medical Ctr, Dallas, TX	126	117

Poster Sessions (continued)

Abstract Title	Author Block	Presentation Number	Board Number
Differences in Care Patterns, Health Status, and Outcomes of Atrial Fibrillation in Patients With and Without Diabetes: Findings From the ORBIT-AF Registry	Justin B. Echouffo Tcheugui , Brigham and Women's Hosp, Revere, MA; Peter Shrader, Laine Thomas, Duke Clinical Res Inst, Durham, NC; Bernard J. Gersh, Mayo Clinic, Rochester, MN; Peter Kowey, Lankenau Inst for Medical Res, Wynnewood, PA; Kenneth W. Mahaffey, Stanford Univ, Palo Alto, CA; Daniel E. Singer, Massachusetts General Hosp, Boston, MA; Elaine M. Hylek, Boston Univ, Boston, MA; Alan S. Go, Kaiser Permanente of Northern California, Oakland, CA; Eric D. Peterson, Jonathan P. Piccini, Duke Clinical Res Inst, Durham, NC; Gregg C. Fonarow, Univ of California Los Angeles, Los Angeles, CA	127	118
Vascular Assessment in Patients With Non-healing Foot Wounds	Thomas P. Koshy , Mitu Bhattatiry, Sandeep Das, Dharam Kumbhani, UT Southwestern, Dallas, TX	128	119
Clinical Predictive Models for Valvular Heart Disease: A Systematic Review of the Literature	Benjamin S. Wessler , Predictive Analytics and Comparative Effectiveness (PACE) Ctr, Inst for Clinical Res and Health Policy Studies (ICRHPS) Tufts Medical Ctr, Boston, MA; Muhammad Ajan, Tufts Medical Ctr, Boston, MA; Christine Lundquist, Predictive Analytics and Comparative Effectiveness (PACE) Ctr, Inst for Clinical Res and Health Policy Studies (ICRHPS), Tufts Medical Ctr, Boston, MA; Zuhair Natto, Tufts Medical Ctr, Boston, MA; Jessica Paulus, Jennifer Lutz, David M. Kent, Predictive Analytics and Comparative Effectiveness (PACE) Ctr, Inst for Clinical Res and Health Policy Studies (ICRHPS), Tufts Medical Ctr, Boston, MA	129	120
The Tufts PACE Clinical Predictive Model Registry: Update 1990 Through 2015	Benjamin S. Wessler , Christine Lundquist, Predictive Analytics and Comparative Effectiveness (PACE) Ctr, Inst for Clinical Res and Health Policy Studies (ICRHPS), Tufts Medical Ctr, Boston, MA; Zuhair Natto, William A Janes, Muhammad Ajan, Tufts Medical Ctr, Boston, MA; Jessica Paulus, Predictive Analytics and Comparative Effectiveness (PACE) Ctr, Inst for Clinical Res and Health Policy Studies (ICRHPS), Tufts Medical Ctr, Boston, MA; Gowri Raman, Tufts Medical Ctr, Boston, MA; Jennifer Lutz, David M. Kent, Predictive Analytics and Comparative Effectiveness (PACE) Ctr, Inst for Clinical Res and Health Policy Studies (ICRHPS), Tufts Medical Ctr, Boston, MA	130	121
Association Between Limited Left Ventricle Ejection Fraction (LVEF) Transthoracic Echocardiograms (TTEs) and Overall TTE Utilization	Alexander T. Sandhu, Stanford Univ, Stanford, CA; Paul A. Heidenreich , Palo Alto Veteran's Affairs Hosp, Palo Alto, CA	131	122
Association Between Perioperative Amiodarone and Postoperative Atrial Fibrillation Following Cardiac Surgery	Auras R. Atreya , Aruna Priya, Mihaela S. Stefan, Quinn R. Pack, Tara Lagu, Amir S. Lotfi, Peter K. Lindenauer, Univ of Massachusetts Medical Sch-Baystate, Springfield, MA	132	123
Outcomes Associated With Perioperative Amiodarone in Cardiac Surgery Patients Receiving Metoprolol	Auras R. Atreya , Aruna Priya, Mihaela S. Stefan, Quinn R. Pack, Tara Lagu, Amir S. Lotfi, Peter K. Lindenauer, Univ of Massachusetts Medical Sch- Baystate, Springfield, MA	133	124
Implementation of Home-Based Cardiac Rehabilitation in the VA	David W. Schopfer , Univ of California San Francisco, San Francisco, CA; Nirupama Krishnamurthi, Hui Shen, San Francisco VA Medical Ctr, San Francisco, CA; Mary A. Whooley, Univ of California San Francisco, San Francisco, CA	134	125

POSTERS

Poster Sessions (continued)

Abstract Title	Author Block	Presentation Number	Board Number
Assessing the Personalization of Glycemic Management Strategies Through the Diabetes Collaborative Registry	Suzanne V. Arnold , Saint Luke's Mid America Heart Inst, Kansas City, MO; Silvio E. Inzucchi, Yale Univ Sch of Med, New Haven, CT; Darren K. McGuire, Univ of Texas Southwestern Medical Ctr, Dallas, TX; Fengming Tang, Saint Luke's Mid America Heart Inst, Kansas City, MO; Sanjeev N. Mehta, Joslin Diabetes Ctr, Boston, MA; Abhinav Goyal, Laurence S. Sperling, Emory Univ Sch of Med, Atlanta, GA; Thomas M. Maddox, Eastern Colorado Health Care System and Univ of Colorado Sch of Med, Denver, CO; Daniel Einhorn, Univ of California, San Diego Sch of Med, San Diego, CA; Nathan D. Wong, Univ of California, Irvine Sch of Med, Irvine, CA; Niklas Hammer, AstraZeneca, Mölndal, Sweden; Peter Fenici, AstraZeneca, Rome, Italy; John J. Sheehan, AstraZeneca, Fort Washington, PA; Mikhail Kosiborod, Saint Luke's Mid America Heart Inst, Kansas City, MO	135	126
The Relationship of Changing Hospital Readmission Rates and Mortality Rates After Hospitalization for Heart Failure, Acute Myocardial Infarction, and Pneumonia	Kumar Dharmarajan , Yale Sch of Med, New Haven, CT; Yongfei Wang, Ctr for Outcomes Res and Evaluation, New Haven, CT; Susannah Bernheim, Yale Sch of Med, New Haven, CT; Zhenqiu Lin, Ctr for Outcomes Res and Evaluation, New Haven, CT; Leora Horwitz, NYU Sch of Med, New York, NY; Joseph Ross, Nihar Desai, Lisa Suter, Elizabeth Drye, Yale Sch of Med, New Haven, CT; Sharon-Lise T. Normand, Harvard Medical Sch, Boston, MA; Harlan Krumholz, Yale Sch of Med, New Haven, CT	136	127
Clinical Outcomes After Cardiac Stress Testing Among U.S. Patients Younger Than 65, 2006-2012	Vinay Kini , Univ of Colorado Sch of Med, Aurora, CO; Elias Dayoub, Univ of Pennsylvania Sch of Med, Philadelphia, PA; Lucas Marzec, Miriam Dickinson, Matthew Wynia, Frederick Masoudi, Michael Ho, Univ of Colorado Sch of Med, Aurora, CO; Peter Groeneveld, Univ of Pennsylvania Sch of Med, Philadelphia, PA	137	128
Abstract Poster Session II Monday, April 3, 2017 12:30–2:00 PM <i>Salon I and II</i>			
Abstract Title	Author Block	Presentation Number	Board Number
Impact of Depressive Disorder on Access to Care and Quality of Care in Veterans With Cardiovascular Disease	Pallavi Srivastava , Matthew Lacey, Javed Butler, A. Laurie Shroyer, Puja B. Parikh, Stony Brook Univ Medical Ctr, Stony Brook, NY	138	2
Comparison of Access to Care and Quality of Care in Veterans versus Non-veterans With Cardiovascular Disease	Pallavi Srivastava , Matthew Lacey, Javed Butler, A. Laurie Shroyer, Puja B. Parikh, Stony Brook Univ Medical Ctr, Stony Brook, NY	139	3
Effects of Smoking Co-Morbidities and Obesity on Non-Hemorrhagic Stroke Outcomes	Danielle Amato , Justin Pieper, Michael Ashamalla, Mikhail Torosoff, Albany Medical Coll, Albany, NY	140	4
Increasing Storage Age of Transfused Red Blood Cell Units Is Not Associated with Cardiac Surgical Outcomes	Anton Camaj , Univ of Michigan Medical Sch, Ann Arbor, MI; Xiaoting Wu, Min Zhang, Univ of Michigan, Ann Arbor, MI; Milo Engoren, Jonathan W. Haft, Donald S. Likosky, Univ of Michigan Medical Sch, Ann Arbor, MI	141	5
Increasing Appropriate Statin Use in the Primary Care Clinic	Aditya K. Khetan , Univ Hosp/Case Western Reserve Univ, Cleveland, OH; Omer Khan, Umar Rashid, Christopher Pleyer, Mamta Singh, Louis Stokes Cleveland VA Medical Ctr, Cleveland, OH	142	6

Poster Sessions (continued)

Abstract Title	Author Block	Presentation Number	Board Number
Procedural Efficacy in Radial vs. Femoral Approach in Coronary Catheterization and Percutaneous Intervention in a Tertiary Care Teaching Hospital	Vishesh Kumar , Jimmy Yee, Jimmy Higgins, Amornpol Anuwatworn, Alex Pham, Tomasz Stys, Univ of South Dakota, Sioux Falls, SD	143	7
Perceived Risks and Safety of Transfusions Influence a Provider's Inclination to Transfuse	Raymond J. Strobel , Univ of Michigan Medical Sch, Ann Arbor, MI; Darin B. Zahuranec, Univ of Michigan Dept of Neurology, Ann Arbor, MI; Gaetano Paone, Henry Ford Hosp Div of Cardiac Surgery, Detroit, MI; Robert S. Kramer, Tufts Univ Sch of Med Div of Cardiothoracic Surgery, Boston, MA; Alphonse DeLucia III, Bronson Methodist Hosp Dept of Cardiac Surgery, Kalamazoo, MI; Warren D. Behr, Bronson Blood Management, Kalamazoo, MI; Min Zhang, Univ of Michigan Dept of Biostatistics, Ann Arbor, MI; Milo C. Engoren, Univ of Michigan Dept of Anesthesiology, Ann Arbor, MI; Richard L. Prager, Donald S. Likosky, Univ of Michigan Dept of Cardiac Surgery, Ann Arbor, MI; Michigan Society of Thoracic and Cardiovascular Surgeons Quality Collaborative	144	8
Use of Bromocriptine in the Management of Peripartum Cardiomyopathy: A Systematic Review	Garly Rushler Saint Croix, Michel Ibrahim , Sandra Chaparro, Jackson Memorial Hosp/Univ of Miami Health System, Miami, FL	145	9
Evaluation of Out-of-hospital Ventricular Fibrillation Cardiac Arrest Management, With a Simulation Method	Cécile Ursat , Guillaume Douge, Charles Groizard, Anna Ozguler, Michel Baer, Thomas Loeb, SAMU92, Garches, France	146	10
Subtle Degrees of Frailty Result in Adverse Cardiac Surgery Outcomes	Emma Wilson-Pease , George Kephart, Dalhousie Univ, Halifax, NS, Canada; Ryan Gainer, Jahanara Begum, Greg M Hirsch, Nova Scotia Health Authority, Halifax, NS, Canada	147	11
American Heart Association Athlete Prescreening Recommendations: An Evaluation of Knowledge and Compliance	Michael A. Witcik, Gundersen Health System, La Crosse, WI; Alexa A. Ernst, Angela L Smith, Andrew J. Borgert, Gundersen Medical Fndn, La Crosse, WI; Susan G. Maclellan-Tobert , Gundersen Health System, La Crosse, WI	148	12
Echocardiographic Reporting and Subsequent Referral to a Pulmonary Hypertension Clinic	Bruce W. Andrus , Malachy J. Sullivan, Randolph E. Brown, Terrence D. Welch, Timothy A. Beaver, Salvator P. Costa, Dartmouth Hitchcock Medical Ctr, Lebanon, NH	149	13
Machine Learning Methodology Predicts Comorbidities are Associated With Increased Total Healthcare Costs Among Patients With Severe Peripheral Artery Disease	Jeffrey S. Berger , NYULMC Ctr for the Prevention of Cardiovascular Disease, New York, NY; Lloyd Haskell, Janssen Scientific Affairs, LLC, Raritan, NJ; Windsor Ting, Mt. Sinai Health System, New York, NY; Fedor Lurie, Jobst Vascular Inst, Toledo, OH; Zubin Eapen, Duke Univ Medical Ctr, Durham, NC; Matthew Valko, Veronica Alas, Kelly Rich, GNS Healthcare, Cambridge, MA; Concetta Crivera, Jeff Schein, Janssen Scientific Affairs, LLC, Raritan, NJ	150	14
Patient Decision Support in Implanted Defibrillator Care: A Human Rights-Based Assessment Model	Ian Henry, Univ of Southern California, Los Angeles, CA; Christopher Knoepke , Univ of Colorado, Aurora, CO	151	15
Adherence to Rivaroxaban versus Apixaban Among Patients With Atrial Fibrillation: Analysis of Overall Population and Subgroups of Prior Oral Anticoagulant Users	Colleen A. McHorney, Evidera, Bethesda, NJ; Concetta Crivera, Janssen Scientific Affairs, LLC, Raritan, NJ; François Laliberté , Guillaume Germain, Willy Wynant, Patrick Lefebvre, Groupe d'Analyse Ltée, Montreal, QC, Canada	152	16

Poster Sessions (continued)

Abstract Title	Author Block	Presentation Number	Board Number
Rural Systems of Care: Real World Observations and Trends in ST Elevation Myocardial Infarction Patient Characteristics, and Correlations of Arrival Mode to Outcomes	Scott Mikesell , St. Luke's Hosp, Duluth, MN; Jeffrey Sather, Trinity Health, Minot, ND; John Gallagher, Wichita:Sedgwick County EMS, Wichita, KS; Richard Mullvain, Essentia Health, Duluth, MN; Tomasz Stys, Sanford Health, Sioux Falls, SD; Mindy Cook, American Heart Association, Minneapolis, MN; Gary Myers, American Heart Association, Sioux Falls, SD; Michelle Scharnott, American Heart Association, Milwaukee, WI	153	17
Adherence to Rivaroxaban Compared to Other Oral Anticoagulant Agents Among Patients With Non-Valvular Atrial Fibrillation	Colleen A. McHorney, Evidera, Bethesda, MD; Veronica Ashton, Janssen Scientific Affairs, LLC, Raritan, NJ; François Laliberté , Guillaume Germain, Willy Wynant, Groupe d'Analyse Ltée, Montreal, QC, Canada; Concetta Crivera, Jeffrey Schein, Janssen Scientific Affairs, LLC, Raritan, NJ; Patrick Lefebvre, Groupe d'Analyse Ltée, Montreal, QC, Canada; Eric Peterson, Duke Clinical Res Inst, Durham, NC	154	18
Prevalence and Clinical Correlates of Left Ventricular Hypertrophy by Sokolow-Lyon and Cornell Electrocardiogram Voltage Criteria in Transcatheter Aortic Valve Replacement Patients	Emily Xiao , Augustin Delago, Mohammad El-Hajjar, Batyrjan Bulibek, Mikhail Torosoff, Albany Medical Ctr, Albany, NY	155	19
Acute Ischemic Stroke Care and Outcomes in Teaching and Nonteaching Hospitals:Results From China National Stroke Registry Study	Yang Xin , Li Zixiao, Gu Hongqiu, Wang Yilong, Wang Yongjun, Beijing Tiantan Hosp, Capital Med Univ, Beijing, China	156	20
Assessing Physician Knowledge Regarding Indications for a Primary Prevention Implantable Defibrillator and Potential Barriers for Referral	Rochelle C. Bernier , Univ of Alberta, Edmonton, AB, Canada; Satish R. Raj, Lucy Reyes, Univ of Calgary, Calgary, AB, Canada; Michael Sauve, Univ of Alberta, Edmonton, AB, Canada; Glen L. Sumner, Derek V. Exner, Univ of Calgary, Calgary, AB, Canada; Roopinder K. Sandhu, Univ of Alberta, Edmonton, AB, Canada	157	21
Health Care Access Among Young Adults With Hypertension - The Impact Of Extended Dependent Coverage	Jing Fang , Guijing Wang, Carma Ayala, Fleetwood Loustalot, CDC/NCCDPHP, Atlanta, GA	158	22
Evaluation of Clinical Outcomes among Nonvalvular Atrial Fibrillation Patients Treated With Warfarin or Rivaroxaban Stratified by Presence or Absence of CKD in a Claims Database	Matthew R. Weir, Div of Nephrology, Dept of Med, Univ of Maryland Sch of Med, Baltimore, MD; Lloyd Haskell, Janssen Scientific Affairs, LLC, Raritan, NJ; Jeffrey S. Berger, New York Univ Sch of Med, New York, NY; Veronica Ashton, Janssen Scientific Affairs, LLC, Raritan, NJ; François Laliberté , Groupe d'analyse, Montreal, QC, Canada; Concetta Crivera, Janssen Scientific Affairs, LLC, Raritan, NJ; Kip Brown, Patrick Lefebvre, Groupe d'analyse, Montreal, QC, Canada; Jeffrey Schein, Janssen Scientific Affairs, LLC, Raritan, NJ	159	23
Impact of Medication Adherence on Risk of Stroke, Major Bleeding and Other Outcomes in Atrial Fibrillation Patients Using Novel Oral Anticoagulants (Dabigatran and Rivaroxaban)	Chinmay G. Deshpande , Cynthia Willey Temkin, Robert Laforge, Stephen Kogut, Univ of Rhode Island, Kingston, RI	160	24
Lean Process Improvements Reduce Door to CT and Door to Needle Times for Acute Ischemic Stroke Patients	Cory McCann , Aleks Tkach, Adam de Havenon, Joel Loosli, Jamie Troyer, Alicia Bennett, Jana Wold, Alicia Jex, Jennifer J. Majersik, Univ of Utah, Salt Lake City, UT	161	25

Poster Sessions (continued)

Abstract Title	Author Block	Presentation Number	Board Number
Evolution of Acute Coronary Syndrome Treatment During Last Years in Russian Hospitals (Based on Results of RECORDS Registries)	Alexey D. Erlikh , Federal State Inst Scientific Res Inst of Physical-Chemical Med, Moscow, Russian Federation	162	26
Aortic Valve Replacement Confers a Survival Benefit in Patients With Severe Aortic Insufficiency With Depressed Left Ventricular Ejection Fraction	Amy Fiedler , Vijeta Bhambhani, Elizabeth Laikhter, Michael Picard, Thoralf Sundt III, Jason Wasfy, The Massachusetts General Hosp, Boston, MA	163	27
Impact of Sex and Race on the Likelihood of Mortality, Cardiology Consultation, and Coronary Angiography Among Hospitalized Patients Evaluated With Cardiac Troponin	David E. Winchester , Christopher Estel, Kristopher Kline, Sean Taasan, Ki Park, Jingnan Zhang, Jonathan Shuster, Univ of Florida, Gainesville, FL	164	28
Total Intravenous Anesthesia as Compared to Volatile Anesthesia is Associated with Reduced Length of Stay After Transcatheter Aortic Valve Replacement: Results From Two-Year Program at Major Academic Medical Center	Allie Goins , Univ of North Carolina Sch of Med, Chapel Hill, NC; Paula Strassle, Univ of North Carolina Dept of Epidemiology, Chapel Hill, NC; Cassandra Ramm, Univ of North Carolina Dept of Cardiology, Chapel Hill, NC; Emily Teeter, Alan Smeltz, Univ of North Carolina Dept of Anesthesia, Chapel Hill, NC; Thomas Caranansos, Univ of North Carolina Dept of Cardiothoracic Surgery, Chapel Hill, NC; John Vavalle, Univ of North Carolina Dept of Cardiology, Chapel Hill, NC; Lavinia Kolarczyk, Univ of North Carolina Dept of Anesthesia, Chapel Hill, NC	165	29
Female Gender Disparity Observed in STEMI System Time Performance Metrics	Richard Mullvain , Essentia Health, Duluth, MN; Mallory Bosch, Essentia Health, Fargo, ND; Nancy Hassinger, Essentia Health, Duluth, MN; Samantha Kapphahn, Essentia Health, Fargo, ND; Lynn Howard, Michael Mollerus, Essentia Health, Duluth, MN	166	30
Correlation of 30-day Hospital Readmission Rates by Payer and Penalty Status	Neel M. Butala , Massachusetts General Hosp, Boston, MA; Daniel B. Kramer, Jordan B. Strom, Beth Israel Deaconess Medical Ctr, Boston, MA; Kevin F. Kennedy, St. Luke's Health System, Kansas City, MO; Robert W. Yeh, Beth Israel Deaconess Medical Ctr, Boston, MA	167	31
Racial and Ethnic Differences in Contemporary Use of Left Ventricular Assist Device	Khadijah Breathett , Larry A. Allen, Laura Helmkamp, Kathryn Colborn, Stacie L. Daugherty, Univ of Colorado, Aurora, CO; Irene V. Blair, Univ of Colorado, Boulder, CO; Jacqueline Jones, Prateeti Khazanie, Richard Lindrooth, Pamela N. Peterson, Univ of Colorado, Aurora, CO	168	32
Early Intravenous Beta-Blockers in Patients With ST-Segment Elevation Myocardial Infarction	Abhishek Sharma , State Univ of New York, Downstate Medical Ctr, Brooklyn, NY; Samin Sharma, Dept of Cardiovascular Med, Heart & Vascular Inst, Mount Sinai Medical Ctr, Icahn Sch of Med at Mount Sinai, New York, New York, NY; Debabrata Mukherjee, Texas Tech Univ, El Paso, TX; Akash Garg, James J. Peters VA Medical Ctr, Mount Sinai Sch of Med, New York, NY; Carl Lavie, John Ochsner Heart and Vascular Inst, Ochsner Clinical Sch-the Univ of Queensland Sch of Med, New Orleans, New Orleans, LA; Jonathan Marmur, State Univ of New York, Downstate Medical Ctr, Brooklyn, NY	169	33

Poster Sessions (continued)

Abstract Title	Author Block	Presentation Number	Board Number
Epxheartfailure Detects Decompensations And Improves Symptom Stability for Patients With Heart Failure – A Community Implementation	Kunjan Patel , Eric Sink, Saint Louis Univ Sch of Med, Saint Louis, MO; Kavon Javaherian, Washington Univ Sch of Med, Saint Louis, MO; Wint Yan Aung, Saint Louis Univ Sch of Med, Saint Louis, MO; Jacob Groenendyk, Kelly Dodds, Gregory Ewald, Washington Univ Sch of Med, Saint Louis, MO	170	34
Improving Adherence to Antihypertensive Agents for Hypertensive Patient With Chronic Kidney Disease	Yunyun Li Sr. , Xianghong Zeng, Chengdu Red Cross Hosp, Chengdu, China; Xiangji Zeng, Chengdu Univ, Chengdu, China; Jianguan Xie, VIP Clinic of Shenzhen Healthcare Committee, Shenzhen, China	171	36
Ticagrelor Use in Acute Coronary Syndrome: A Real-World Experience	Paolo P. Gabriel , Tyler Sledge, Teshia Sorensen, Kristen Cornachione, Jack Morshedzadeh, Theophilus Owan, Rashmee U. Shah, Univ of Utah Health Sciences Ctr, Salt Lake City, UT	172	37
Simple Guidance Improves Appropriate Telemetry Utilization	Alekhya Potluri , Mrudula Kudaravalli, Anthony Defail, Dilip Prabhakaran, Sangita Prabhakaran, James B. Reilly, Anastasios Kapetanos, Allegheny Health Network, Pittsburgh, PA	173	38
The Longitudinal Effect of Medicaid Expansion on 30-Day Readmissions for Heart Failure and Acute Myocardial Infarction - Insights from Hospital Compare	Ankeet S. Bhatt , Azalea Kim, Duke Univ Health System, Durham, NC; William K. Bleser, Robert Saunders, Duke Univ Margolis Ctr for Health Policy, Washington, DC; Zubin J. Eapen, Duke Univ Health System, Durham, NC	174	39
Development of a National Dataset for Ambulatory Quality Improvement and Research: Insight From The Guideline Advantage™	James R. Langabeer II , The Univ of Texas Health Science Ctr, Houston, TX; Yosef Kahn, Michele Bolles, Katy Vennum, Katherine Kuban, American Heart Association, Dallas, TX	175	40
Door to Needle Targets in the Real World: A Dynamic Statistical Tool for Institutional Stroke Code Metrics	Benjamin Y. Andrew , Matthew E. Ehrlich, Colleen M. Stack, Julian P. Yang, Jodi A. Dodds, Duke Univ Sch of Med, Durham, NC	176	41
Similar Outcomes Among Patients With Clinically Silent Hemoglobin Drop and Patients With Overt Bleeding Following Percutaneous Coronary Intervention	Ahmed Farawi , Paula D. Strassle, Rahul Jaswaney, Christopher End, George A. Stouffer, Univ of North Carolina Chapel Hill, Chapel Hill, NC; Prashant Kaul, Piedmont Heart Inst, Atlanta, GA; John P. Vavalle, Univ of North Carolina Chapel Hill, Chapel Hill, NC	177	42
Byvalson Fixed-Dose Combination for the Treatment of Hypertension: A Comprehensive Review	Charles E. Wight , Nicole Jara, Chelsea Harlan, Paul Petrillo, Mara N. Poulakos, Palm Beach Atlantic Univ, West Palm Beach, FL	178	43
Short Length of Stay After Elective Transfemoral Transcatheter Aortic Valve Replacement is Not Associated With Increased Early or Late Readmission Risk	Maneesh Sud , Univ of Toronto, Toronto, ON, Canada; Feng Qui, Peter C. Austin, Inst for Clinical Evaluative Sciences, Toronto, ON, Canada; Dennis T. Ko, Sunnybrook Health Sciences Ctr, Toronto, ON, Canada; David Wood, Vancouver General Hosp and St. Paul's Hosp, Toronto, ON, Canada; Andrew Czarnecki, Vaidehi Patel, Sunnybrook Health Sciences Ctr, Toronto, ON, Canada; Douglas S. Lee, Peter Munk Cardiac Ctr of the Univ Health Network, Toronto, ON, Canada; Harindra C. Wijeyesundera, Sunnybrook Health Sciences Ctr, Toronto, ON, Canada	179	44
Consultation to a Cardiologist Prior to Low Risk Procedures Generates Excessive Testing and Cost Without Affecting Outcomes in Patients with Stable Ischemic Heart Disease	Joseph Coffman , Thanh Tran, Kevin Kip, Michael S. Berlowitz, Sanders H Chae, Univ of South Florida, Tampa, FL	180	45

Poster Sessions (continued)

Abstract Title	Author Block	Presentation Number	Board Number
What's in the Black Box?: Describing Current Practice, Challenges, and Barriers of Cardiology and Palliative Care Collaboration	Rachel Wells , Gisella Mancarella, J. Nicholas Dionne-Odom, Univ of Alabama at Birmingham, Birmingham, AL; Colleen K McIlvennan, Univ of Colorado, Denver, CO; Sara E Wordingham, Mayo Clinic Coll of Med, Phoenix, AZ; Sara Goodlin, Portland Veterans Affairs Medical Ctr and Patient-Ctred Education and Res, Portland, OR; Elizabeth Blume, Dept of Cardiology, Boston Children's Hosp, Boston, MA; Stephanie Cooper, Cardiology Div, Dept of Med, Univ of Washington, Seattle, WA; Richard Josephson, Case Western Reserve Univ, Cleveland, OH; Karen Alexander, Duke Univ, Durham, NC; Abby Cestoni, American Coll of Cardiology, Washington D.C., DC; Matthew Maurer, NewYork-Presbyterian Hosp/Columbia Univ Medical Ctr, New York, NY; Paul Hauptman, Saint Louis Univ Sch of Med, Saint Louis, MO; James Kirkpatrick, Univ of Washington, Seattle, WA; Marie Bakitas, Keith M Swetz, Univ of Alabama at Birmingham, Birmingham, AL; American College of Cardiology- Palliative Care Working Group of the Geriatrics Section	181	46
Heart Transplantation Patients in the Medicare Population: Outcomes, Costs and Readmission Rates	Fenton McCarthy , Desmond Graves, Danielle Savino, Amanda Chin, Danielle Spragan, Taylor Dibble, Ashley Hoedt, Katherine McDermott, Keith Dufendach, Peter Groeneveld, Joseph Bavaria, Wilson Szeto, Nimesh Desai, Univ of Pennsylvania, Philadelphia, PA	182	48
Safety and Utility Outcomes of Off-label Magnetic Resonance Imaging on Patients With Cardiovascular Implantable Electronic Devices	Jordan B. Strom , Jill B. Whelan, ShuangQi Zheng, Daniel B. Kramer, Beth Israel Deaconess Medical Ctr, Boston, MA	183	49
Quality Improvement of Statin Therapy Appropriateness in Type 2 Diabetic Patients	Dan L. Li , Erika Diaz Narvaez, Chioma Onyekwelu, Eleanor M. Weinstein, Robert T. Faillace, Jacobi Medical Ctr, Albert Einstein Coll of Med, Bronx, NY	184	47
The Relationship of Ambulatory Visit Frequency and Hypertension Control Among Young Adults	Cecile C. King , Christie M. Bartels, Univ of Wisconsin Sch of Med and Public Health, Madison, WI; Elizabeth M. Magnan, Univ of California – Davis, Davis, CA; Jennifer T. Fink, Univ of Wisconsin – Milwaukee, Milwaukee, WI; Maureen A. Smith, Heather M. Johnson, Univ of Wisconsin Sch of Med and Public Health, Madison, WI	185	50
Rates and Causes of Short Term Rehospitalization Across the Spectrum of Age and Insurance Types in the United States	Jordan B. Strom , Daniel B. Kramer, Richard A. and Susan F. Smith Ctr for Cardiovascular Outcomes Res, Beth Israel Deaconess Medical Ctr, Boston, MA; Yun Wang, Dept of Biostatistics, Harvard T. H. Chan Sch of Public Health, Boston, MA; Jason H. Wasfy, Div of Cardiology, Massachusetts General Hosp, Boston, MA; Bruce E. Landon, Dept of Healthcare Policy, Harvard Medical Sch, Boston, MA; Robert W. Yeh, Richard A. and Susan F. Smith Ctr for Cardiovascular Outcomes Res, Beth Israel Deaconess Medical Ctr, Boston, MA	186	51
Sex-related Differences in Discharge Disposition for STEMI Care	James R. Langabeer II , The Univ of Texas Health Science Ctr, Houston, TX; Timothy D. Henry, Cedar-Sinai Heart Inst, Los Angeles, CA; Raymond Fowler, The Univ of Texas Southwestern Medical Ctr, Dallas, TX; Tiffany Champagne-Langabeer, The Univ of Texas Health Science Ctr, Houston, TX; Alice Jacobs, Boston Univ Medical Ctr, Boston, MA	187	52

Poster Sessions (continued)

Abstract Title	Author Block	Presentation Number	Board Number
Hospital and Regional Variation in Use of High-intensity Statins Following Myocardial Infarction Among Medicare Beneficiaries	Emily B. Levitan , Paul Muntner, Yu Ling Dai, Univ of Alabama at Birmingham, Birmingham, AL; Mark Woodward, George Inst for Global Health, Sydney, Australia; Matthew Mefford, Lisandro D. Colantonio, Univ of Alabama at Birmingham, Birmingham, AL; Robert S. Rosenson, Icahn Sch of Med at Mount Sinai, New York, NY; Keri L. Monda, Amgen Inc., Thousand Oaks, CA; Vera Bittner, Meredith L. Kilgore, Univ of Alabama at Birmingham, Birmingham, AL	188	53
Income Level Disparities in Consumer Reported Domains of Healthcare Experience Among Those With Established Atherosclerotic Cardiovascular Disease in United States: Insights From Medical Expenditure Panel Survey 2010-2013	Victor Okunrintemi , Baptist Health South Florida, Miami, FL; Erica Spatz, Yale Sch of Med, New haven, CT; Joseph Salami, Paul Di Capua, Baptist Health South Florida, Miami, FL; Haider Warraich, Duke Univ Sch of Med, Durham, NC; Salim Virani, Baylor Coll of Med, Houston, TX; Michael Blaha, Johns Hopkins Medical Insts, Baltimore, MD; Ron Blankstein, Brigham and Women's Hosp, Boston, MA; Harlan Krumholz, Yale Sch of Med, New Haven, CT; Khurram Nasir, Baptist Health South Florida, Miami, FL; Henry H. Ting, New York Acad of Med, New York, NY; Kumar Dharmarajan, Yale Sch of Med, New Haven, CT	189	54
Risk Factors and Outcomes of Hyperbilirubinemia Following Transcatheter Aortic Valve Replacement	Stephanie Jou , Li Zhang, Batyrjan Bulibek, Mohammad El-Hajjar, Augustin Delago, Mikhail Torosoff, Albany Medical Coll, Albany, NY	190	55
Identification of Adults With Congenital Heart Disease From Administrative Data	Jill M. Steiner , James N. Kirkpatrick, Susan R. Heckbert, J. Randall Curtis, Univ of Washington, Seattle, WA	191	56
Prompt Defibrillation and Epinephrine Treatment and Long-term Survival After In-hospital Cardiac Arrest	Krishna K. Patel , Yuanyuan Tang, Yevgeniy Khariton, Mid America Heart Inst, Kansas City, MO; Lesley H. Curtis, Duke Clinical Res Inst, Durham, NC; John A. Spertus, Paul S. Chan, Mid America Heart Inst, Kansas City, MO	192	57
Observation on Repeatability of Grading by Casual Blood Pressure in Hypertensives and New Proposal	Yong Liu , Zigong City Third People's Hosp, Zigong, China	193	58
Diagnostic Accuracy of ICD Coding Among Young Patients With Suspected Myocardial Infarction	Avinainder Singh , Bradley Collins, Sanjay Divakaran, Arman Qamar, Julio Baez, Josh Klein, Jon Hainer, Brigham and Women's Hosp, Boston, MA; Ravi Shah, Massachusetts General Hosp, Boston, MA; Marcelo Di Carli, Brigham and Women's Hosp, Boston, MA; Khurram Nasir, Baptist Health, Miami, FL; Deepak L. Bhatt, Ron Blankstein, Brigham and Women's Hosp, Boston, MA	194	59
Statin Use and Its Facility Level Variation in Patients With Ischemic Cerebrovascular Disease: Insights From the Department of Veterans Affairs	Cameron L. McBride , Julia Akaroyd, David J. Ramsey, Vijay Nambi, Baylor Coll of Med, Houston, TX; Khurram Nasir, Baptist Health South Florida, Miami, FL; Erin D. Michos, Ciccarone Ctr for the Prevention of Heart Disease – John Hopkins Univ Sch of Med, Baltimore, MD; Kim K. Birtcher, Univ of Houston Coll of Pharmacy, Houston, TX; Pamela B. Morris, Univ of South Carolina, Charleston, SC; Vera A. Bittner, Univ of Alabama at Birmingham, Birmingham, AL; Christie M. Ballentyne, Laura A. Peterson, Salim S. Virani, Baylor Coll of Med, Houston, TX	195	60
Gender-based Differences in Presentation and Treatment of Patients Undergoing Peripheral Vascular Intervention	Niveditta Ramkumar , The Dartmouth Inst for Health Policy and Clinical Practice, Lebanon, NH; Bjoern D. Suckow, Jack L. Cronenwett, Philip P. Goodney, Dartmouth-Hitchcock Medical Ctr, Lebanon, NH	196	61

Poster Sessions (continued)

Abstract Title	Author Block	Presentation Number	Board Number
Root Cause Analysis of 30-day Heart Failure Readmission Elucidates Acute Kidney Injury as a Common Offender	Devin Loewenstein , Brandon Scott, Nasim Afsarmanesh, Anna Dermenchyan, Gregg Fonarow, UCLA, Los Angeles, CA	197	62
WITHDRAWN		198	63
Lessons Learned From Patients Leaving Against Medical Advice in the Evaluation of Chest Pain: Can We Prevent Unnecessary Testing and Reduce Costs in Low Risk Patients?	Igor Sunjic, Sanders Chae, Michael Berlowitz , Univ of South Florida, Tampa, FL	199	64
Is Risk-standardized In-hospital Stroke Mortality an Adequate Proxy for Risk-standardized 30-day Stroke Mortality Data? Findings From the GWTG-Stroke Program	Mathew J. Reeves , Michigan State Univ, East Lansing, MI; Gregg C. Fonarow, UCLA, Los Angeles, CA; Haolin Xu, Roland Matsouaka, Ying Xian, Duke Clinical Res Inst, Durham, NC; Jeff Saver, UCLA, Los Angeles, NC; Lee H. Schwamm, Massachusetts General Hosp, Boston, MA; Eric E. Smith, Univ of Calgary, Calgary, AB, Canada	200	65
Distribution of Initial Treatment and First Modification of HFrEF Pharmacotherapy in a Medicare Managed Care Cohort	Nancy M. Albert , Cleveland Clinic Fndn, Cleveland, OH; Richard DeClue, Dana Drzayich Antol, Adrienne Waldman Casebeer, Yong Li, Stephen Stemkowski, Comprehensive Health Insights, Louisville, KY; Chun-Lan Chang, Novartis Pharmaceuticals Corp, East Hanover, NJ	201	66
Impact of Diagnosis Name Changes in the Comprehensive Medical Expenses Payment System on Medical Expenses in Japan	Toru Shirakawa, Hiroshi Matsumoto , Osaka Univeristy Graduate Sch of Med, Suita, Japan	202	67
Gender Differences in PCSK9 Inhibitor Prescribing	Susan Boklage , Joseph Elassal, Joseph Gervasio, Regeneron Pharmaceuticals, Inc., Tarrytown, NY; Rishab Gupta, Accenture, Inc., Florham Park, NJ	203	68
Trends in Emergency Department Visits for Chest Pain Suggestive of Coronary Artery Disease and Shortness of Breath Suggestive of Congestive Heart Failure	Aarti Patel , Zhijie Ding, Christine Eichelberger, Christopher Pericone, Jennifer Lin, Janssen Scientific Affairs, Titusville, NJ; Christopher W Baugh, Brigham and Women's Hosp, Boston, MA	204	69
Reassessing the Impact of Hospital PCI Volume on STEMI Outcomes	James R. Langabeer II , Univ of Texas Health Science Ctr, Houston, TX; Jeffrey Helton, Metropolitan State Univ, Denver, CO; Jungyun Kim, Univ of Texas Health Science Ctr, Houston, TX; Raymond Fowler, Univ of Texas Southwestern Medical Ctr, Dallas, TX	205	70
Abstract submission for QCOR 2017	Mariam Kashani , Arn Eliasson, Claire Fuller, Elaine Walizer, Ellen Turner, Nancy Tschiltz, Marilyn Grunewald, Joy Halsey, Renata Engler, Todd Villines, Marina Vernalis, Walter Reed Natl Military Medical Ctr, Bethesda, MD	206	71
Burden of Cardiovascular Disease (CVD) on Economic Cost. Comparison of Outcomes in US and Europe	Dalia Giedrimiene , Univ of Saint Joseph/Hartford Hosp, West Hartford, CT; Rachel King, Quinnipiac Univ/Sch of Med, North Haven, CT	207	72
Racial Disparities Affect In-hospital Mortality Rates Following Coronary Artery Bypass Grafting Among Patients With End-stage Renal Disease	Alexander V Sergeev , Ohio Univ, Athens, OH	208	73

Poster Sessions (continued)

Abstract Title	Author Block	Presentation Number	Board Number
Does a Level Playing Field Reduce Disparities in Quality of Care For Hispanics and Women With Acute Myocardial Infarction?	Tomás Romero , Univ of California, San Diego, La Jolla, CA; Kristina Greenwood, Sharp HealthCare, San Diego, CA; Dale Glaser, Univ of San Diego, San Diego, CA	209	74
Improving the Use of Biomarkers in HF: Effect of Online CME	Jelena Spyropoulos , Kelly Hanley, Medscape Education, New York, NY; Robin J. Trupp, Roche Diagnostics, Indianapolis, IN	210	75
Implications of the PEGASUS-TIMI 54 Trial for U.S. Clinical Practice	Steven M. Bradley , Minneapolis Heart Inst, Minneapolis, MN; Gregory Hess, Symphony Health and Univ of Pennsylvania, Conshohocken, PA; Patrick Stewart, Symphony Health, Conshohocken, PA; Ehrin Armstrong, VA Eastern Colorado Health Care System and Univ of Colorado Sch of Med, Denver, CO; Steven Farmer, George Washington Univ, Washington, DC; Jason Wasfy, Massachusetts General Hosp, Boston, MA; Javier Valle, Amneet Sandhu, Univ of Colorado Sch of Med, Aurora, CO; Thomas Maddox, VA Eastern Colorado Health Care System and Univ of Colorado Sch of Med, Denver, CO	211	76
Incidence of Depression and Anxiety in Patients With Durable Left Ventricular Assist Device	Stephanie G. Cooper , Sharon Whyte, Cole Hansell, Katelyn Horvath, Claudius W. Mahr, Nahush A. Mokadam, James Kirkpatrick, Univ of Washington Medical Ctr, Seattle, WA	212	77
Impact of Acute Heart Failure Length of Stay on Hospital Financials and Clinical Performance: Stakeholder Insights	Engels N. Obi , Novartis Pharmaceuticals Corp, East Hanover, NJ; Karen Van Nuys, Precision Health Economics, Los Angeles, CA; Dennis Scanlon, The Pennsylvania State Univ, University Park, PA; Jason Shafrin, Lara Yoon, Precision Health Economics, Los Angeles, CA; Alison R. Silverstein, Precision Health Economics, Oakland, CA; Donald Miller, Novartis Pharmaceuticals Corp, East Hanover, NJ; Dan Blumenthal, Massachusetts General Hosp, Boston, MA	213	78
A Blood-based Precision Medicine Test Score is Additive in Determining a Patient's Risk of Obstructive Coronary Artery Disease After Positive Myocardial Perfusion Imaging: Results From the PREDICT and COMPASS Studies	Alexandra Lansky , Yale Sch of Med, New Haven, CT; John McPherson, Vanderbilt Univ Medical Ctr, Nashville, TN; Nic Chronos, Cardiology Care Clinics, Eatonton, GA; Kari Schmitz, Jim Wingrove, Mark Monane, CardioDx, Inc., Redwood City, CA	214	79
The Treatment Quality of Patients With Non-ST Elevation Acute Coronary Syndrome: Association With In-hospital Outcomes, Predictors of Nonconformity With Guidelines	Alexey D. Erlikh , Federal Scientific-Clinical Ctr of Physical-Chemical Med, Moscow, Russian Federation; Vassily Kashtalap, Olga Barbarash, Res Inst for Complex Issues of Cardiovascular Diseases Under the Siberian Branch of the Russian Acad of Medical Sciences, Kemerovo, Russian Federation; Nikolay Gratsiansky, Federal Scientific-Clinical Ctr of Physical-Chemical Med, Moscow, Russian Federation; all participants of RECORD-3 registry	215	80
Effectiveness of Telehealth on Hypertension Management Among Disparate Populations: a Systematic Review	Farah M. Chowdhury , CDR Carma Ayala, Deborah Dalmat, Sharada Shantharam, Tiffany Chang, Zachary Russell, Xuanping Zhang, Ctrs for Disease Control and Prevention (CDC), Chamblee, GA	216	81
Prediction Outcomes Using Other People's Models	Paul Kolm , Tze Chiam, Matthew Esham, Sangita Godbole, Richard Caplan, Mitchell Fawcett, Willaim Weintraub, Christiana Care Health System, Newark, DE	217	82

Poster Sessions (continued)

Abstract Title	Author Block	Presentation Number	Board Number
Expanding a Learning Collaborative Model in Chicago to Improve Door to Needle for Stroke Thrombolysis: Raising the Bar	Shyam Prabhakaran , Northwestern Univ Feinberg Sch of Med, Chicago, IL; Renee M. Sednew, Kathleen O'Neill, American Heart Association, Midwest Affiliate, Chicago, IL	218	83
Interdisciplinary Education and Relationship Building Improve Communication and Coordination in Stroke Care	Shila Thorson , Jeffrey Sather, North Dakota Dept of Health, Bismarck, ND; Jerilyn Alexander, Trinity Health, Minot, ND; Mindy Cook, American Heart Association, Jamestown, ND	219	84
Early Assessment of Real-world Utilization and Dosing of Sacubitril/Valsartan in the US	Chun-Lan Chang , Novartis Pharmaceuticals Corp, East Hanover, NJ; Xue Song, Tina Willson, Truven Health Analytics, an IBM Company, Cambridge, MA; Carol Duffy, Novartis Pharmaceuticals Corp, East Hanover, NJ	220	85
Environmental Scan of Telemedicine Networks With Services for Hypertension Management, 2016	Carma Ayala , Zachary Russell, Farah Chowdhury, Tiffany Chang, Carla Mercado, CDC/NCCDPHP/DHDSP, Atlanta, GA	221	86
Use of a Decision Support Tool for Ischemic Stroke Treatment in a Telehealth System	Debbie Summers , Elizabeth Gialde, John A. Spertus, Carole Decker, Saint Lukes Hosp, Kansas City, MO	222	87
Impact of Differences in Once-vs Twice-Daily Medications Adherence on the Risk of Bleed and Stroke in Non-Valvular Atrial Fibrillation: Analysis of Randomized Trials and Claims Data Sources	Colleen A. McHorney, Evidera, Bethesda, MD; Eric D. Peterson, Duke Clinical Res Inst, Durham, NC; Mike Durkin, Veronica Ashton, Janssen Scientific Affairs, LLC, Raritan, NJ; François Laliberté , Groupe d'Analyse Ltée, Montreal, QC, Canada; Concetta Crivera, Janssen Scientific Affairs, LLC, Raritan, NJ; Naveed Sheikh, Guillaume Germain, Groupe d'Analyse Ltée, Montreal, QC, Canada; Jeffrey R. Schein, Janssen Scientific Affairs, LLC, Raritan, NJ; Yongling Xiao, Patrick Lefebvre, Groupe d'Analyse Ltée, Montreal, QC, Canada	223	88
Characterizing Quality of Life Responses and Physical Functioning Improvements to an Integrated Self-care Intervention for Persons With Co-morbid Heart Failure and Diabetes	Melinda Higgins , Carolyn Reilly, Rebecca Gary, Sandra Dunbar, Emory Univ, Decatur, GA; Brittany Butts, Univ of Alabama – Birmingham, Birmingham, AL; Javed Butler, Stony Brook Univ, Stony Brook, NY	224	89
A Depression Quality Program and Cardiovascular Disease: Assessing the Impact on Care	Linda Gordon , Amanda Malecky, Andrew Althouse, UPMC, Pittsburgh, PA; Nicole Ansani, Pfizer, Inc, Pittsburgh, PA	225	90
Strokes Worse in Women at 24 hours but Severity Reduced in Younger Women with Hormone Therapy	Aliza Brown , Sanjeeva Onteddu, Renee Joiner, Tina Benton, William Culp, Curtis Lowery, Univ of Arkansas for Medical Sciences, Little Rock, AR	226	91
Healthcare Cost Impact of Continued Anticoagulation With Rivaroxaban Versus Placebo in the EINSTEIN-Extension Trial Population	Philip S. Wells, The Ottawa Hosp, Ottawa, ON, Canada; Anthonie W. A. Lensing, Bayer HealthCare AG, Wuppertal, Germany; Lloyd Haskell, Bennett Levitan, Janssen Scientific Affairs, LLC, Raritan, NJ; François Laliberté , Groupe d'analyse, Montréal, QC, Canada; Mike Durkin, Veronica Ashton, Janssen Scientific Affairs, LLC, Raritan, NJ; Yongling Xiao, Groupe d'analyse, Montréal, QC, Canada; Concetta Crivera, Janssen Scientific Affairs, LLC, Raritan, NJ; Dominique Lejeune, Groupe d'analyse, Montréal, QC, Canada; Jeff Schein, Janssen Scientific Affairs, LLC, Raritan, NJ; Patrick Lefebvre, Groupe d'analyse, Montréal, QC, Canada	227	92

Poster Sessions (continued)

Abstract Title	Author Block	Presentation Number	Board Number
Targeted Treatment of SIHD: Effectiveness of Personalized Learning-Based Medical Education	Jelena Spyropoulos , Catherine C. Capparelli, Medscape Education, New York, NY	228	93
Real-world hsCRP Testing, With a Potential to Evaluate Residual Inflammatory Cardiovascular Risk, Among Patients With History of Myocardial Infarction in the United States: A Retrospective Database Analysis	Celine Deschaseaux , Novartis Pharma AG, Basel, Switzerland; Puza Sharma, Novartis Pharmaceuticals Corp, NJ, NJ; Anders Gabrielsen, Novartis Sverige AB, Täby, Sweden; Athanasio Siadimas, Melissa Bauer, Novartis Global Service Ctr, Dublin, Ireland; Raymond Przybysz, Novartis Pharmaceuticals Corp, NJ, NJ	229	94
A Personalized Shared Decision Making Process Improves the Quality of Decision Making by Older Patients Referred for Cardiac Surgery	Ryan Gainer , Jahanara Begum, Emma Wilson-Peace, Greg Hirsch, Dalhousie Univ, Halifax, NS, Canada	230	95
Single Site Lifestyle Survey in FMD Patients Suggests Improvement Over Time	Sherry M. Bumpus , Eastern Michigan Univ, Ypsilanti, MI; Steven T. Heidt, Rachel Krallman, Eva Kline-Rogers, Univ of Michigan, Ann Arbor, MI	231	96
Minimizing Bleeding Complications in the Cardiac Catheterization Lab	William E. Lawson , Kellie Gumersell, Yvonne Leippert, Pamela Kostic, Lisa Wilbert, Christine Schuhmacher, Karen Sproul, Alison Rowe, John Dervan, Khurram Liaqat, SUNY Stony Brook, Stony Brook, NY	232	97
Practice Process Variability and Outcomes, Relation to Interventionalist Volume	William E. Lawson , Lisa A. Wilbert, Kellie Gumersell, Elisa Horbatuk, Theresa Leonard, Anna Dorney, Luis Gruberg, Anil Mani, Puja Parikh, Joseph Marmora, SUNY Stony Brook, Stony Brook, NY	233	98
Participation in a Virtual Community and Its Impact on Quality of Life and Perceived Support	Yosef Khan , American Heart Association, Dallas, TX; Kathleen Grady, Northwestern Univ, Chicago, TX; Lynne Braun, Rush Univ, Chicago, IL; Allison Groom, Katie Bahn, American Heart Association, Dallas, TX	234	99
Cost Effectiveness Analysis of Chinese Government Initiative of Dyslipidemia Interventions in Developed Community Clinical Practice	Jian Xu , Wenqing Ni, Zhipeng Zhuo, Weiye Yu, Shenzhen Ctr for Chronic Disease Control, Shenzhen, China; Ya Liu, Ruizhi Shi, Wei Yu, Pfizer, Beijing, China	235	100
Coronary Artery Procedures in the Cardiac Catheterization Laboratory After Overnight Call: Are Patients at Higher Risk?	Konstantinos Dean Boudoulas , Andrew Pederzoli, Haikady Nagaraja, Omar Kahaly, Raymond Magorien, Ernest Mazzaferri Jr, The Ohio State Univ, Columbus, OH	236	101
Breastfeeding is Not Associated With Worse Outcomes for Women With Peripartum Cardiomyopathy	Kris Kawamoto , Elizabeth Langen, Elizabeth A. Jackson, Melinda Davis, Univ of Michigan, Ann Arbor, MI	237	102
Evaluation of the Satisfaction of Emergency Medical Services' Staff, Attending Workshops on Maintaining and Improving Professional Skills and Knowledge	Cecile Ursat , Charles Groizard, Michel Baer, Anna Ozguler, Thomas Loeb, SAMU92, Garches, France	238	103
A Field Synopsis of the Role of Race in Clinical Prediction Models for Cardiovascular Disease	Jessica K. Paulus , Benjamin Wessler, Christine Lundquist, David M. Kent, Tufts Medical Ctr, Boston, MA	239	104

Poster Sessions (continued)

Abstract Title	Author Block	Presentation Number	Board Number
Prevalence of Intense Systolic Blood Pressure Control in Unselected Real World Non-Diabetic Hypertensive Patients	Ravinder Valadri , Sandhya Reddy, Chien-Wen Yang, Hussain Azizi, Dan Loughran, Estiban MercadoRodriguez, Deborah Spring, Maureen Litchman, The Wright Ctr for Graduate Medical Education, Edwardsville, PA; Emir Veledar, Heather Bloom, Emory Univ, Atlanta, GA; Samir Pancholy, The Wright Ctr for Graduate Medical Education, Edwardsville, PA	240	105
Abstract QCOR 2017	Samyukta Mullangi , Taylor Dawson, Elizabeth Paluga, Steven Kronick, Brahmajee Nallamotheu, Jennifer Stojan, Univ of Michigan Health System, Ann Arbor, MI	241	106
Influenza Seasonal Peak in Critical Congestive Heart Failure Hospitalizations	Ravinder Valadri , The Wright Ctr for Graduate Medical Education, Edwardsville, PA; Emir Veledar, Emory Univ, Atlanta, GA; Spring Deborah, Maureen Litchman, The Wright Ctr for Graduate Medical Education, Edwardsville, PA; Javed Butler, Stony Brook Univ, Stony Brook, NY; Samir Pancholy, The Wright Ctr for Graduate Medical Education, Edwardsville, PA	242	107
Organic Dissemination and Natural Implementation of Decision Aids for Left Ventricular Assist Device	Jocelyn S. Thompson , Daniel D. Matlock, Colleen K. McIlvennan, Megan Morris, Larry A. Allen, Univ of Colorado Sch of Med, Aurora, CO	243	108
Revision of the Consent Form for Coronary Angiography Procedures	Rosanna Tavella , The Univ of Adelaide, Central Adelaide Local Health Network, Adelaide, Australia; Luke Halliday, The Univ of Adelaide, Adelaide, Australia; Margaret Arstall, The Univ of Adelaide, Northern Adelaide Local Health Network, Adelaide, Australia; Matthew Worthley, The Univ of Adelaide, Central Adelaide Local Health Network, Adelaide, Australia; Derek Chew, Flinders Univ, Southern Adelaide Local Health Network, Adelaide, Australia; Chris Zeitz, John F. Beltrame, The Univ of Adelaide, Central Adelaide Local Health Network, Adelaide, Australia	244	109
Demonstrating the Effectiveness of an Outpatient Occupational Therapy Program for Individuals with Heart Failure	Olivia Carroll , Kristin Nxumalo, Amber Bennett, Whitney Pike, Univ of Southern California, Los Angeles, CA	245	110
Length of Stay and Its Association With Get With the Guidelines-stroke Award Recognition	Theresa Hamm, Mercy Medical Ctr – Des Moines, Des Moines, IA; Angela Overton, Univ of Iowa Hosp and Clinics, Iowa City, IA; Kathie Thomas , American Heart Association/American Stroke Association, Grand Rapids, MI; Renee Sednew, American Heart Association/American Stroke Association, Chicago, IL	246	111
A Randomized Controlled Study of a Platform to Maximize Patient Knowledge of Health Goals After Acute Myocardial Infarction	Robin Mathews , Peter Shrader, Vladimir Demyaneko, Vincent Miller, Laura Webb, Duke Clinical Res Inst, Durham, NC; Jeffrey W. Washam, Duke Univ Medical Ctr, Durham, NC; Eric D. Peterson, Tracy Y. Wang, Duke Clinical Res Inst, Durham, NC	247	112
Mortality and Readmission After Acute Myocardial Infarction in the Department of Veterans Affairs Health Care System	Paul L. Hess , Elise C Gunzburger, VA Eastern Colorado Health Care System, Denver, CO; Chuan-Fen Liu, VA Puget Sound Health Care System, Seattle, WA; Jacqueline Jones, Univ of Colorado Denver, Denver, CO; Daniel D. Matlock, VA Eastern Colorado Health Care System, Denver, CO; Paul A. Heidenreich, VA Palo Alto Health Care System, Palo Alto, CA; Cari R. Levy, Thomas M Maddox, Gary K. Grunwald, P. Michael Ho, VA Eastern Colorado Health Care System, Denver, CO	248	113
Dose-response Relationship Between the Risk of Vasovagal Syncope and Body Mass Index	Tomohide Yamada , Shintaro Yanagimoto, Univ of Tokyo, Tokyo, Japan	249	114

Poster Sessions (continued)

Abstract Title	Author Block	Presentation Number	Board Number
Role of First Degree Atrioventricular Block and Long Term Mortality in U.S. Veterans With Atherothrombotic Risk Factors	Amish Patel , Jonathan Pollock, Edward Sam Roberto, Thein Tun Aung, Ronald Markert, Ajay Agarwal, Wright State Univ/Dayton VA Medical Ctr, Dayton, OH	250	115
Long-term Outcomes and Implantable Cardioverter Defibrillator Use in Peripartum Cardiomyopathy	Madeline Mahowald, Nivedita Basu, Kris Kawamoto, Melinda Davis , Univ of Michigan, Ann Arbor, MI	251	116
Trust in the Medical Profession is Associated with Medication Adherence and Health-Related Quality of Life in Hispanic Adults with Hypertension	Lilia S. Meltzer , Ron D. Hays, UCLA, Los Angeles, CA	252	117
Out of Range INR Results Lead to Increased Health Care Utilization in Four Large Anticoagulation Clinics	Geoffrey D. Barnes , Xiaokui Gu, Eva Kline-Rogers, Chris Graves, Eric Puroll, Univ of Michigan, Ann Arbor, MI; Kevin Townsend, Ellen McMahon, Terri Craig, Pfizer, US Medical Affairs, New York, NY; James B. Froehlich, Univ of Michigan, Ann Arbor, MI	253	118
Persistent SES Disparities in Cardiovascular Risk Factors and Health in the United States: MEPS 2002-2013	Javier Valero-Elizondo , Tecnológico de Monterrey (ITESM), San Pedro Garza Garcia, Mexico; Erica S. Spatz, Yale Univ, New Haven, CT; Joseph A. Salami, Chukwuemeka U. Osondu, Baptist Health South Florida, Coral Gables, FL; Nihar R. Desai, Yale Univ, New Haven, CT; Jamal S. Rana, Kaiser Permanente Northern California, Oakland, CA; Salim S. Virani, Baylor Coll of Med, Houston, TX; Ron Blankstein, Brigham and Women's Hosp, Boston, MA; Michael J. Blaha, Johns Hopkins Univ, Baltimore, MD; Emir Veledar, Khurram Nasir, Baptist Health South Florida, Coral Gables, FL	254	119
Echocardiographic Evidence of Systemic Atherosclerosis in Patients Referred for Atrial Fibrillation	Efstratios Koutroumpakis , Elizabeth Rau, Benjamin Schwartz, John Espey, David Steckman, Mikhail Torosoff, Albany Medical Coll, Albany, NY	255	120
Cardiac CT in Ablation of Atrial Fibrillation	Ala Mohsen , Nicole Worden, Manju Bengaluru Jayanna, Michael Giudici, Univ of Iowa, Iowa City, IA	256	121
Urban Teaching and Non-Teaching Hospitals Outcomes: Myocardial Infarction	Priscilla O. Okunji , Johnnie Daniel, Howard Univ, Washington, DC	257	122
Prevalence and Clinical Correlates of LVH by Sokolow-Lyon and Cornell ECG Voltage Criteria in TAVR Patients	Robert Zhang , Emily Xiao, Tarek Ibrahim, Augustin Delago, Mohammad El-Hajjar, Mikhail Torosoff, Albany Medical Ctr, Albany, NY	258	123
Two Readily Obtainable Measures of Patient-reported Adherence and Their Association With Anticoagulation Control	Jonathan Sevilla-Cazes , Brian S. Finkleman, Jinbo Chen, Colleen M. Brensinger, Andrew E. Epstein, Perelman Sch of Med, Philadelphia, PA; Michael B. Streiff, Johns Hopkins Univ Sch of Med, Baltimore, MD; Stephen E. Kimmel, Perelman Sch of Med, Philadelphia, PA	259	124
A Qualitative Study of Patient-reported Challenges to Heart Failure Home Management	Jonathan Sevilla-Cazes , Perelman Sch of Med, Philadelphia, PA; Kathryn H. Bowles, Univ of Pennsylvania Sch of Nursing, Philadelphia, PA; Faraz S. Ahmed, Northwestern Univ Feinberg Sch of Med, Chicago, IL; Tom Gallagher, Patient Representative, Philadelphia, PA; Shreya Kangovi, Lee R. Goldberg, Lynn Alexander, Anne Jaskowiak, Frances K. Barg, Stephen E. Kimmel, Perelman Sch of Med, Philadelphia, PA	260	125

Author Index

Abdallah, H.....	084	Atreya, A. R.....	132, 133	Bob-manuel, T.....	100
Abecassis, M.....	077	Aune, C.....	106	Boklage, S.....	203
Abraham, P.....	050	Aung, T.....	114, 250	Boll, G.....	121
Abshire, M.....	062	Aung, W.....	170	Bolles, M.....	175
Abu Qamar, O.....	046	Austin, P. C.....	179	Borgert, A. J.....	148
Addae, L.....	115	Ayala, C.....	158, 221	Bosch, M.....	166
Adedinsewo, D.....	112, 115	Ayala, C.....	216	Botts, E.....	050
Adegbala, O.....	042, 065, 072	Azamina, P.....	070	Boudoulas, K.....	236
Adejumo, A.....	072	Azizi, H.....	240	Bowles, K. H.....	260
Adejumo, A. C.....	100	Baer, M.....	146, 238	Bradford, M.....	095
Adejumo, K.....	100	Baez, J.....	036, 194	Bradley, S. M.....	211
Adigun, R. O.....	019	Bahn, K.....	234	Brandel, M.....	050
Afsarmanesh, N.....	197	Bairey Merz, C. N.....	108	Braun, L.....	234
Agarwal, A.....	114, 250	Bakinde, N.....	112	Breathett, K.....	168
Ahmed, F. S.....	260	Bakitas, M.....	181	Breithardt, G.....	078
Ajayi, T.....	072	Ballantyne, C. M.....	060	Brensinger, C. M.....	259
Ajayi, T. O.....	100	Ballentyne, C. M.....	008, 195	Bress, A.....	125
Ajlan, M.....	129, 130	Banerjee, M.....	103	Brewer, L.....	020
Akaroyd, J.....	008, 195	Barbarash, O.....	215	Brosovich, D.....	074
Akeroyd, J. M.....	060	Bardy, G. H.....	053	Brown, A.....	226
Akinjero, A.....	042	Barg, F. K.....	260	Brown, K.....	159
Akintoye, E.....	065	Barnes, G. D.....	096, 253	Brown, R. E.....	149
Akinyemiju, T.....	042	Barrett, A. M.....	022	Brown, T. M.....	007
Akram, Y.....	041	Bartels, C. M.....	185	Budhathoki, C.....	062
Alas, V.....	150	Basu, N.....	092, 251	Budoff, M.....	070
Albert, N. M.....	201	Bauer, M.....	229	Budoff, M. J.....	043
Aldiwani, H.....	065	Baugh, C. W.....	204	Bulibek, B.....	155, 190
Alemah-Mensah, E.....	107	Bavaria, J.....	182	Bumpus, S. M.....	084, 095, 097, 098, 099, 231
Alexander, J.....	219	Bazzoli, G. J.....	027, 028	Burckhartt, B.....	106
Alexander, K.....	181	Beatty, A. L.....	059	Butala, N. M.....	167
Alexander, K. P.....	079	Beaver, T. A.....	149	Butler, J.....	138, 139, 224, 242
Alexander, L.....	260	Becker, R. C.....	078	Butts, B.....	224
Alkatiri, A. H.....	198	Begum, J.....	147, 230	Calcano, C.....	112
Al-Khatib, S. M.....	053	Behr, W. D.....	035, 144	Camaj, A.....	141
Allen, L. A.....	057, 168, 243	Bell, K.....	039	Caplan, R.....	217
Allen, L.....	055	Beltrame, J. F.....	244	Capparelli, C. C.....	228
Alliu, S.....	065, 100	Bengaluru Jayanna, M.....	256	Capua, P. D.....	189
Alliu, S. E.....	072	Bennett, A.....	161	Caranansos, T.....	165
all participants of RECORD-3 registry..	215	Bennett, A.....	245	Carroll, O.....	245
Almaddah, N.....	100	Benton, T.....	226	Carson, A. P.....	007
Almany, S. L.....	096	Berger, J. S.....	150, 159	Carter, J. D.....	085
Alphs Jackson, H.....	077	Berger, P. B.....	057	Castellano, P.....	004
Althouse, A.....	225	Berkowitz, S. D.....	078	Cativo, H.....	109
Alturkmani, H. J.....	091, 111	Berlowitz, M.....	033, 199	Cavendish, J. J.....	061
Amato, D.....	140	Berlowitz, M. S.....	180	Cestoni, A.....	181
American College of Cardiology – Palliative Care Wo, r.....	181	Berman, D. S.....	108	Chada, L.....	046
An, H.....	044	Bernheim, S.....	136	Chae, S.....	033, 199
Anantanarayan, M.....	120	Bernier, R. C.....	157	Chae, S. H.....	180
Anderson, A.....	077	Bethel, M. A.....	086	Chakrabarthi, A.....	103
Anderson, K. L.....	030	Beyth, R. J.....	017	Chakrabarti, A.....	038
Anderson, M. L.....	053	Bhambhani, V.....	014, 083, 110, 163	Chakravarty, A.....	039
Anderson, R. D.....	108	Bhardwaj, B.....	063	Chamberlain, A.....	020
Ando, T.....	065	Bhatt, A.....	082	Champagne-Langabeer, T.....	187
Andrew, B. Y.....	176	Bhatt, A. B.....	118	Chan, P. S.....	003, 057, 192
Andrus, B. W.....	149	Bhatt, A. S.....	174	Chang, C.-L.....	01, 220
Aneni, E. C.....	102	Bhatt, D.....	036	Chang, E.....	112
Annapureddy, A.....	071	Bhatt, D. L.....	030, 194	Chang, T.....	216, 221
Ansani, N.....	225	Bhatt, K.....	004	Chaparro, S.....	145
Ansell, J.....	057	Bhattatiry, M.....	128	Chariton, G.....	104
Anstrom, K. J.....	089	Bikdeli, B.....	041	Chaudhry, A.....	112
Antol, D.....	201	Birkeland, K.....	108	Che, J.....	064
Anugula, D.....	120	Birtcher, K. K.....	008, 195	Cheeran, D.....	118
Anuwatworn, A.....	143	Bittner, V.....	188	Chen, A. Y.....	010
Araki, M.....	011	Bittner, V. A.....	008, 195	Chen, F. Y.....	121
Arbel, R.....	073	Blaha, M.....	002, 189	Chen, J.....	259
Armstrong, E.....	211	Blaha, M. J.....	043, 254	Cheng, V.....	050
Armstrong, K.....	047, 110	Blair, I. V.....	168	Chew, D.....	244
Armstrong, P. W.....	086	Blankstein, R.....	002, 036, 046, 189, 194, 254	Chiam, T.....	217
Arnold, S. V.....	003, 013, 076, 079, 085, 135	Blecker, S.....	040	Chin, A.....	182
Arnold, S.....	055	Bleser, W. K.....	174	Chittle, M. D.....	117
Arstall, M.....	244	Blom, M.....	123	Choudhary, N.....	087
Ashamalla, M.....	140	Bloom, H.....	240	Choudhry, N. K.....	037
Ashton, V.....	015, 154, 159, 223, 227	Blume, E.....	181	Chowdhury, F.....	221
Atlas, S.....	047	Blumenthal, D.....	213	Chowdhury, F. M.....	216
		Blumenthal, R. S.....	043	Chronos, N.....	214

Author Index (continued)

Cimiotti, J.	069	Diwadkar, S.	033	Fortney, J. C.	059
Clark, C.	026, 032, 126	Djousse, L.	020	Fowler, R.	187, 205
Coffman, J.	180	Dodds, J. A.	176	Fox, K. A. A.	078
Colantonio, L. D.	007, 188	Dodds, K.	170	Freeman, J. V.	057
Colborn, K.	168	Dodson, J. A.	125	Froehlich, J. B.	096, 099, 253
Coleman, C.	015	Dorney, A.	233	Fudim, M.	016
Coleman, C. I.	071	Douge, G.	146	Fuller, C.	206
Collins, B.	036, 194	Dreyer, R.	067, 068	Gabriel, P. P.	172
Cook, M.	153, 219	Dreyer, R. P.	105	Gabrielsen, A.	229
Cook-Wiens, G.	108	Drye, E.	136	Gadde, S.	106
Cooper, S.	181	Dufendach, K.	182	Gaddipati, V.	033
Cooper, S. G.	048, 212	Duffy, C.	220	Gainer, R.	147, 230
Cornachione, K.	172	Dunbar, S.	224	Gallagher, J.	153
Cornel, J. H.	086	Dunlay, S. M.	019	Gallagher, T.	260
Coromilas, A. J.	088	Durkin, M.	223, 227	Gandhi, S.-C.C.	049
Costa, S. P.	149	Durojaiye, M.	072	Garcia, E.	087
Craig, T.	253	Durojaiye, M.	100	Garg, A.	169
Crim, M. T.	043	Durstenfeld, M. S.	040	Gary, R.	224
Crivera, C.	015, 150, 152, 154, 159, 223, 227	DuVall, S. L.	125	Gaviria, S. C.	046
Cronenwett, J. L.	196	Eagle, K. A.	095, 097, 098	George, M. G.	101
Cua, B.	056	Eapen, Z.	150	Germain, G.	152, 154, 223
Culp, W.	226	Eapen, Z. J.	174	Gersh, B.	057
Curtis, J. R.	191	Echouffo Tchegui, J. B.	127	Gersh, B. J.	127
Curtis, L. H.	192	Effoe, V.	115	Gervasio, J.	203
Czarnecki, A.	179	Effron, M. B.	089	Ghazinouri, R.	037
Dai, Y.	007, 188	Egbuche, O.	112	Gialde, E.	222
Dalmat, D.	216	Egbuche, O. E.	107, 115	Giedrimiene, D.	207
Daniel, J.	257	Ehrlich, M. E.	176	Giri, J. S.	006
Darehed, D.	123	Eichelberger, C.	204	Giudici, M.	256
Das, S.	118, 126, 128	Einhorn, D.	013, 135	Glader, E.-L.	123
Das, S. R.	026, 032	Elassal, J.	203	Glaser, D.	209
Daugherty, S. L.	168	El-Hajjar, M.	155, 190, 258	Go, A. S.	127
Davidson, C.	077	Eliasson, A.	206	Godbole, S.	217
Davidson, P. M.	062	Ellis, S.	074	Goins, A.	165
Davidson-Ray, L.	089	Elsayed, A.	033	Goldberg, L. R.	260
Davis, M.	092, 237, 251	Emmanuel, A.	072	Goodlin, S.	181
Davis, N.	069	End, C.	177	Goodney, P. P.	196
Dawson, T.	241	Engler, R.	206	Gordon, L.	225
Dayoub, E.	137	Engoren, M.	141	Gornik, H. L.	099
Deborah, S.	242	Engoren, M. C.	035, 144	Gosch, K.	056
Decker, C.	222	Enriquez, J.	010	Gosch, K. L.	111
DeClue, R.	201	Epstein, A. E.	259	Goyal, A.	004, 010, 013, 135
Deedwania, P. C.	085	Eriksson, M.	123	Grady, K.	234
Defail, A.	173	Erjavac, B.	097	Grady, K.	055
de Havenon, A.	161	Erlikh, A. D.	162, 215	Graetz, I.	028
Deitzelzweig, S. B.	081	Ernst, A. A.	148	Graham, G.	075, 105
Delago, A.	155, 190, 258	Esham, M.	217	Grahovec, A.	004
Delaney, L.	004	Espey, J.	255	Gratsiansky, N.	215
de la Rosa, A.	052	Estel, C.	164	Graves, C.	253
Delibasi, T.	086	Ewald, G.	170	Graves, D.	064, 182
DeLucia, A.	035, 144	Exner, D. V.	157	Green, D.	009
de Mol, B. A.	198	Ezekowitz, M. D.	057	Green, J. B.	086
Demyaneko, V.	247	Faillace, R. T.	184	Green, K. D.	016
Dennison Himmelfarb, C.	062	Fang, J.	158	Greene, L.	085
Dermenchyan, A.	197	Farawi, A.	177	Greenwood, K.	209
Dervan, J.	232	Fareed, N.	028	Grodzinsky, A.	063
Desai, N.	056, 136	Farkouh, M. E.	007	Groenendyk, J.	170
Desai, N. R.	041, 254	Farmer, S.	211	Groeneveld, P.	137, 182
Desai, N.	182	Fawcett, M.	217	Groeneveld, P. W.	006, 064
Desai, N. D.	064	Feldeisen, T.	098	Groizard, C.	146, 238
Desai, S.	062	Fendler, T.	063	Groom, A.	234
Deschaseaux, C.	229	Fendler, T.	055	Grenberg, D.	073
Deshmukh, U. U.	018	Fenici, P.	135	Gruberg, L.	233
Deshpande, C. G.	160	Ferris, T.	047	Grunewald, M.	206
Dhankhar, P.	039	Ferris, T. G.	014, 088, 117	Grunwald, G. K.	248
Dharmarajan, K.	136, 189	Fette, C.	097	Gu, H.	116, 122
Diaz Narvaez, E.	184	Fiedler, A.	163	Gu, X.	099, 253
Dibble, T.	182	Fink, J. T.	185	Guan, W.	001, 124
DiBenedetti, D. B.	022	Finkleman, B. S.	259	Guimaraes, P. O.	089
Di Carli, M.	036, 194	Fiorilli, P. N.	006	Gujjula, N. R.	120
Dickerman, B.	046	Fohtung, R.	113	Gullett, T.	074
Dickinson, M.	137	Fonarow, G.	197	Gumersell, K.	232, 233
Ding, Z.	204	Fonarow, G. C.	057, 200	Gunzburger, E. C.	248
Dionne-Odom, J.	181	Fonarow, G. C.	127	Gupta, K.	081
Divakaran, S.	036, 194	Fordey, C.	053	Gupta, R.	203
		Fortman, R.	077	Hacke, W.	078

Author Index (continued)

Haft, J. W.	141	Ibrahim, M.	145	Kimmel, S. E.	259, 260
Hainer, J.	036, 194	Ibrahim, T.	258	King, C. C.	185
Hall, M.	107	Ido, M. S.	009	King, M.	112
Hall, T.	038	Inzucchi, S. E.	013, 135	King, R.	207
Halliday, L.	244	Isselbacher, E. M.	117	Kini, V.	137
Halm, E. A.	026, 032	Iwata, S.	011	Kip, K.	033, 180
Halpin, D.	056	Jackson, E. A.	237	Kirkpatric, J.	048
Halsey, J.	206	Jacobs, A.	187	Kirkpatrick, J.	181, 212
Halvorsen, S.	086	Jacobsen, S. J.	061	Kirkpatrick, J. N.	191
Hamilton, M.	081	Janes, W. A.	130	Kiser, R. Y.	023
Hamm, T.	246	Jara, N.	178	Klein, J.	036, 194
Hammer, N.	135	Jaskowiak, A.	260	Kline, K.	164
Hammerman, A.	073	Jaswaney, R.	177	Kline-Rogers, E.	084, 095, 096, 097, 098, 099, 231, 253
Han, H.	062	Javaherian, K.	170	Knoepke, C.	151
Handberg, E. M.	108	Jelani, Q.-U.	105	Ko, D. T.	179
Hankey, G. J.	078	Jex, A.	161	Ko, Y.-A.	043
Hanley, K.	210	Jhamnani, S.	056	Koelling, T.	084, 098
Hansell, C.	048, 212	Ji, Y.	052	Kogut, S.	160
Hantz, S.	074	Jiang, L.	001, 124	Kolalapurdi, P.	119
Haperin, J. L.	078	Jingyan, W.	105	Kolarczyk, L.	165
Hara, M.	011	Jneid, H.	060	Kolli, S.	103
Hargrove, W.	064	Johnson, H. M.	185	Kolm, P.	217
Harlan, C.	178	Joiner, R.	226	Kong, X.	096
Harrison, T. N.	061	Jones, J.	168, 248	Koshy, T. P.	128
Haskell, L.	150, 159, 227	Jones, P.	105	Kosiborod, M.	013, 135
Hassinger, N.	166	Jones, P.	067, 068, 091	Kosiborod, M. N.	111
Hauptman, P.	181	Jones, P. G.	003, 079	Kostic, P.	232
Hayashida, K.	011	Jones, P.	055	Koutroumpakis, E.	255
Haymart, B.	096	Jones, P.	075	Kowey, P.	127
Hays, R. D.	252	Josephson, R.	181	Kowey, P. R.	057
Healy, B.	046	Josse, R. G.	086	Kozlowski, J. H.	096
Hecht, M.	072	Jou, S.	190	Kraemer, D.	087
Heckbert, S. R.	191	Jurf, J.	050	Krallman, R.	084, 095, 097, 098, 099, 231
Heggen-Peay, C.	085	Juusola, J.	037	Kramer, D. B.	029, 167, 183, 186
Heidenreich, P.	093, 094	Kaatz, S.	096	Kramer, R. S.	035, 144
Heidenreich, P. A.	080, 131, 248	Kahaly, O.	236	Kravitz, K.	074
Heidt, S. T.	231	Kahn, Y.	175	Krishnamoorthy, A.	089
Helfrich, C. D.	017	Kalra, A.	030	Krishnamurthi, N.	134
Hellkamp, A.	053, 078	Kaltenbach, L. A.	089	Krol, G. D.	096
Helmkamp, L.	168	Kalwani, N. M.	117	Kronick, S.	241
Helton, J.	205	Kangovi, S.	260	Krumholz, H.	002, 136, 189
Henry, I.	151	Kansal, P.	077	Krumholz, H. M.	001, 041, 124
Henry, T. D.	187	Kanter, M. H.	061	Krumme, A.	037
Herman, L.	070	Kapadia, S.	074	Kuban, K.	175
Hernan, M.	046	Kapetanios, A.	034, 173	Kudaravalli, M.	173
Hess, G.	211	Kaplan, C. M.	027	Kumar, G.	030
Hess, P. L.	248	Kapphahn, S.	166	Kumar, M.	120
Hidrué, M.	047	Kashani, M.	206	Kumar, S.	037
Higashimori, A.	011	Kashtalap, V.	215	Kumar, V.	143
Higgins, J.	143	Kassar, K.	034	Kumbhani, D.	128
Higgins, M.	224	Katz, S. D.	040	Kunka, A.	024
Hira, R. S.	060	Kaufman, B. G.	057	Lacey, M.	138, 139
Hirsch, A.	056	Kaul, P.	177	Ladapo, J.	070
Hirsch, G.	230	Kawamoto, K.	092, 237, 251	LaFleur, J.	125
Hirsch, G. M.	147	Kedan, I.	108	Laforge, R.	160
Hirsch, G. M.	031	Kennedy, K. F.	167	Lagu, T.	132, 133
Hirshman, B.	050	Kent, D. M.	129, 130, 239	Laikhter, E.	014, 163
Ho, M.	137	Kephart, G.	147	Laliberté, F.	015, 152, 154, 159, 223, 227
Ho, P. M.	059	Kerkar, P. G.	030	Lan, Y.	051
Ho, P.	248	Keshishian, A.	081	Landon, B. E.	186
Hoedt, A.	182	Khalessi, A.	050	Langabeer, J. R.	175, 187, 205
Hollingsworth, J. M.	058	Khan, O.	142	Langdon, K.	004
Holman, R. R.	086	Khan, Y.	234	Langen, E.	237
Hongqiu, G.	156	Khandwalla, R. M.	108	Lankford, B.	107
Horbatuk, E.	233	Khariton, Y.	076, 192	Lansky, A.	214
Horblyuk, R.	081	Kharrazian, D.	046	Lauffenburger, J.	037
Horvath, K.	048, 212	Khatana, S. M.	006	Lavie, C.	169
Horwitz, L.	136	Khazanie, P.	168	Lawhorn, S.	063
Hou, L.	124	Khetan, A. K.	142	Lawson, W. E.	232, 233
Howard, B.	004	Khosravanipour, M.	004	Lee, D. S.	179
Howard, L.	166	Khot, U.	074	Lee, H.	109
Howell, G.	063	Kilgore, M. L.	188	Lee, I.	041
Huang, L.	070	Kim, A.	174	Lee, J.	037
Huded, C.	074	Kim, E. S. H.	099		
Hussain, K.	098	Kim, J.	205		
Hylek, E. M.	127	Kim, S.	057		

Author Index (continued)

Lee, K. L.....	053	Maniet, B.....	070	Mutharasan, R.....	077
Lefebvre, P.....	015, 152, 154, 159, 223, 227	Mappangara, I.....	198	Myers, G.....	153
Leippert, Y.....	232	Mardekian, J.....	081	Naccarelli, G. V.....	057
Lejeune, D.....	227	Mark, D. B.....	053, 089	Nadkarni, A.....	081
Lenihan, D.....	101	Markert, R.....	114, 250	Naganuma, T.....	011
Lensing, A. W.....	227	Markwell, S.....	113	Nagaraja, H.....	236
Leonard, T.....	233	Marmora, J.....	233	Nallamothe, B.....	103, 241
Levitan, B.....	227	Marmur, J.....	169	Nallamothe, B. K.....	058
Levitan, E. B.....	188	Martin, L. M.....	014	Nambi, A.....	004
Levy, C. R.....	248	Marzec, L.....	137	Nambi, V.....	008, 195
Lewis, G. D.....	088	Masoudi, F.....	137	Namdaran, P.....	093
Li, B. H.....	061	Masoudi, F. A.....	001, 124	Nasir, K.....	002, 008, 036, 043, 102, 189, 194, 195, 254
Li, D. L.....	184	Mathews, R.....	247	Nassif, M.....	076
Li, J.....	001, 124	Matlock, D. D.....	243, 248	Nassif, M.....	055
Li, R.....	044	Matsouaka, R.....	200	Natto, Z.....	129, 130
Li, S.....	045	Matsumoto, H.....	202	Navar, A.....	086
Li, X.....	001, 124	Maurer, M.....	181	Navarro, D.....	077
Li, X.....	081	Mazzaferri Jr, E.....	236	Nazzal, C.....	025
Li, Y.....	201	McBride, C. L.....	008, 195	Nessel, C. C.....	078
Li, Y.....	171	McCann, C.....	161	Nguyen, E.....	071
Li, Z.....	116, 122	McCarthy, C. P.....	083	Nguyen, E.....	018
Liaquat, K.....	232	McCarthy, F.....	182	Nguyen, O. K.....	026, 032
Lichstein, E.....	072, 100	McCarthy, F. H.....	064	Ni, W.....	235
Likosky, D. S.....	005, 035, 141, 144	McCollam, P. L.....	089	Nichol, G.....	053
Lin, J.....	204	McDermott, K.....	182	Niklasson, J.....	123
Lin, S.....	094	McGorisk, G.....	004	Normand, S.-L.T.....	136
Lin, S.....	109	McGuire, D. K.....	013, 086, 135	Norrving, B.....	123
Lin, Z.....	136	McHorney, C. A.....	152, 154, 223	Noseworthy, P. A.....	029
Lindenauer, P. K.....	132, 133	McIvannan, C. K.....	181, 243	Noskin, G.....	077
Lindrooth, R.....	168	McMahon, C.....	084, 095, 097, 098	Noskin, G.....	077
Lip, G. Y. H.....	081	McMahon, E.....	253	Nxumalo, K.....	245
Litchman, M.....	240, 242	McNamara, M. W.....	096	Obi, E. N.....	213
Liu, C.-F.....	248	McNeely, C.....	113	O'Brien, E. C.....	057
Liu, J.....	001, 124	McPherson, J.....	214	Ochuko, P.....	004
Liu, L.....	116	Meelu, O. A.....	012	Oetgen, W. J.....	030
Liu, Y.....	235	Mefford, M.....	188	Ofili, E.....	107
Liu, Y.....	193	Mehta, A.....	066	Ojutalayo, F.....	107
Loeb, T.....	146, 238	Mehta, P. K.....	108	Okunji, P. O.....	257
Loewenstein, D.....	197	Mehta, S. N.....	013, 135	Okunrintemi, V.....	002, 189
Loh, J. W.....	035	Meltzer, L. S.....	252	Oladejo, A.....	109
Lokhnygina, Y.....	086	Mena-Hurtado, C.....	056	Oley, L.....	037
Long, J. W.....	018	Menon, V.....	074	Olin, J. W.....	099
Loosli, J.....	161	Mercado, C.....	221	Oluwole, A. M.....	100
Lotfi, A. S.....	132, 133	MercadoRodriguez, E.....	240	Omar, B.....	106, 119
Loughran, D.....	240	Michigan Society of Thoracic and Cardiovascular Su, r.....	035, 144	Omar, M.....	119
Loulatot, F.....	158	Michos, E. D.....	008, 195	on behalf of the TECOS Study Group.....	086
Lowery, C.....	226	Mikesell, S.....	153	O'Neill, K.....	023, 218
Lu, C.....	051	Millard, H. R.....	115	Onteddu, S.....	226
Lu, Y.....	001, 124	Miller, A.....	023	Onwuanyi, A.....	112, 115
Lubitz, S. A.....	029	Miller, D.....	213	Onyekusi, N.....	072, 100
Lundquist, C.....	129, 130, 239	Miller, V.....	247	Onyekwelu, C.....	184
Luo, X.....	081	Minissian, M. B.....	108	Orhurhu, V.....	065
Lurie, F.....	150	Mizutani, K.....	011	Osondu, C. U.....	102, 254
Lutz, J.....	129, 130	Mohsen, A.....	256	Overton, A.....	246
Mace, P. D.....	099	Mohta, N.....	037	Owan, T.....	172
Maclellan-Tobert, S. G.....	148	Mokadam, N. A.....	048, 212	Owlia, M.....	125
Maddox, T.....	211	Mollerus, M.....	166	Ozguler, A.....	146, 238
Maddox, T. M.....	013, 030, 135, 248	Moloci, N. M.....	058	Pack, Q. R.....	132, 133
Magnan, E. M.....	185	Monane, M.....	070, 214	Page, G. G.....	062
Magorien, R.....	236	Monda, K.....	007	Pagidipati, N. J.....	086
Mahaffey, K.....	078	Monda, K. L.....	188	Paladugu, K.....	109
Mahaffey, K. W.....	057, 127	Montgomery, D.....	095, 097, 098	Paluga, E.....	241
Mahmood, K.....	065	Morawski, K.....	037	Pan, X.....	081
Mahowald, M.....	092, 251	Morgan, S.....	098	Pan, Y.....	116
Mahr, C. W.....	048, 212	Morris, D.....	004	Pancholy, S.....	240, 242
Maihemuti, A.....	115	Morris, M.....	243	Pannell, S.....	050
Majeed, M. U.....	016	Morris, P. B.....	008, 195	Paone, G.....	035, 144
Majersik, J. J.....	161	Morshedzadeh, J.....	172	Parekh, J.....	120
Majmudar, M. D.....	049	Mukherjee, D.....	169	Parikh, P.....	233
Makam, A. N.....	026, 032	Mullangi, S.....	241	Parikh, P. B.....	138, 139
Malecky, A.....	225	Mullvain, R.....	153, 166	Parizo, J.....	094
Malozzi, C.....	119	Muntner, P.....	007, 188	Park, H.....	040
Man, S.....	054	Murakami, T.....	011	Park, K.....	164
Mancarella, G.....	181	Murata, A.....	104	Patel, A.....	204
Mani, A.....	233	Murata, G.....	104	Patel, A.....	114, 250

Author Index (continued)

Patel, J. M.	080	Ren, J.	044	Sharma, A.	169
Patel, K.	091, 111	Repack, A.	099	Sharma, A.	063
Patel, K. K.	003, 079, 192	Reyes, L.	157	Sharma, P.	229
Patel, K.	170	Reynen, D. J.	101	Sharma, P. P.	067, 068
Patel, M.	078	Reynolds, E.	103	Sharma, S.	169
Patel, V.	179	Reynolds, K.	061	Sharp, D.	070
Patten, C.	020	Rich, K.	150	Shaw, L.	004
Patterson, O.	125	Robbins, M. A.	016	Shaw, L. J.	043
Paulus, J.	129, 130	Robbs, R.	113	Sheehan, J. J.	135
Paulus, J. K.	239	Roberto, E.	114, 250	Sheehan, T.	069
Pederzoli, A.	236	Rodriguez, F.	078	Sheikh, N.	223
Pemu, P.	107	Roger, V.	020	Shen, H.	134
Pepine, C. J.	108	Romero, T.	025, 209	Sherazi, S.	087
Perez, F. J.	021	Rosenson, R. S.	007, 188	Shi, L.	009
Pericone, C.	204	Ross, J.	136	Shi, R.	051, 235
Petersen, J. W.	108	Ross, J. S.	041	Shibata, T.	011
Petersen, L. A.	060	Rostomian, A. H.	090	Shin, E. Y.	004
Peterson, E.	010, 015, 154	Rowe, A.	232	Shirai, S.	011
Peterson, E. D.	053, 057, 086, 089, 127, 223, 247	Rubenfire, M.	084, 095, 098	Shirakawa, T.	202
Peterson, L. A.	008, 195	Russell, S. D.	062	Shokr, M.	065
Peterson, P. N.	168	Russell, Z.	216, 221	Shrader, P.	127, 247
Petrillo, P.	178	Ryan, A. M.	058	Shroyer, A.	138, 139
Pham, A.	143	Ryan, D. S.	061	Shufelt, C. L.	108
Picard, M.	047, 110, 163	Rykowski, S.	030	Shuster, J.	164
Piccini, J. P.	057, 078, 127	Rymer, J.	010	Siadimas, A.	229
Pieper, J.	140	Saeed, I.	063	Siegel, C. R.	038
Pieper, K.	057	Sahay, A.	094	Siegel, L.	038
Pieper, K. S.	086	Saint Croix, G.	145	Silverstein, A. R.	213
Pike, W.	245	Salami, J.	002, 189	Sims, M.	020
Pinsker, E. C.	101	Salami, J. A.	254	Singer, D. E.	057, 078, 127
Pleyer, C.	142	Samani, S.	104	Singh, A.	036, 046, 194
Plutzky, J.	036	Sanchez, D.	090	Singh, J. P.	014, 088
Pokharel, Y.	003, 060, 067, 068, 075	Sandhu, A. T.	131	Singh, M.	142
Polk, D.	036	Sandhu, A.	211	Sinha, S. S.	058
Pollock, J.	114, 250	Sandhu, R. K.	157	Sink, E.	170
Pomerantsev, E.	083	Sandoval Huenchual, D.	025	Skali, H.	036
Poole, J.	053	Sangaralingham, L. R.	019	Sledge, T.	172
Porras, K.	050	Sangaralingham, S. J.	019	Slusser, J.	020
Potluri, A.	173	Santiago-Dieppa, D. R.	050	Smeltz, A.	165
Poulakos, M. N.	178	Saour, B.	052	Smith, A. L.	148
Powell, A. C.	018	Sapir, T.	085	Smith, E.	074
Prabhakaran, D.	173	Sartori, S.	012	Smith, E. E.	200
Prabhakaran, S.	173	Sather, J.	153, 219	Smith, G. L.	018
Prabhakaran, S.	218	Saunders, R.	174	Smith, M. A.	185
Prager, R. L.	005, 035, 144	Sauve, M.	157	Smolderen, K.	056, 075, 105
Price, S. E.	018	Saver, J.	200	Smolderen, K. G.	111
Priya, A.	132, 133	Savino, D.	182	Soliman, O.	046
Przybysz, R.	229	Sayre, G. G.	059	Song, X.	220
Puroll, E.	253	Scanlon, D.	213	Sorensen, T.	172
Pusateri, D.	034	Scharnott, M.	023, 153	Soverow, J.	090
Qamar, A.	036, 046, 194	Schein, J.	150, 227	Spatz, E.	002, 056, 189
Qanitha, A.	198	Schein, J.	015, 154, 159	Spatz, E. S.	254
Qian, L. X.	061	Schein, J. R.	223	Sperling, L.	004
Qian, Y.	022	Schmalfuss, C.	017	Sperling, L. S.	013, 135
Qintar, M.	067, 068, 079, 091	Schmitz, K.	214	Spertus, J.	056, 067, 068, 075, 091, 111
Qui, F.	179	Schold, J. D.	054	Spertus, J. A.	001, 003, 076, 079, 105, 124, 192
Raj, S. R.	157	Schopfer, D. W.	134	Spertus, J.	055, 222
Raman, G.	130	Schuhmacher, C.	232	Spragan, D.	182
Ramkumar, N.	196	Schwamm, L. H.	200	Spring, D.	240
Ramm, C.	165	Schwartz, B.	255	Sproul, K.	232
Ramsey, D. J.	008, 060, 195	Scott, B.	197	Spyropoulos, J.	210, 228
Rana, J. S.	254	Scott, C.	020	Srivastava, P.	138, 139
Rane, P.	022	Scott, R. D.	061	Stack, C. M.	176
Rao, S. K.	117	Sedlis, S. P.	125	Stafford, J.	010
Rao, Z.	122	Sednew, R.	246	Stahlbaum, K.	096
Rashid, U.	142	Sednew, R. M.	218	Steckman, D.	255
Rastogi, M.	039	Sergeev, A. V.	208	Stefan, M. S.	132, 133
Rau, E.	255	Sevilla-Cazes, J.	259, 260	Stefanescu Schmidt, A. C.	082
Reading, S. R.	061	Seweryn, S. M.	101	Steinberg, J.	050
Reddy, S.	240	Shafirin, J.	213	Steiner, J. M.	191
Redmond, N.	020	Shah, N. D.	019	Steinhaus, D. A.	029
Reeves, M. J.	200	Shah, R.	125	Stemkowski, S.	201
Reiffel, J. A.	057	Shah, R. U.	172	Stephan, K.	072
Reilly, C.	224	Shah, R.	036, 194	Stewart, P.	211
Reilly, J. B.	173	Shah, V.	096		
		Shantharam, S.	216		

Author Index (continued)

Stojan, J.....	241	Vavalle, J. P.....	177	Wu, X.....	005, 141
Stone, G. W.....	041	Velarde, G. P.....	087	Wymer, D. C.....	017
Stouffer, G. A.....	177	Veledar, E.....	102, 240, 242, 254	Wynant, W.....	152, 154
Strandberg, T. E.....	086	Vennum, K.....	175	Wynia, M.....	137
Strassle, P.....	165	Vernalis, M.....	206	Xian, Y.....	200
Strassle, P. D.....	177	Vigen, R.....	126	Xiao, E.....	155, 258
Streiff, M. B.....	259	Villines, T.....	206	Xiao, Y.....	223, 227
Strobel, R. J.....	144	Virani, S.....	002, 189	Xie, J.....	171
Strom, J. B.....	167, 183, 186	Virani, S. S.....	008, 030, 060, 195, 254	Xie, J. X.....	043
Stys, T.....	143, 153	Vivekanandan, R.....	120	Xin, Y.....	156
Suckow, B. D.....	196	Wade, S.....	022	Xu, H.....	200
Sud, M.....	179	Waldman Casebeer, A.....	201	Xu, J.....	235
Sullivan, M. J.....	149	Wali, A. R.....	050	Yamada, T.....	249
Summers, D.....	222	Walizer, E.....	206	Yamamoto, M.....	011
Sumner, G. L.....	157	Walters, R. W.....	120	Yamanaka, F.....	011
Sundt, T.....	163	Wang, C.....	116	Yanagimoto, S.....	249
Sunjic, I.....	199	Wang, C.....	116	Yancy, C.....	077
Sunstein, C.....	082	Wang, G.....	158	Yang, C.-W.....	240
Suter, L.....	136	Wang, J.....	097	Yang, J. P.....	176
Swan, K.....	099	Wang, J.....	126	Yang, M.....	044
Swetz, K. M.....	181	Wang, T. Y.....	010, 089, 247	Yang, X.....	044, 116
Szeto, W.....	182	Wang, X.....	044	Yee, J.....	143
Szeto, W. Y.....	064	Wang, Y.....	116, 122	Yeh, R. W.....	167, 186
Taasan, S.....	164	Wang, Y.....	001, 124, 136	Yilong, W.....	156
Tabata, M.....	011	Wang, Y.....	116, 122	Yongjun, W.....	156
Tada, N.....	011	Wang, Y.....	186	Yoon, L.....	213
Taduru, S.....	063	Warraich, H.....	002, 189	Yoshiyama, M.....	011
Takagi, K.....	011	Warren, C. E.....	031	Youmans, Q.....	077
Tang, F.....	013, 135	Wasfy, J.....	047, 110, 163, 211	Yu, W.....	051, 235
Tang, Y.....	003, 067, 068, 076, 192	Wasfy, J. H.....	014, 083, 088, 117, 186	Yu, W.....	235
Tanguturi, V.....	047	Washam, J. W.....	247	Yuan, Z.....	015
Tanguturi, V. K.....	110	Watanabe, Y.....	011	Zahuranec, D. B.....	035, 144
Tapia, M.....	052	Waters, T. M.....	027, 028	Zajarias, A.....	113
Tavella, R.....	244	Webb, L.....	247	Zarich, S.....	105
Taylor, B.....	007	Weeda, E. R.....	071	Zeitz, C.....	244
Teeter, E.....	165	Wei, J.....	108	Zeng, X.....	171
Telila, T.....	065	Wei, J.....	030	Zeng, X.....	171
Theodoropoulos, K.....	012	Weilburg, J.....	047	Zern, E. K.....	049
Thomas, K.....	246	Weinstein, E. M.....	184	Zhang, D.....	009, 045
Thomas, K. L.....	053	Weinstein, J.....	073	Zhang, H.....	001, 124
Thomas, L.....	010, 127	Weintraub, W.....	217	Zhang, J.....	164
Thompson, J. S.....	243	Weir, M. R.....	159	Zhang, L.....	190
Thompson, M. P.....	027, 028	Welch, T. D.....	149	Zhang, L.....	064
Thompson, R. W.....	014, 088	Wells, B. J.....	099	Zhang, M.....	005, 035, 141, 144
Thomson, L. E. J.....	108	Wells, P. S.....	227	Zhang, R.....	258
Thorson, S.....	219	Wells, R.....	181	Zhang, S.....	026, 032
Ting, H. H.....	189	Welsh, J.....	001, 124	Zhang, X.....	116
Ting, W.....	150	Welsh, J. W.....	041	Zhang, X.....	216
Tkach, A.....	161	Welter, C. R.....	101	Zhao, D. X.....	016
Torosoff, M.....	052, 140, 155, 190, 255, 258	Wessler, B.....	239	Zhao, H.....	007
Townsend, K.....	253	Wessler, B. S.....	129, 130	Zhao, X.....	116
Tran, T.....	180	Whelan, J. B.....	183	Zheng, S.....	183
Trenkamp, R. H.....	021	Whooley, M. A.....	059, 134	Zheng, X.....	001, 124
Triki, N.....	073	Whyte, S.....	048, 212	Zhuo, Z.....	235
Troyer, J.....	161	Wight, C. E.....	178	Zixiao, L.....	156
Trupp, R. J.....	210	Wijeyesundera, H. C.....	179		
Tschiltz, N.....	206	Wilbert, L.....	232		
Tuohy, E. R.....	105	Wilbert, L. A.....	233		
Turner, E.....	206	Willey Temkin, C.....	160		
Uchino, K.....	054	Williams, M. L.....	064		
Ueno, H.....	011	Willson, T.....	220		
Uiterwaal, C. S.....	198	Wilson-Peace, E.....	230		
Ungar, L.....	078	Wilson-Pease, E.....	147		
Urja, P.....	120	Winchester, D. E.....	017, 164		
Ursat, C.....	146	Wingrove, J.....	214		
Ursat, C.....	238	Winslow, F.....	038		
Valadri, R.....	240, 242	Witcik, M. A.....	148		
Valero-Elizondo, J.....	102, 254	Wold, J.....	161		
Valko, M.....	150	Wolf, L.....	072		
Valle, J.....	211	Wong, N. D.....	013, 135		
van der Graaf, Y.....	198	Wood, D.....	179		
Van Houten, H. K.....	019	Woods, G.....	023		
Van Nuys, K.....	213	Woodward, M.....	188		
Vassileva, C.....	113	Worden, N.....	256		
Vavalle, J.....	165	Wordingham, S. E.....	181		
		Worthley, M.....	244		